

G-8986

68267

# T. 39 S., R. 20 E., W.M.

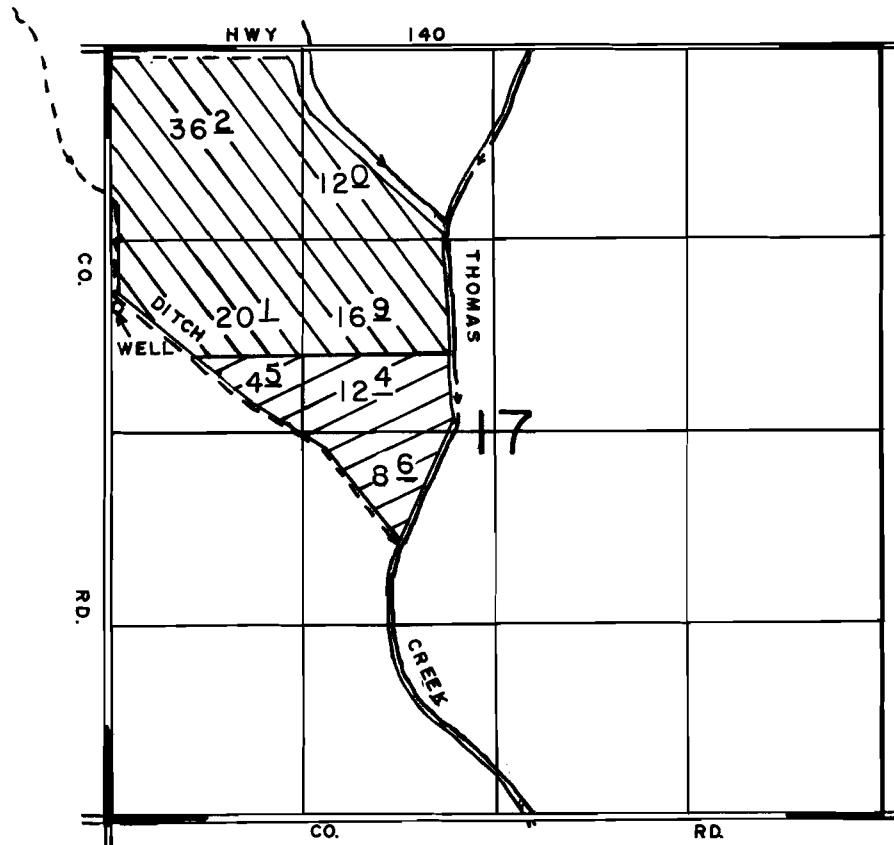

WELL LOC: 1760' S. & 75' E. FROM NW COR. OF SEC 17.

SCALE 1" = 1320'

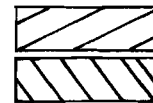

PRIMARY  
SUPPLEMENTAL

## FINAL PROOF SURVEY

UNDER

Application No. G-9717 Permit No. G-8986  
IN NAME OF

FAVELL-UTLEY CORPORATION

Surveyed APRIL 30, 1992, by B.W BISHOP