



# T. 23S. . R. 12W. . W. M. SECTION 25

**LEGEND**

- POD  POINT OF DIVERSION
-  HOME INCL. 1/2 AC. IRR.
- · — · — PROP. LINE
- · — · — WATERLINE

PREPARED BY:  
STUNTZNER ENG. & FOR.  
P.O. BOX 118/705 S. 4th  
COOS BAY. OR 97420

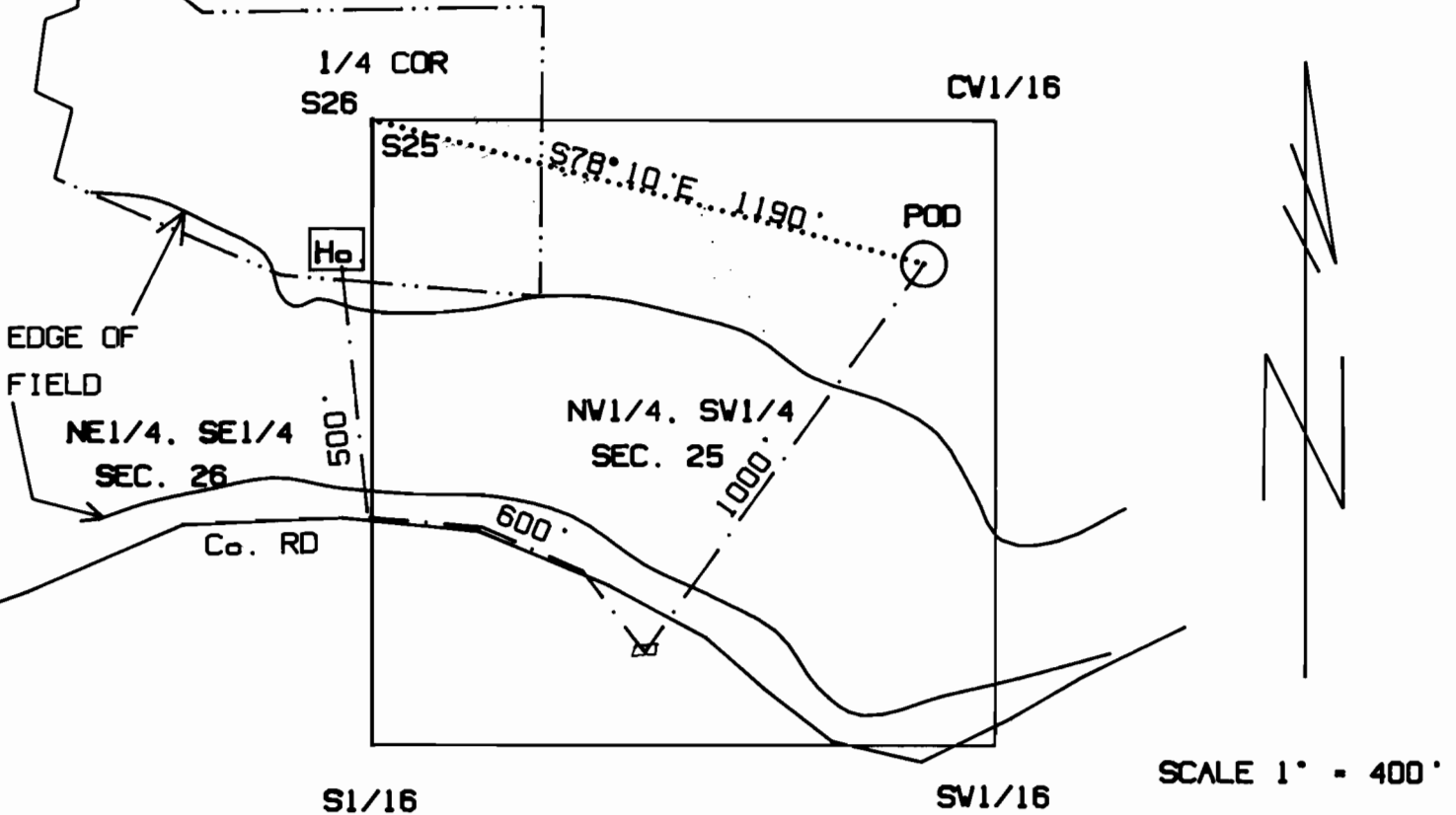

**EXAMINERS DISCLAIMER STATEMENT**

THE PREPARATION OF THIS MAP WAS FOR THE PURPOSE OF IDENTIFYING THE LOCATION OF THE WATER RIGHT AND HAS NO INTENT TO PROVIDE DIMENSIONS OR LOCATION OF OWNERSHIP LINES.

**FINAL PROOF SURVEY**

Application No. 69257... Permit No. 50255...  
IN NAME OF  
... LARRY D. AND JOHANNA D. WEST ...

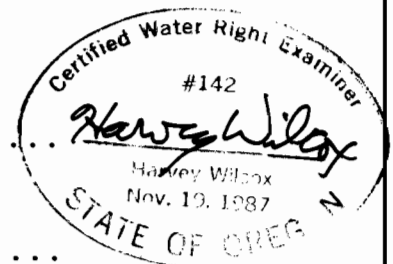

Surveyed ... JUNE 3rd ... 1992 ... by H.A. WILCOX