

P 33401  
68356  
39966

# T. 9 S. R. 27 E. W. M.

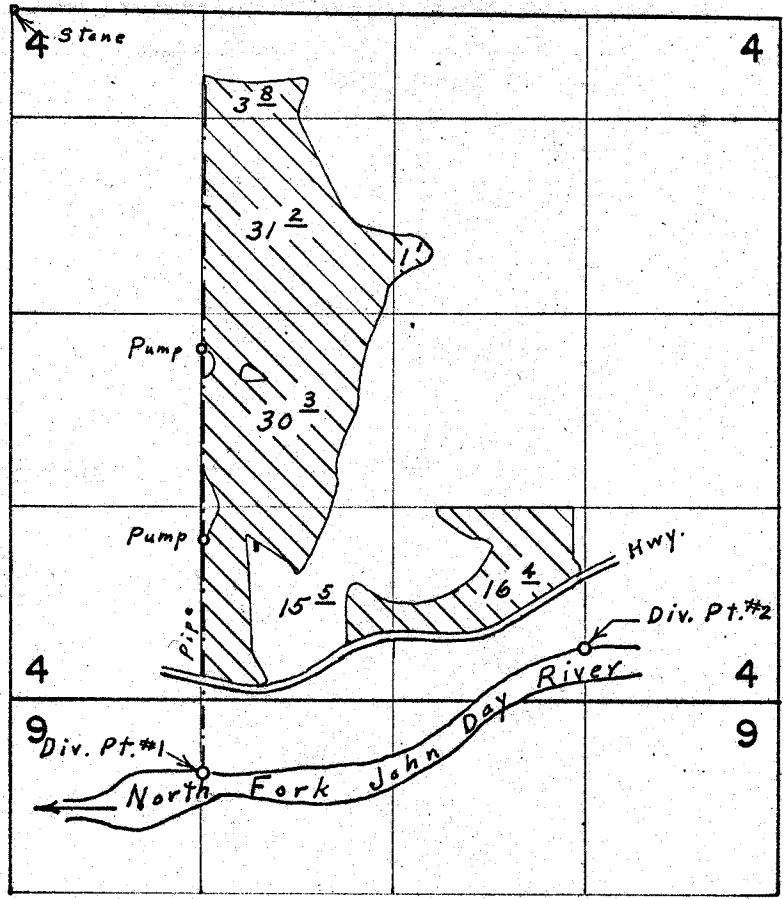

Div. Pts. located: #1, 5170' S. & 1330' E., #2, 4280' S. & 3940' E., both from N.W. Cor. Sec. 4

## FINAL PROOF SURVEY UNDER

Application No. 44650 Permit No. 33401  
IN NAME OF  
J. DONALD CAPON

Surveyed Aug. 3, 1972, by L. E. Gould