

C35744  
68375

# T.13S.R.9E.W.M.

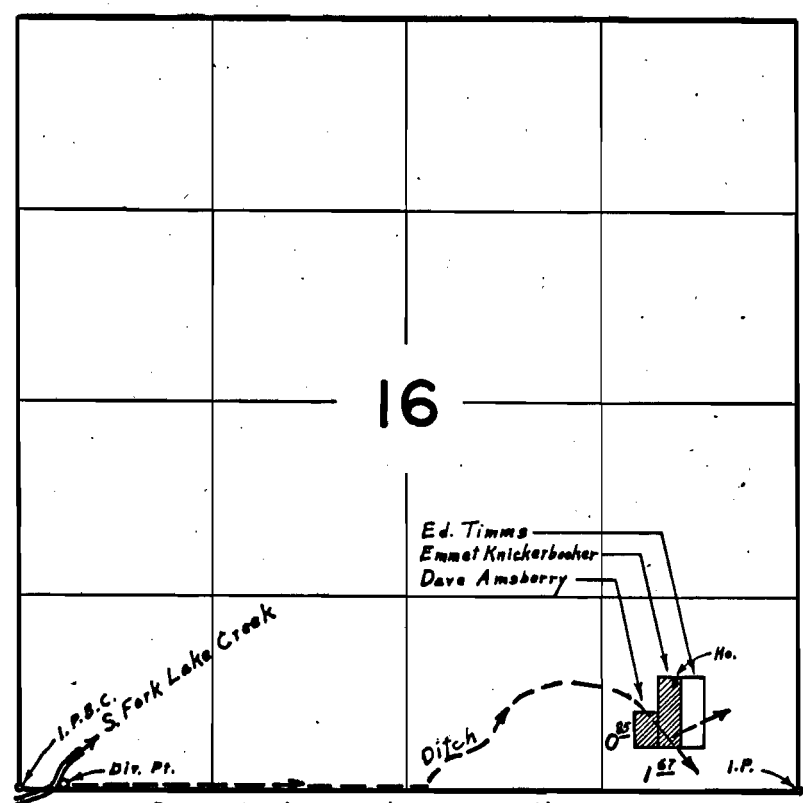

Div. Pt. located 30' N. & 300' E. from The S.W. Cor. Sec. 16

## FINAL PROOF SURVEY UNDER

Application No. 38908 Permit No. 28961  
IN NAME OF  
**DAVE AMSBERRY**

Surveyed July 11, 1967., by L.E. Gould

#28961  
1967-U