

T.12S.,R.6W.,W.M.

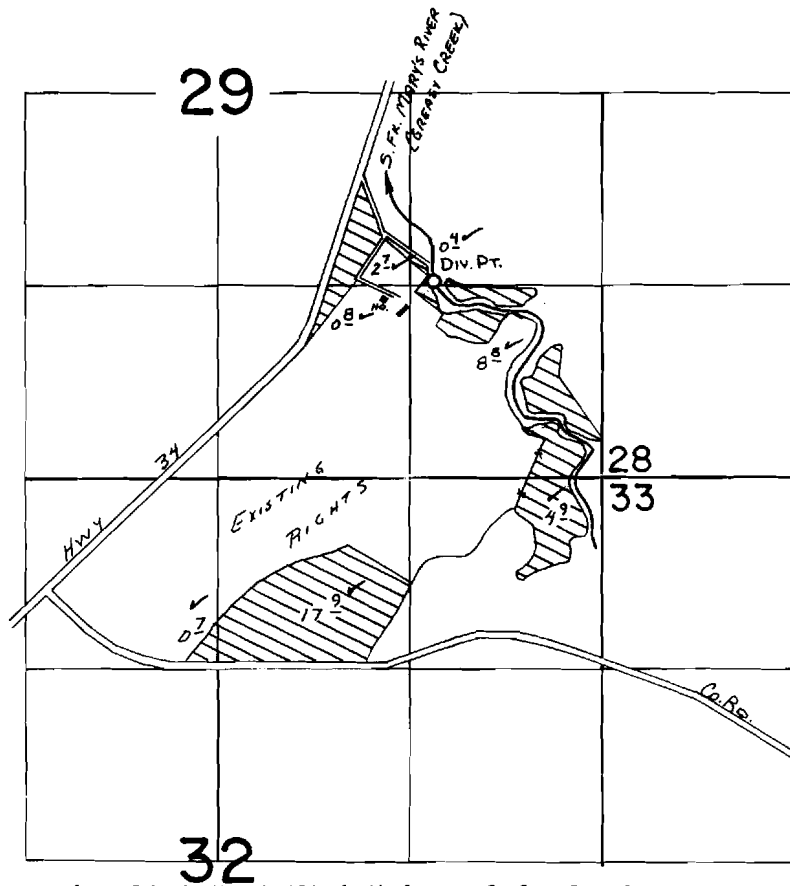

Div. Pt. - 1350 ft. N. and 1150 ft. W. from SE Cor. SEC. 29

FINAL PROOF SURVEY
UNDER

Application No. 49791 Permit No. 37459
IN NAME OF

GARY GRAY

Surveyed Sept. 7, 1982, by L. M. TOLL