

T.31S. R.15W. W.M.

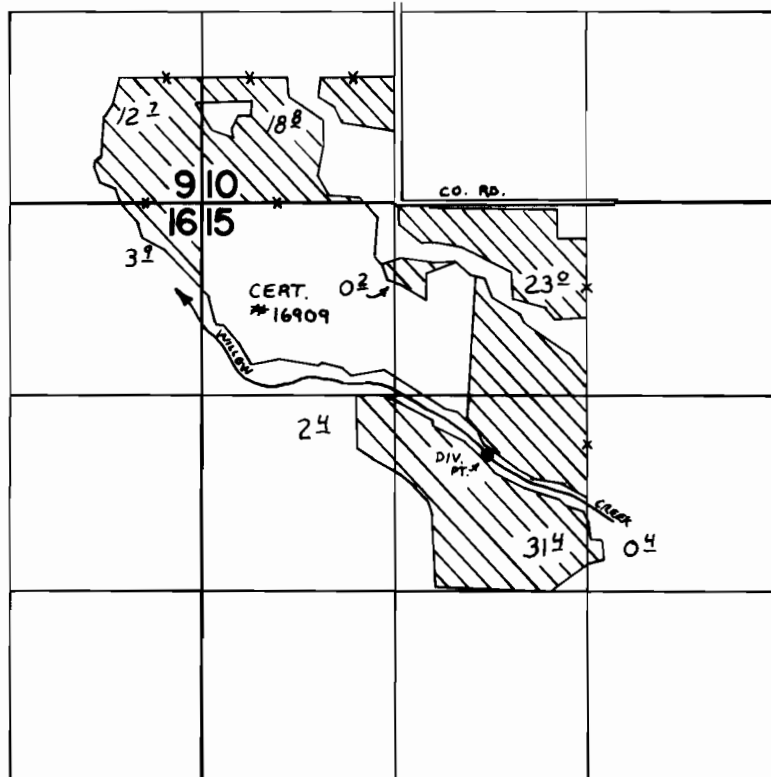

DIVERSION POINT LOCATED 1720'S & 680'W FROM THE N 1/4 COR. SECTION 15

FINAL PROOF SURVEY UNDER

Application No. 49653 Permit No. 37181
IN NAME OF
ESTATE OF
L. E. KREUTZER

Surveyed OCT. 20, 1976, by L. E. GOULD