

AREA BEING OVER
IRRIGATED = 35.6 ACRES

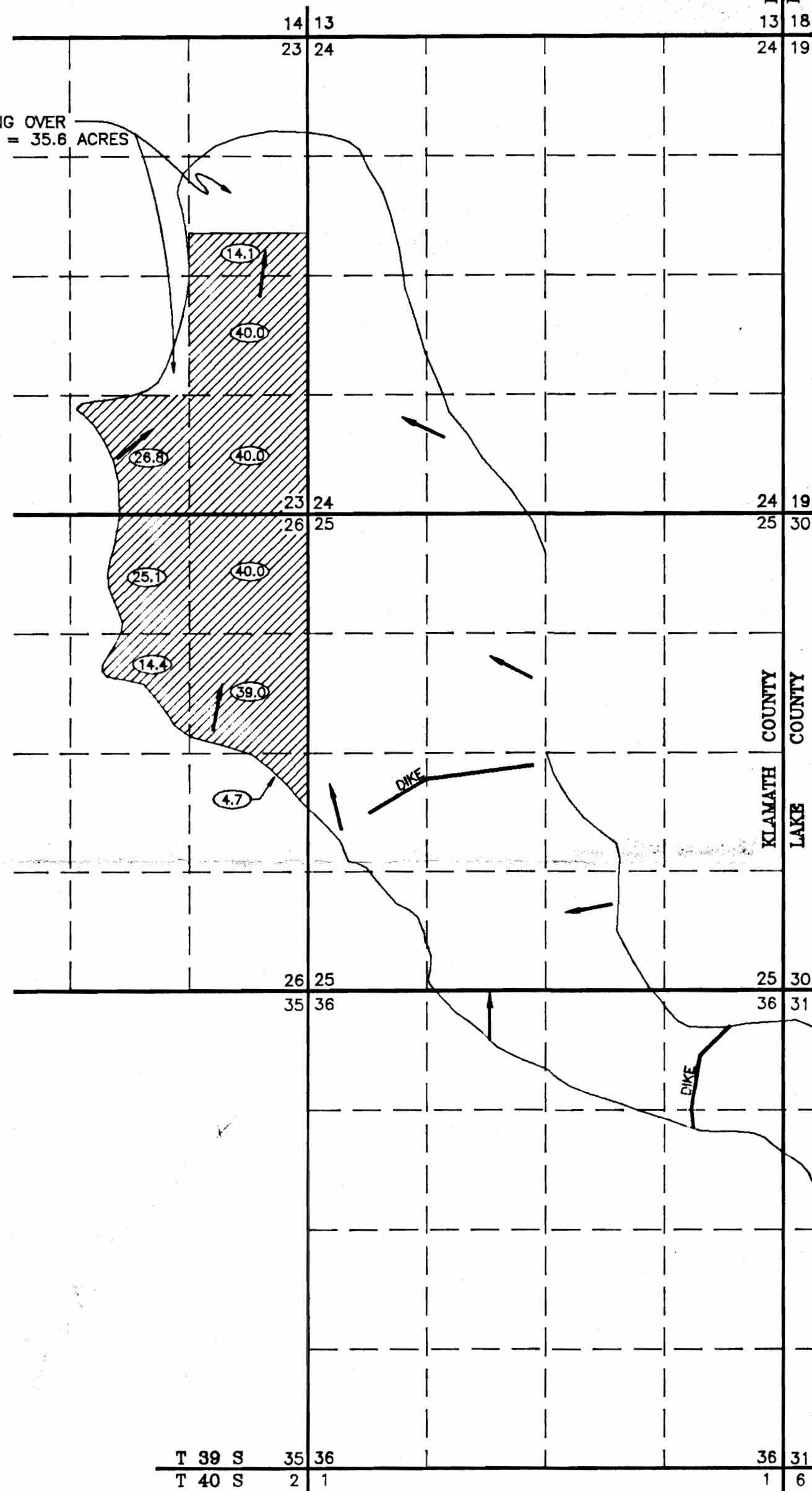

R18E

T40S

POINT OF DIVERSION INSERT

LEGEND

- SECTION LINE
- 1/4, 1/4 SECTION LINE
- POINT OF DIVERSION AS NOTED IN TABLE
- IRRIGATED AREAS UNDER APPLICATION NO. 70194, PERMIT NO. 51080.
- DIRECTION OF FLOW FOR FLOOD IRRIGATION.

POINT OF DIVERSION TABLE

- | | |
|----|---|
| #1 | LOCATED 1312' NORTH AND 1172' WEST OF THE SE COR. OF SEC. 8, T40S, R18E, W.M. |
| #2 | LOCATED 249' SOUTH AND 688' WEST OF THE NORTH 1/4 COR. SEC. 5, T40S, R16E, W.M. |

NOTE: PREPARATION OF THIS MAP IS FOR IDENTIFYING PROPOSED WATER RIGHTS ONLY. IT HAS NO INTENT TO PROVIDE LOCATIONS OR DIMENSIONS OF PROPERTY BOUNDRIES..

FINAL PROOF SURVEY

UNDER

APPLICATION NO. 70194 AND R-70193

IN THE NAME OF

WARREN TAYLOR
HC 70, BOX 2225
OREANA, IDAHO 83650

SURVEYED AUGUST 8, 1991

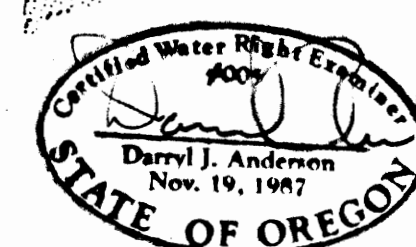

PREPARED BY:
ANDERSON ENGINEERING AND SURVEYING
618 SOUTH FIRST STREET
P.O. BOX 28
LAKEVIEW, OREGON 97630
(503) 947-4407 FAX 947-2321
AUGUST 16, 1991 SHEET 1 OF 1
REVISED: JUNE 23, 1992