

T. 1 S., R. 3 W., W. M.

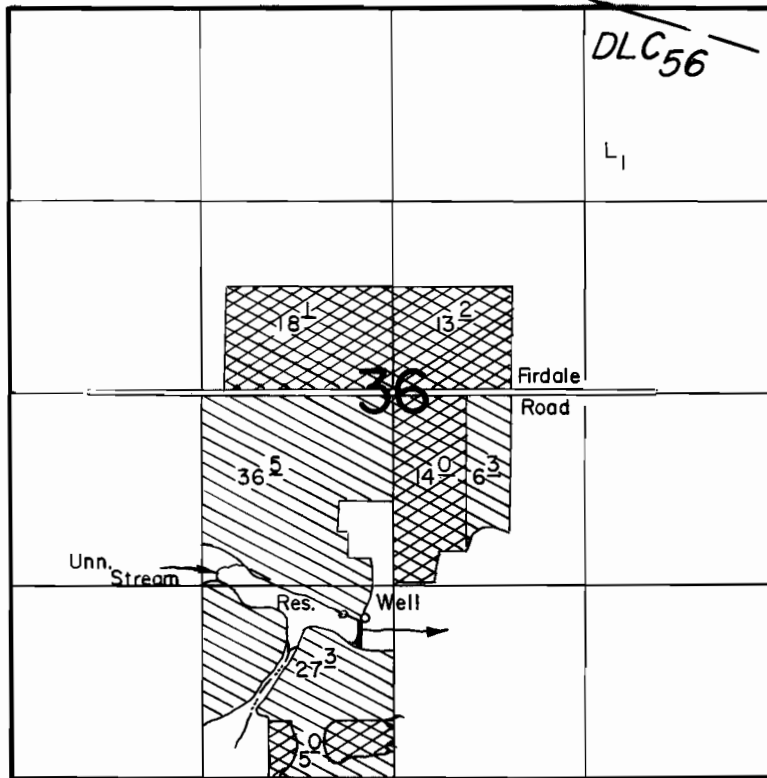

P.O.D. Loc. : 1000' N. & 240' W.
 Well Loc. : 1100' N. & 190' W., both from S. 1/4 Cor. Sec. 36.

Scale : 1" = 1320'

FINAL PROOF SURVEY

UNDER
 Transfer 5797

68724

49702

Application No. G-11523 Permit No. G-10621

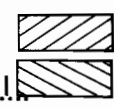

IN NAME OF

RICHARD L. & SANDRA M. TWIGG, dba TWIGG FARM

Surveyed JUNE..... 1987, by Ben Bishop.....

41067-178-137 A
 1/5/07 TMW