

T. 23 S. R. 31 E. W. M.

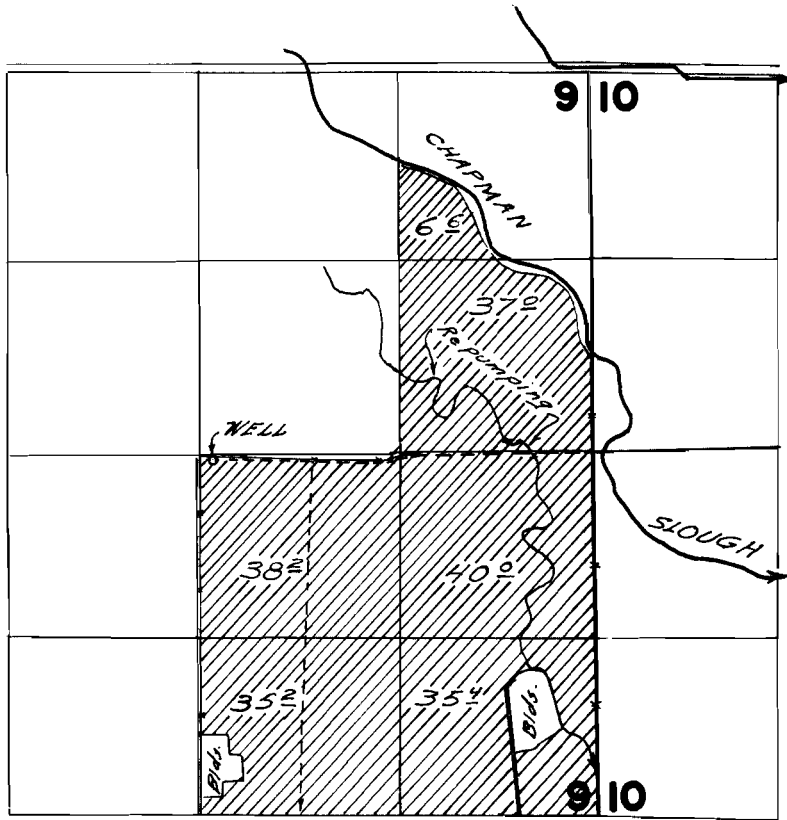

Well located 29 ft. S. & 83 ft. E from center 1/4 Cor. Sec 9

**FINAL PROOF SURVEY**  
UNDER

Application No. *G-2109* Permit No. *G-2089*  
IN NAME OF

*Hilton Whiting*

Surveyed *July 25, 1967*, by *W. J. Buppert*