

SECTION 2, T.1S., R.3W., W.M.

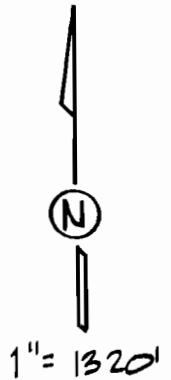
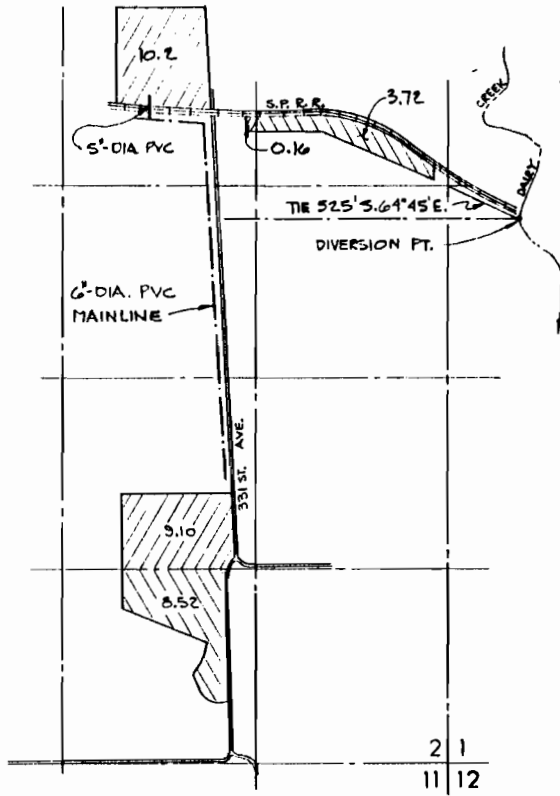

FINAL PROOF SURVEY UNDER

APPLICATION NO. 69609 PERMIT NO. 50739

SURVEYED JULY 3, 1991

PREPARATION OF THIS MAP IS FOR THE
PURPOSE OF IDENTIFYING THE LOCATION OF
THE WATER RIGHT ONLY THERE IS NO INTENTION
TO PROVIDE DIMENSIONS OR TO SHOW
PROPERTY OWNERSHIP LINES.

VERBOORT ENGINEERING
AGRICULTURE · CIVIL · WATER RESOURCES
HILLSBORO, OREGON

by date
designed WRV 7.7.91
drawn JER 7.7.91
checked WRV 7.7.91
drawing no. _____
sheet no. 1/1

EDMUND DUYCK
2020 S.W. 325 TH
HILLSBORO, OR 97123