

**T.9S., R.1W., W.M.**

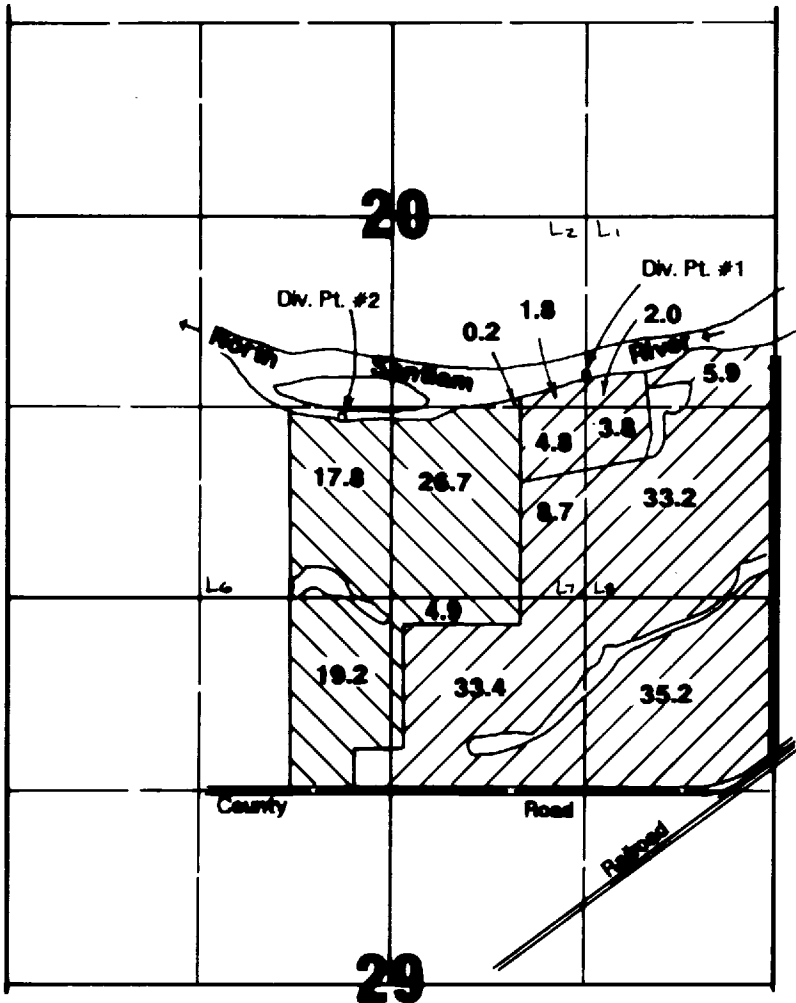

**Area Irrigated**

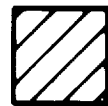

Div. Pt. #1



Div. Pt. #2

Div. Pt. #1 located 1530'N & 1320' W from SW corner Section 20.  
 Div. Pt. #2 located 1230'N & 310'W from S1/4 corner Section 20.

**Final Proof Survey**

Application #: 69751      Permit #: 50720

In Name Of

**Edward Kuzma**

Surveyed on October 19, 1989 by JM Schuette

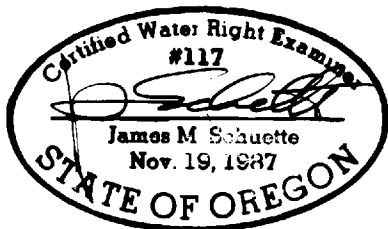

THIS MAP WAS PREPARED FOR THE PURPOSE OF  
 DESCRIBING THE LOCATION OF A WATER RIGHT  
 ONLY AND IS NOT INTENDED TO PROVIDE LEGAL  
 OPINIONS OR LOCATION OF PROPERTY  
 OWNERSHIP LINES.