

Application No. R-71804

Permit No.

cert-68787

APPLICATION MAP FOR PERMIT TO CONSTRUCT A RESERVOIR

WATER RESOURCES DEPT.
SALMON, OREGON

SE 1/4 SW 1/4 SEC 18 T 39 S R 38 E W.M.

U.S.G.S. QUAD - POLE CANYON, OR. - 7 1/2'

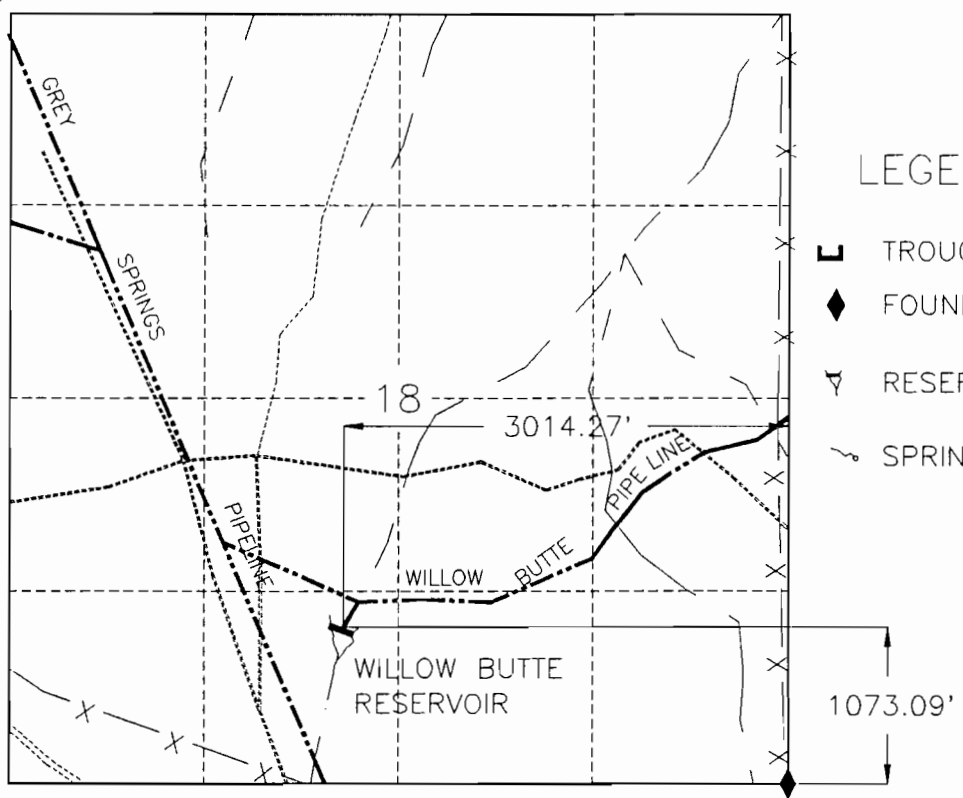
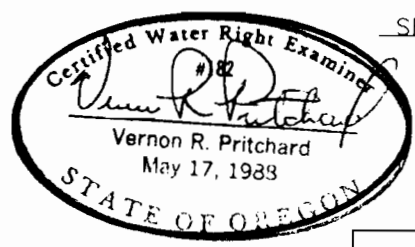

LEGEND

- ▬ TROUGH
- ◆ FOUND CORNER
- ▽ RESERVOIR
- ~ SPRING

WILLOW BUTTE RESERVOIR (5781)

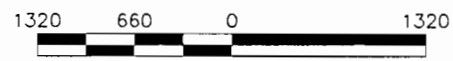

SCALE 1"=1320'

THIS MAP IS FOR THE PURPOSE OF LOCATING A WATER RIGHT AND IS NOT INTENDED TO PROVIDE LEGAL DIMENSIONS FOR LOCATION OF PROPERTY BOUNDARIES.



UNITED STATES DEPARTMENT OF THE INTERIOR
BUREAU OF LAND MANAGEMENT
DIVISION OF OPERATIONS VALE DISTRICT

WILLOW BUTTE RESERVOIR

DESIGNED: *Donald W. Gustaf*
 REVIEWED: *Vernon R. Pritchard*
 APPROVED: *George D. House*
CHIEF, BRANCH OF ENGINEERING

DRAWN: ARB	SCALE: AS SHOWN
DATE: JULY 30, 1991	SHEET 1 OF 1
DRAWING NO.	

ACAD RELEASE 10
DWG FILE:WBRESH20