

T 7 S R 38 E W.M.

RECEIVED

MAY - 8 1992

WATER RESOURCES DEPT.
SALEM, OREGON

RECEIVED

MAY 18 1992

WATER RESOURCES DEPT.
SALEM, OREGON

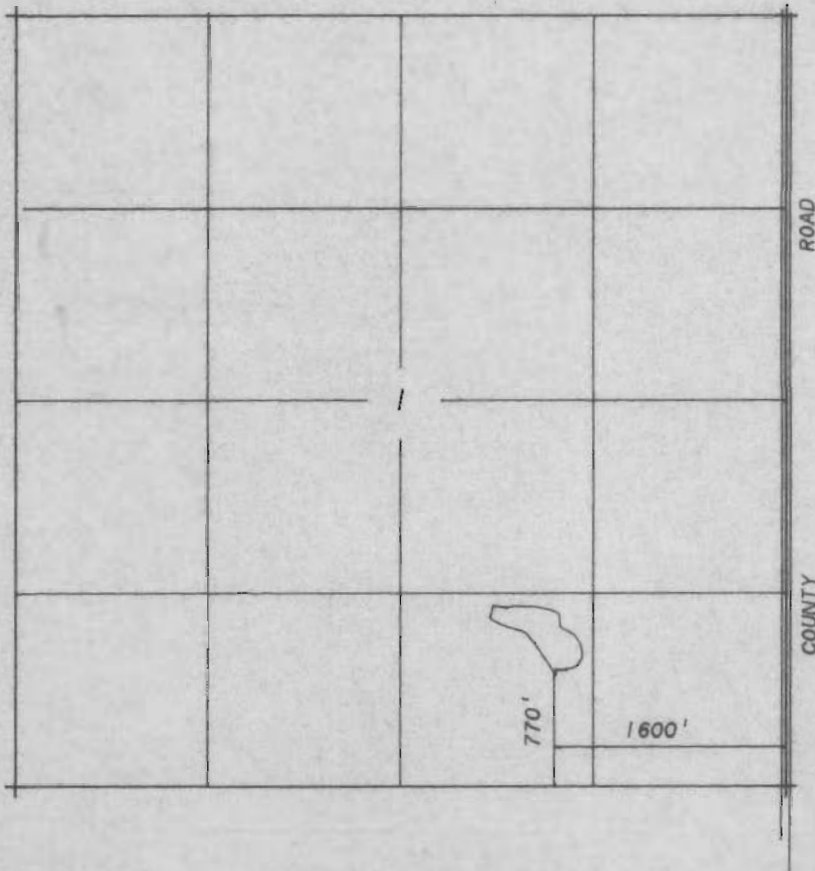

SCALE 1" = 1320'

APPLICATION MAP FOR WATER RIGHTS

FOR

THE HART ESTATE INVESTMENT
COMPANY



DATE: APRIL 22, 1992

NOTE: The preparation of this map was for the purpose of identifying the location of the proposed water right and has no intent to provide dimensions or location of property ownership lines. Location information shown hereon was furnished by the applicant.

APPLICATION NO. R-72407

PERMIT NO. _____

"CERTIFICATE NO. 68805"