

Application No. R72772

FINAL PROOF MAP

Permit No.

68858

"CERTIFICATE NO. \_\_\_\_\_"

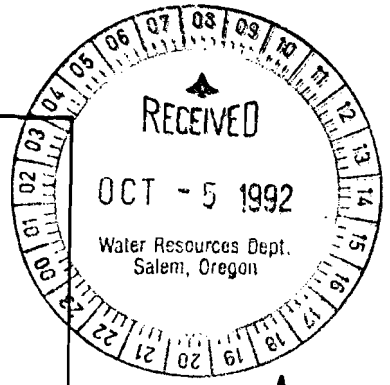
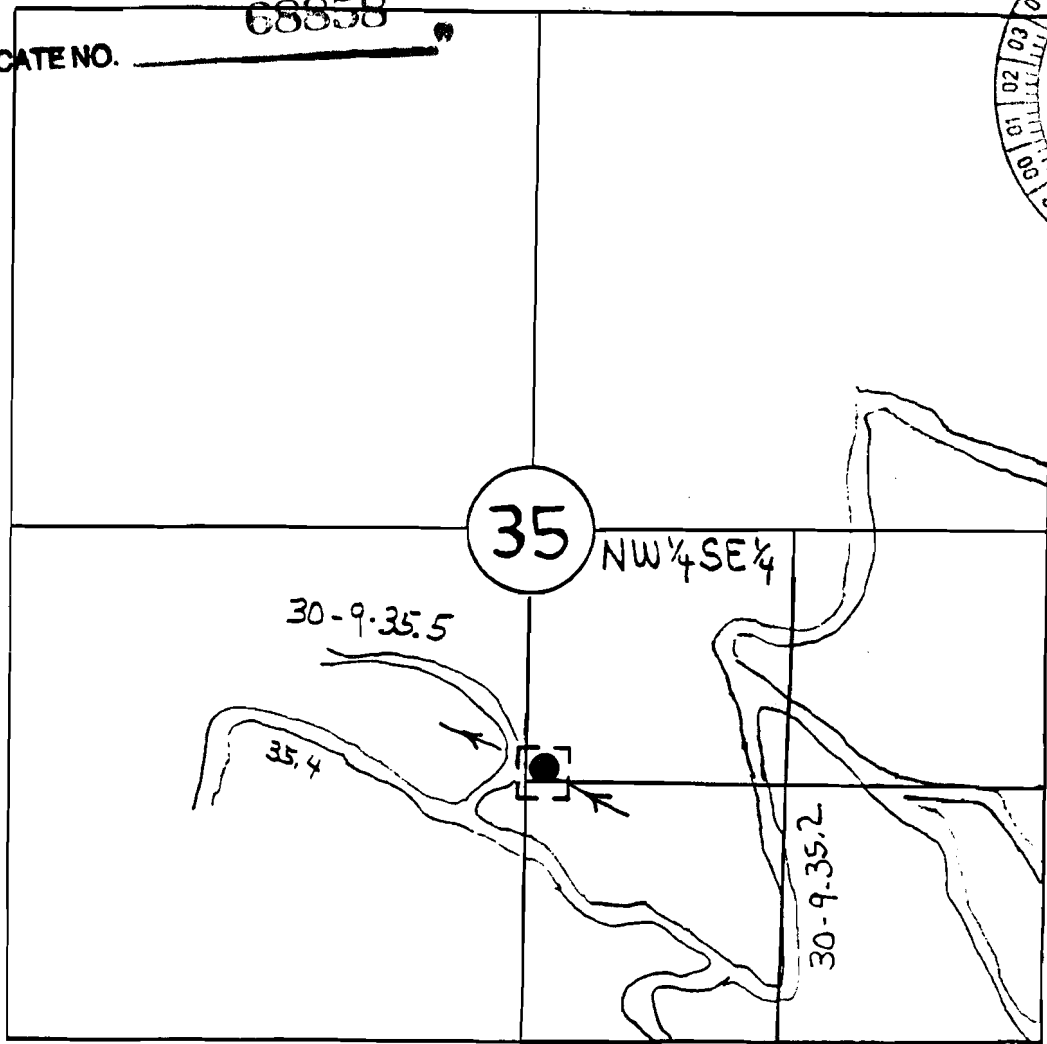

Scale 1" = 1000'

SNAKE PIT  
T30S R9W Sec 35  
NW 1/4 SE 1/4

The point of diversion is located approximately 1350 ft North and 20 ft East from the South Quarter Corner of Section 35.

Coordinate Ties are based on aerial photo 2-3-7.

The map is shown for the purpose of water application and not property boundary.

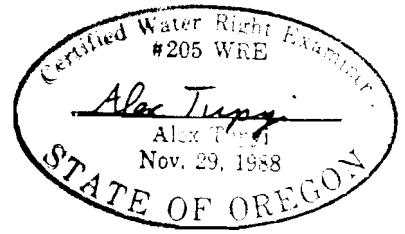

9-17-92