

R-73658

03976

RECEIVED

SEP 27 1993

WATER RESOURCES DEPT.  
SALEM, OREGON

# APPLICATION MAP FOR PERMIT TO CONSTRUCT A RESERVOIR

SE 1/4 NE 1/4 SEC 24 T 25S R 45E W.M.

U.S.G.S. QUAD-THREE FINGERS ROCK OR. - 7 1/2'

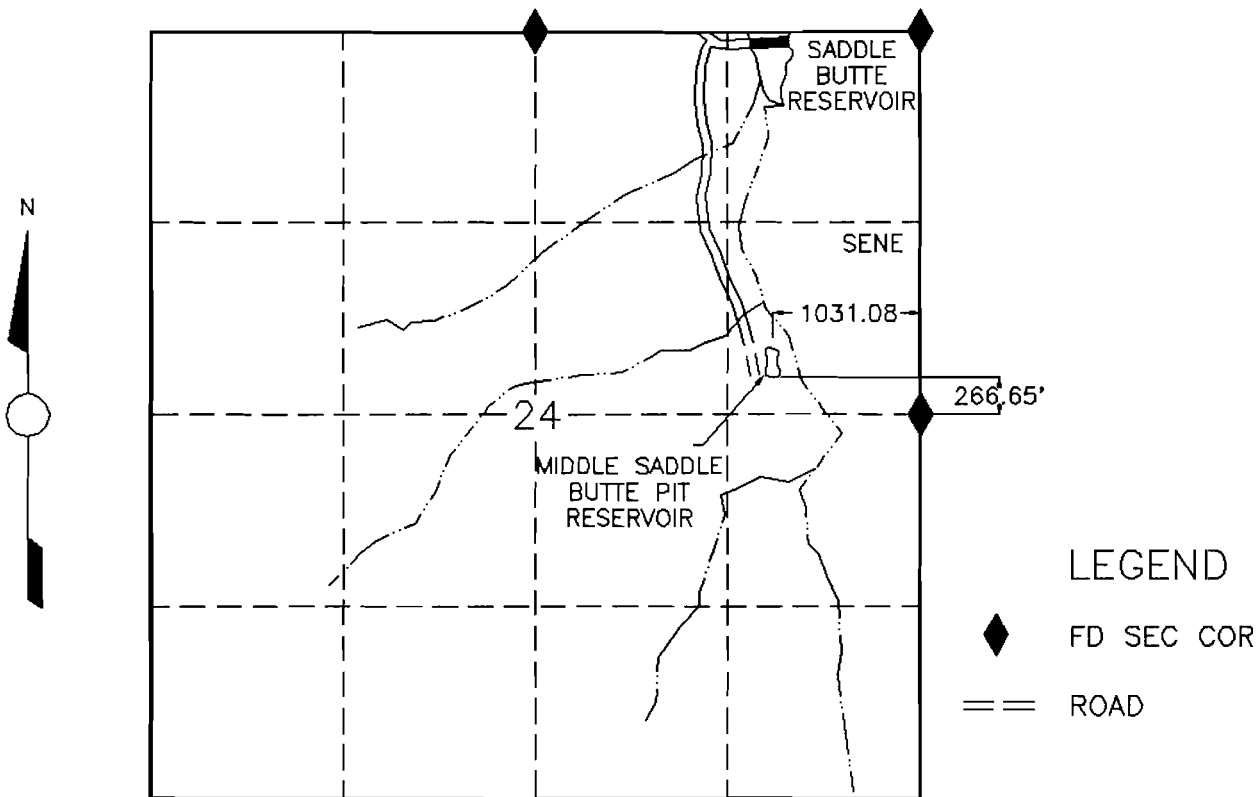

### MIDDLE SADDLE BUTTE PIT RESERVOIR (48-5678)



SCALE 1"=1320'

THIS MAP IS FOR THE PURPOSE OF LOCATING  
A WATER RIGHT AND IS NOT INTENDED TO  
PROVIDE LEGAL DIMENSIONS FOR LOCATION  
OF PROPERTY BOUNDARIES.

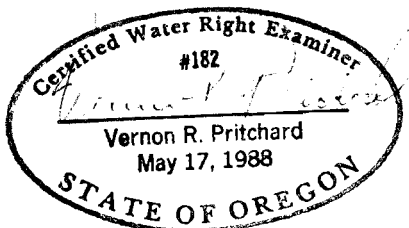

UNITED STATES DEPARTMENT OF THE INTERIOR BUREAU OF LAND MANAGEMENT DIVISION OF OPERATIONS VALE DISTRICT	
MIDDLE SADDLE BUTTE PIT (48-5678) RESERVOIR	
DESIGNED	<i>[Signature]</i>
REVIEWED	<i>[Signature]</i>
APPROVED	<i>George D. House</i> CHIEF, BRANCH OF ENGINEERING
DRAWN: ARB	SCALE: AS SHOWN
DATE: JULY 17, 1990	SHEET 1 OF 1
DRAWING NO. OR-030-9174-11	

ACAD RELEASE 10  
DWG FILE: MPITRES