

APPLICATION MAP FOR PERMIT TO CONSTRUCT A RESERVOIR

Application No. 12-73661
Permit No.

"CERTIFICATE NO. 68986"

RECEIVED
SEP 30 1993
WATER RESOURCES DEPT.
SALEM, OREGON

OVERTOP (48-5206) RESERVOIR
SE1/4 SW 1/4, SEC. 27, T. 21S., R. 38E., W.M.
U.S.G.S. QUAD - JUNTURA, OREG. - 7 1/2'

CRUMENT (48-5454) RESERVOIR
NW1/4 NE1/4, SEC. 34, T. 21S., R. 38E., W.M.
U.S.G.S. QUAD - JUNTURA, OREG. - 7 1/2'

BULL CANYON HEADWATER (48-5908) RESERVOIR
SE1/4 NE1/4, SEC. 34, T. 21S., R. 38E., W.M.
U.S.G.S. QUAD - JUNTURA, OREG. - 7 1/2'

ANTELOPE SPRING (48-0418) RESERVOIR
NW1/4 NW1/4, SEC. 33, T. 21S., R. 38E., W.M.
U.S.C.S. QUAD - JUNTURA, OREG. - 7 1/2'

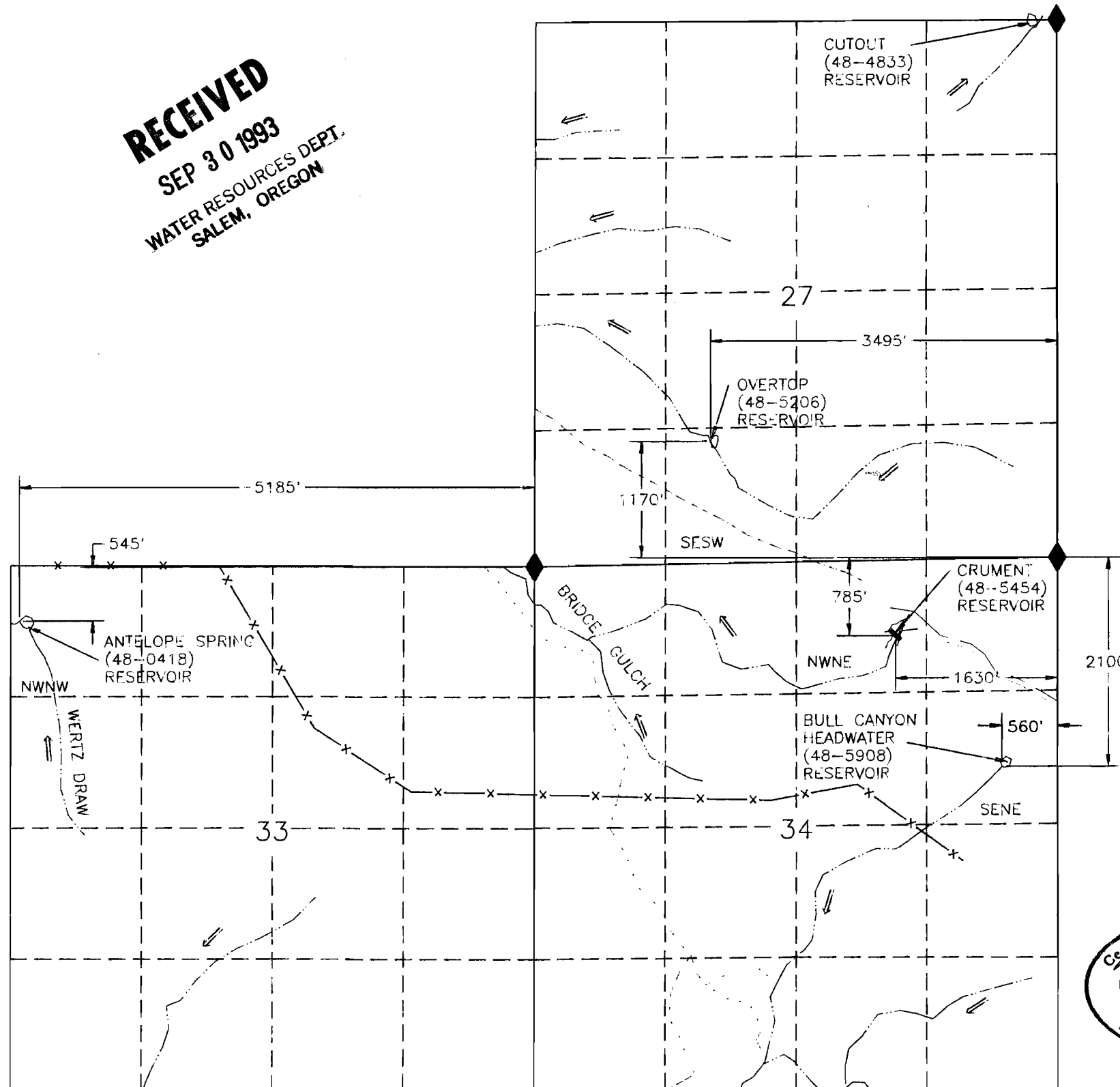

LEGEND

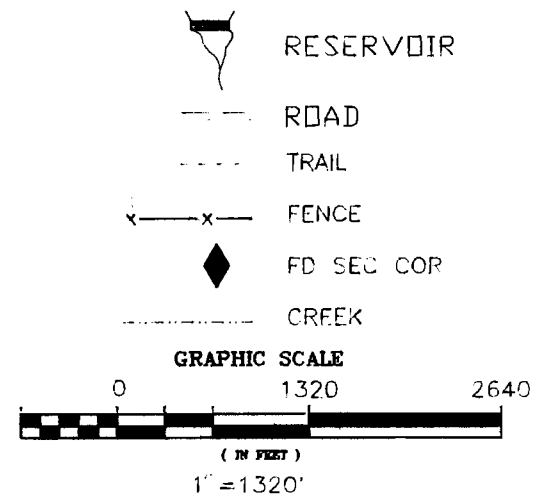

Certified Water Right Examiner
#182
Vernon R. Pritchard
Vernon R. Pritchard
May 17, 1983
STATE OF OREGON



UNITED STATES DEPARTMENT OF THE INTERIOR
BUREAU OF LAND MANAGEMENT
DIVISION OF OPERATIONS VALE DISTRICT

RESERVOIRS LOCATED IN
SEC. 27, 33 & 34, T. 21S., R. 38E., W.M.

DESIGNED: _____
REVIEWED: *Vernon R. Pritchard*
APPROVED: *George House*
CHIEF, BRANCH OF ENGINEERING

DRAWN: _____ SCALE: _____

DATE: 8/20/83 SHEET 1 OF 1

DRAWING NO. 12-73661-1

ACAD RELEASE 11
DWG FILE: CRUMEN.DWG