

Application No. R-73684  
 Certificate No. 0002  
 T. 41 S., R. 2 E., W.M.

IRON PIPE AND  
 BRASS CAP

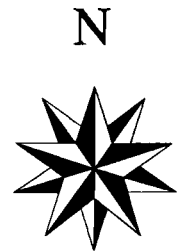
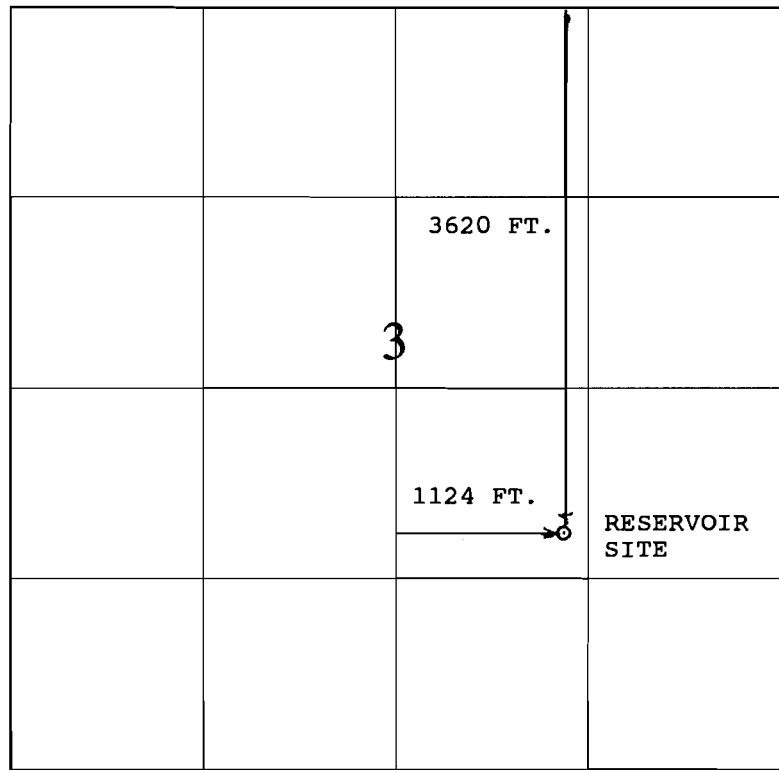

1 IN. = 1320 FT.

APPLICATION MAP

FOR

WEST PILOT POCK #1

IN NAME OF

UNITED STATES BUREAU OF LAND MANAGEMENT

MAY 26, 1993

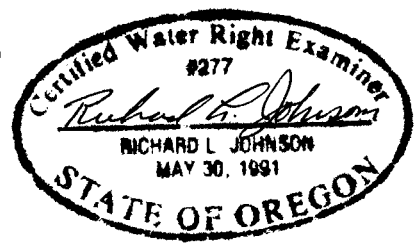

**RECEIVED**

OCT 01 1993

WATER RESOURCES DEPT.  
 SALEM, OREGON

THE PURPOSE OF THIS MAP IS FOR IDENTIFYING THE LOCATION OF THE WATER RIGHT ONLY AND IS NOT INTENDED TO PROVIDE LEGAL DIMENSIONS OR LOCATION OF PROPERTY OWNERSHIP LINES.

WRE 6056A OREGON

U.S. BUREAU OF LAND MANAGEMENT - OSO  
 BRANCH OF CADASTRAL SURVEY

EXECUTED BY:  
 RICHARD L. JOHNSON, PLS, CWRE

LETTER OF AUTHORIZATION  
 DATED: MAY 3, 1993

OR-942.1  
 P.O. BOX 2965  
 PORTLAND OR., 97208

No. R-73684

CERTIFICATE NO. 00002

T. 41 S., R. 2 E., W.M.

IRON PIPE AND  
BRASS CAP

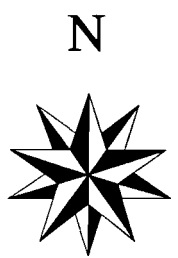
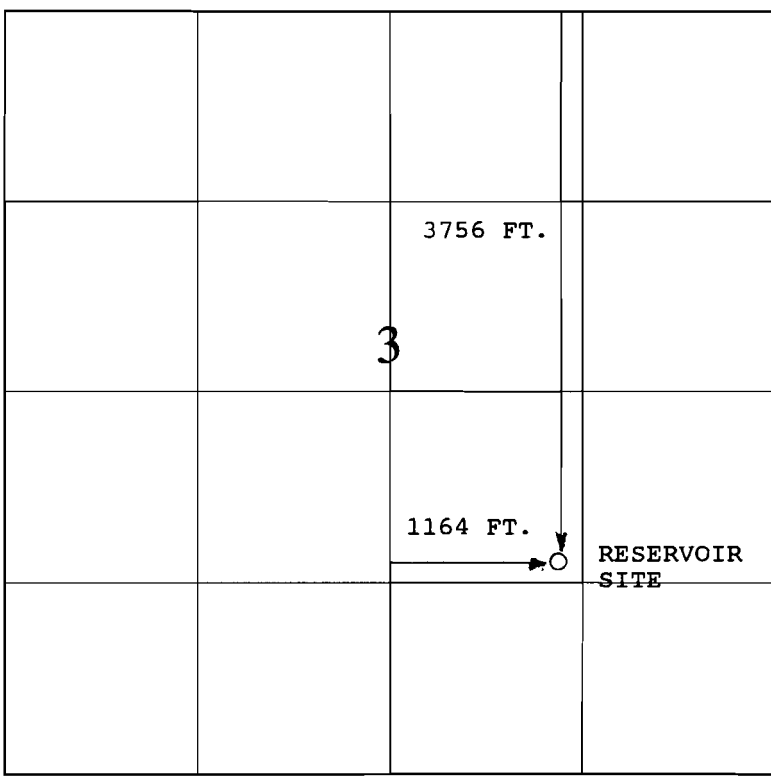

1 IN. = 1320 FT.

### APPLICATION MAP

FOR

### WEST PILOT POCK #2

IN NAME OF

### UNITED STATES BUREAU OF LAND MANAGEMENT

MAY 26, 1993

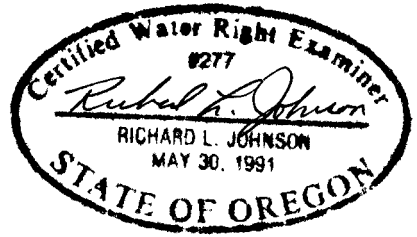

**RECEIVED**

OCT 01 1993

THE PURPOSE OF THIS MAP IS FOR IDENTIFYING THE LOCATION OF THE WATER RIGHT ONLY AND IS NOT INTENDED TO PROVIDE LEGAL DIMENSIONS OR LOCATION OF PROPERTY OWNERSHIP LINES.

WATER RESOURCES DEPT.  
SALEM, OREGON

WRE 6057A OREGON

U.S. BUREAU OF LAND MANAGEMENT - OSO  
BRANCH OF CADASTRAL SURVEY

EXECUTED BY:  
RICHARD L. JOHNSON, PLS, CWRE

LETTER OF AUTHORIZATION  
DATED: MAY 3, 1993

OR-942.1  
P.O. BOX 2965  
PORTLAND OR., 97208

No. R-73684

T. 41 S., R. 2 E., W.M.

IRON PIPE AND  
BRASS CAP

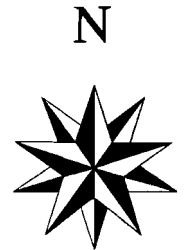
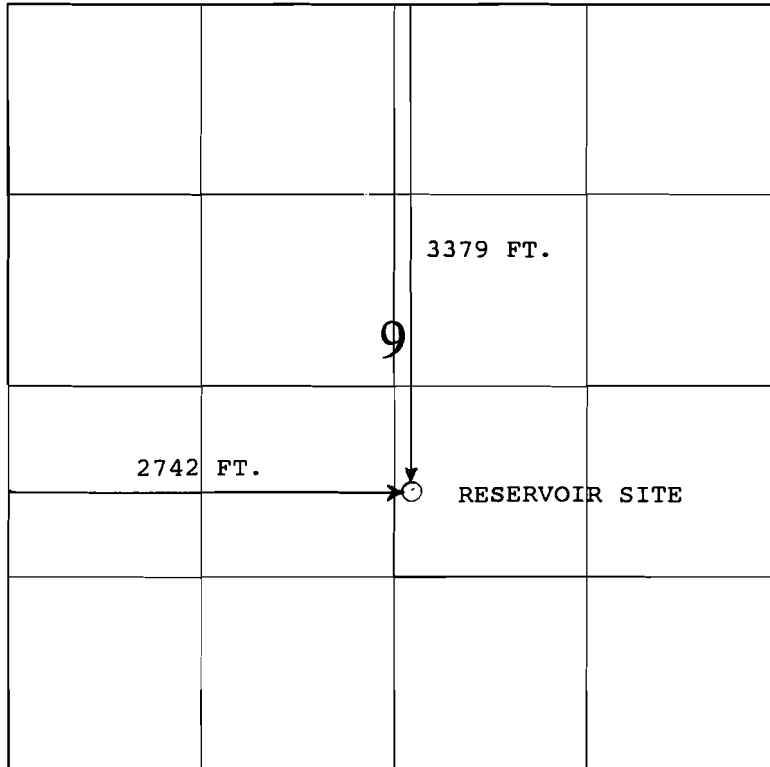

1 IN. = 1320 FT.

# APPLICATION MAP

FOR

## RUSSIAN GULCH

IN NAME OF

UNITED STATES BUREAU OF LAND MANAGEMENT

MAY 26, 1993

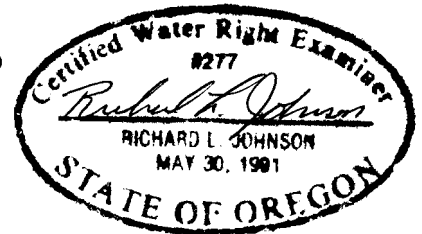

THE PURPOSE OF THIS MAP IS FOR IDENTIFYING THE LOCATION OF THE WATER RIGHT ONLY AND IS NOT INTENDED TO PROVIDE LEGAL DIMENSIONS OR LOCATION OF PROPERTY OWNERSHIP LINES.

WRE 6055A OREGON

**RECEIVED**

OCT 01 1993

WATER RESOURCES DEPT.  
SALEM, OREGON

U.S. BUREAU OF LAND MANAGEMENT - OSO  
BRANCH OF CADASTRAL SURVEY

EXECUTED BY:  
RICHARD L. JOHNSON, PLS, CWRE

LETTER OF AUTHORIZATION  
DATED: MAY 3, 1993

OR-942.1  
P.O. BOX 2965  
PORTLAND OR., 97208