

No. R-73686  
No. 17003  
CERTIFICATE NO.

T. 40 S., R. 3 E., W.M.

RESERVOIR SITE

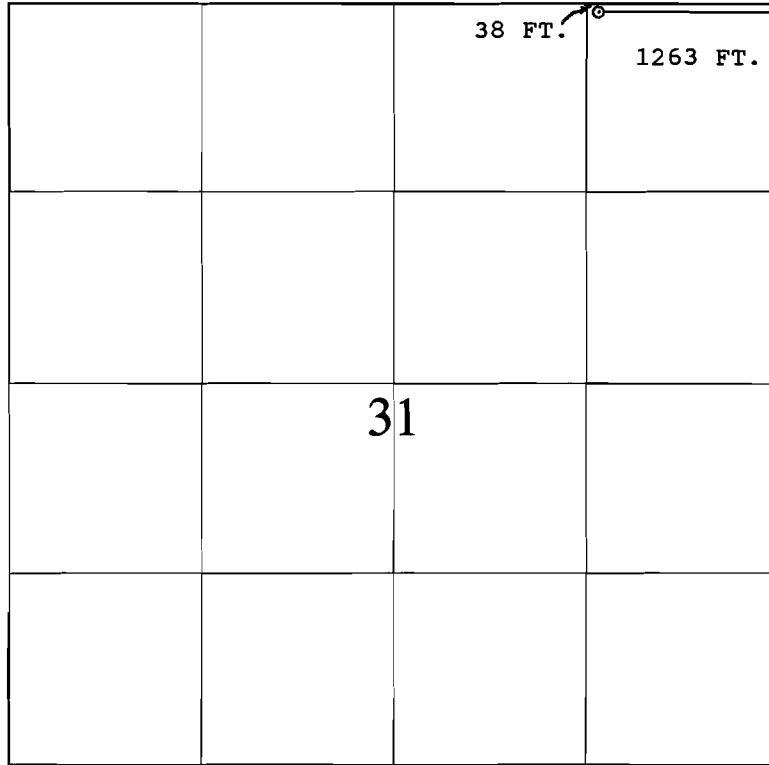

IRON PIPE AND BRASS CAP

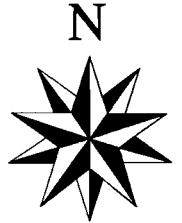

1 IN. = 1320 FT.

# APPLICATION MAP

FOR

## SHEEP CAMP #1

IN NAME OF

### UNITED STATES BUREAU OF LAND MANAGEMENT

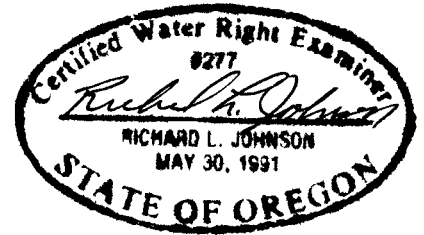

# RECEIVED

JUNE 10, 1993

THE PURPOSE OF THIS MAP IS FOR IDENTIFYING THE LOCATION OF THE WATER RIGHT ONLY AND IS NOT INTENDED TO PROVIDE LEGAL DIMENSIONS OR LOCATION OF PROPERTY OWNERSHIP LINES.

OCT 01 1993

WATER RESOURCES DEPT.  
SALEM, OREGON

WRE 6068A OREGON

U.S. BUREAU OF LAND MANAGEMENT - OSO  
BRANCH OF CADASTRAL SURVEY

EXECUTED BY:  
RICHARD L. JOHNSON, PLS, CWRE

LETTER OF AUTHORIZATION  
DATED: MAY 3, 1993

OR-942.1  
P.O. BOX 2965  
PORTLAND OR., 97208

2-73686

CERTIFICATE NO. 12003

# T. 40 S., R. 3 E., W.M.

## RESERVOIR SITE

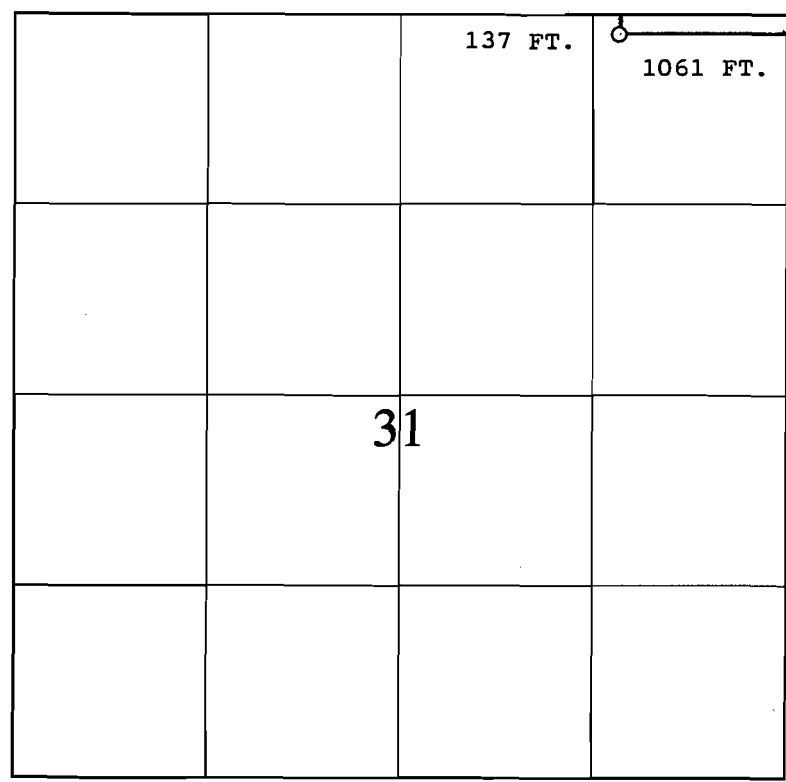

IRON PIPE AND BRASS CAP

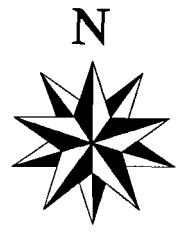

1 IN. = 1320 FT.

### RECEIVED

OCT 01 1993

WATER RESOURCES DEPT.  
SALEM, OREGON

## APPLICATION MAP

FOR

### SHEEP CAMP #2

IN NAME OF

## UNITED STATES BUREAU OF LAND MANAGEMENT

JUNE 10, 1993

THE PURPOSE OF THIS MAP IS FOR IDENTIFYING THE LOCATION OF THE WATER RIGHT ONLY AND IS NOT INTENDED TO PROVIDE LEGAL DIMENSIONS OR LOCATION OF PROPERTY OWNERSHIP LINES.

WRE 6069A OREGON

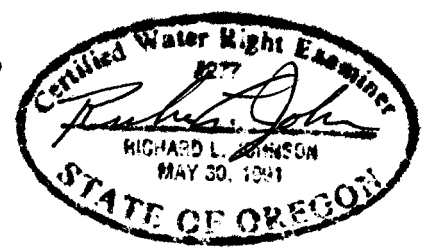

U.S. BUREAU OF LAND MANAGEMENT - OSO  
BRANCH OF CADASTRAL SURVEY

EXECUTED BY:  
RICHARD L. JOHNSON, PLS, CWRE

LETTER OF AUTHORIZATION  
DATED: MAY 3, 1993

OR-942.1  
P.O. BOX 2965  
PORTLAND OR., 97208