

SCHUBERT, FAEO C - TIM R NZE WASCO CO ORE  
 1000 ACRES ± - PARTS SECTIONS 20 - 21 - 29 - TAX LOT 5200

Application No. 73928  
 Permit No.

RESERVOIR - SOURCE - DAM - ACRES FEET CONST - CERTIFICATE NO. 69097

- A** - BROWN CK - DAM - 8 FT x 150 FT - 1.0 1975 ±
- B** - SHEET RUN OFF - 8 FT x 250 FT - 1.9 1955 ±
- C** - SHEET RUN OFF - 8 FT x 210 FT - 0.8 1975 ±

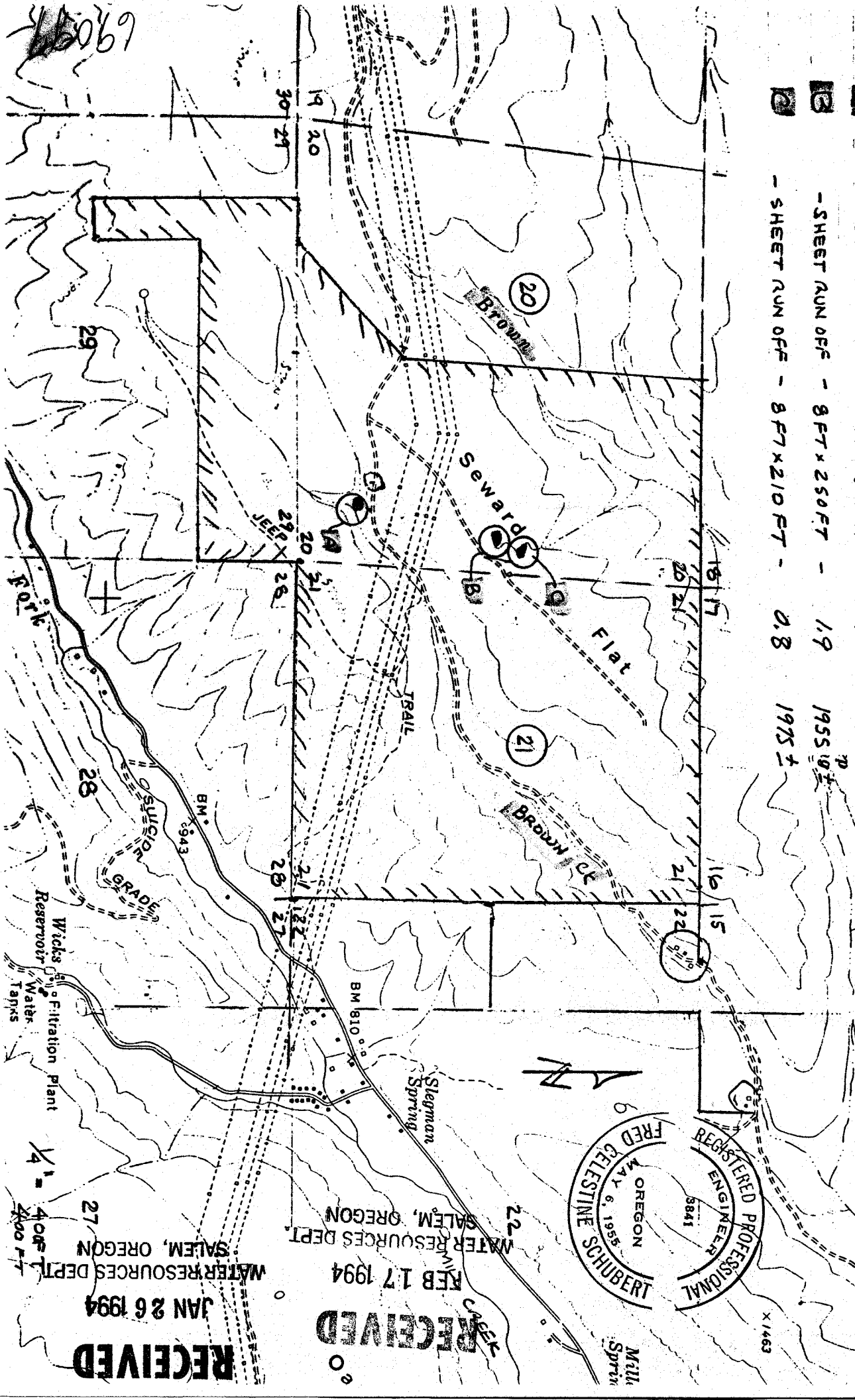

REGISTERED PROFESSIONAL ENGINEER  
 8841  
 FRED CELESTINE SCHUBERT  
 OREGON  
 MAY 6 1915  
 X 1463

RECEIVED  
 FEB 17 1994  
 WATER RESOURCES DEPT.  
 SALEM, OREGON

RECEIVED  
 JAN 26 1994  
 WATER RESOURCES DEPT.  
 SALEM, OREGON

1/4" = 400 FT  
 1/4" = 200 FT