

SCALE: 1" = 400'



OWNER/APPLICANT
ICARE INC.
C/O MICHAEL A. KREBS
717 NW 5TH ST. SUITE 201
GRANTS PASS, OR. 97526
PH. (503) 476-5282

PREPARED BY:
JONATHAN C. SPERO W.R.E. 123
1002 KINCAID RD./P.O. BOX 16
WILLIAMS, OREGON 97544
PHONE (503) 846-6845

RESERVOIR #1
APPROX. VOLUME 3.9 ACRE FEET
(AT FULL POOL)
APPROX. DAM HEIGHT 8'
APPROX. SURFACE AREA 0.60 ACRES

RESERVOIR #2
APPROX. VOLUME 5.5 ACRE FEET
APPROX. SURFACE AREA 1.0 ACRES
CENTER OF DAM PROFILE

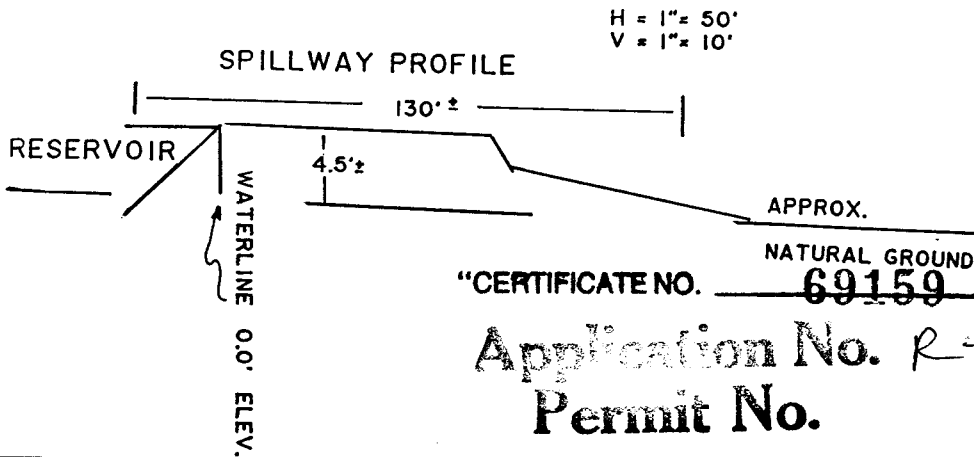
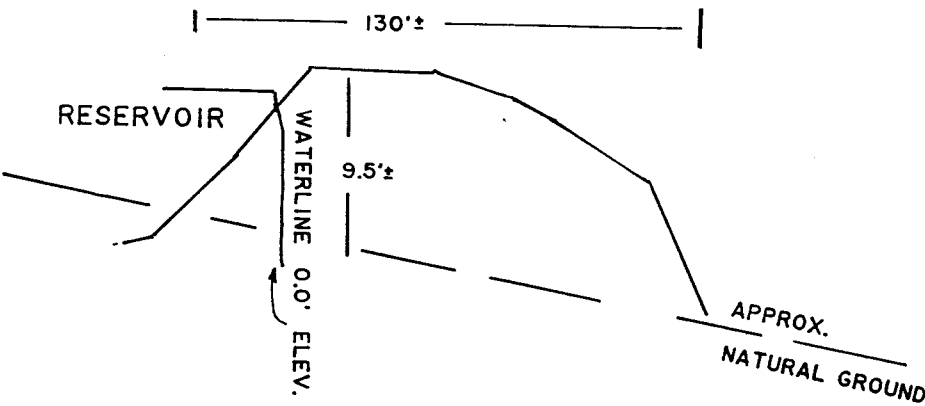
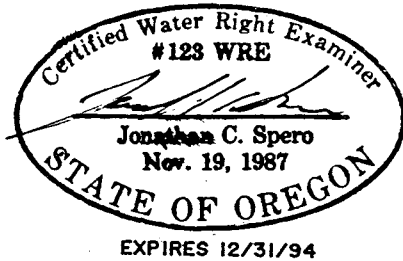

"CERTIFICATE NO. 69159"

Application No. R-74151
Permit No.

RECEIVED

MAY 26 1994

WATER RESOURCES DEPT.
SALEM, OREGON
N 1/4

RESERVOIR / WATER STORAGE
WATER RIGHT APPLICATION MAP
T.34S. R.5W. W.M. SECTION 31
JOSEPHINE COUNTY OREGON

30 | 29
31 | 32

RECEIVED

JUN - 6 1994

WATER RESOURCES DEPT.
SALEM, OREGON

TL 214

TL 200

RESERVOIR #1 LOCATION
950' S. & 1120' E. OF
N 1/4 COR., SEC. 31

RESERVOIR #2 LOCATION
1400' S. & 840' E.
N 1/4 COR., SEC. 31

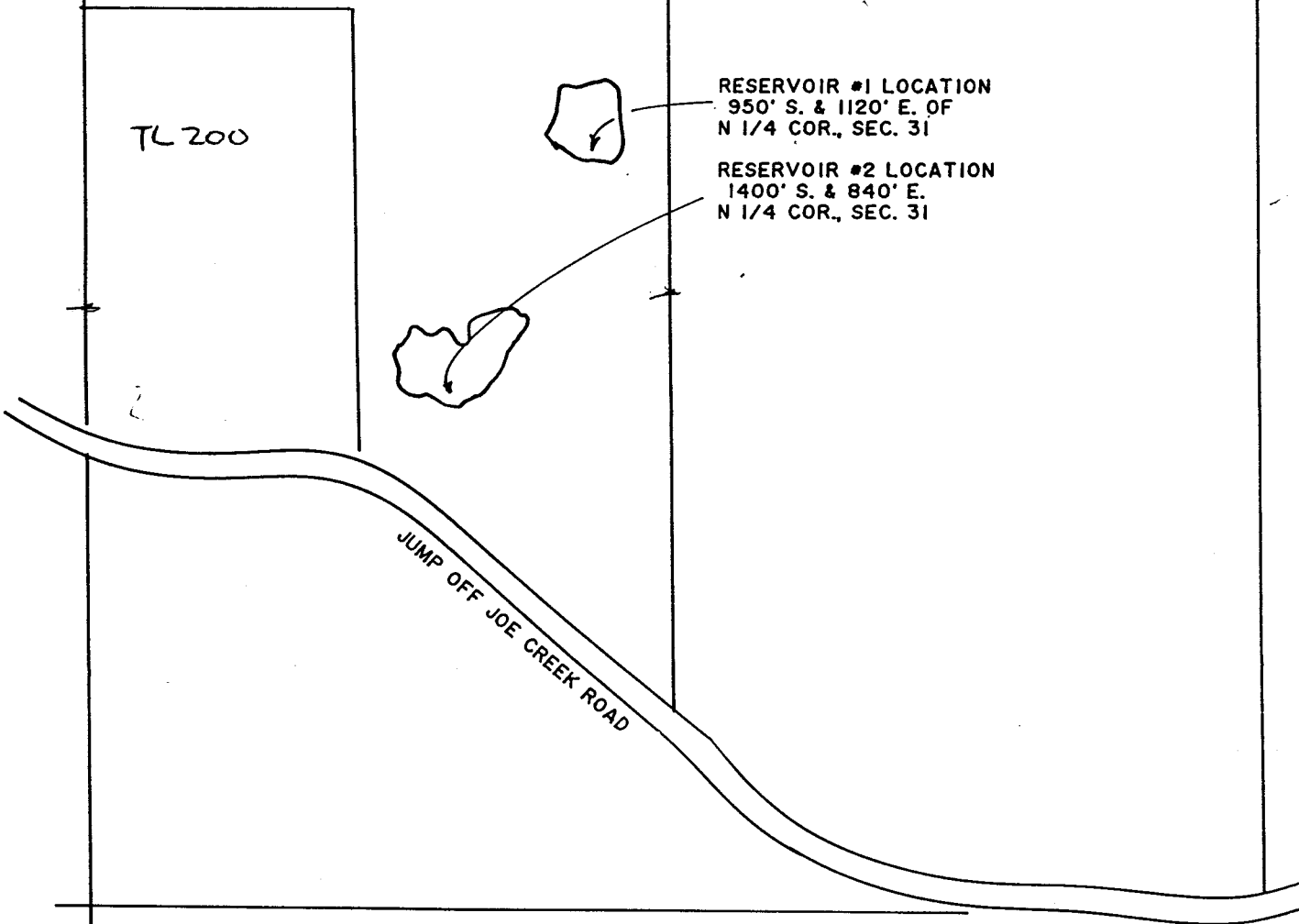

THIS MAP IS FOR THE PURPOSE OF
IDENTIFYING THE LOCATION OF THE
WATER RIGHT ONLY AND IS NOT IN-
TENDED TO PROVIDE LEGAL DIMEN-
SIONS OR LOCATIONS OF PROPERTY
OWNERSHIP LINES.