

Legal Description

T. 30S., R. 3 W., W. M.

AUG - 1 1994

SECTION 26

WATER
SOUTH UMPQUA RIVER

Application No. ^{R-}74394
Permit No.

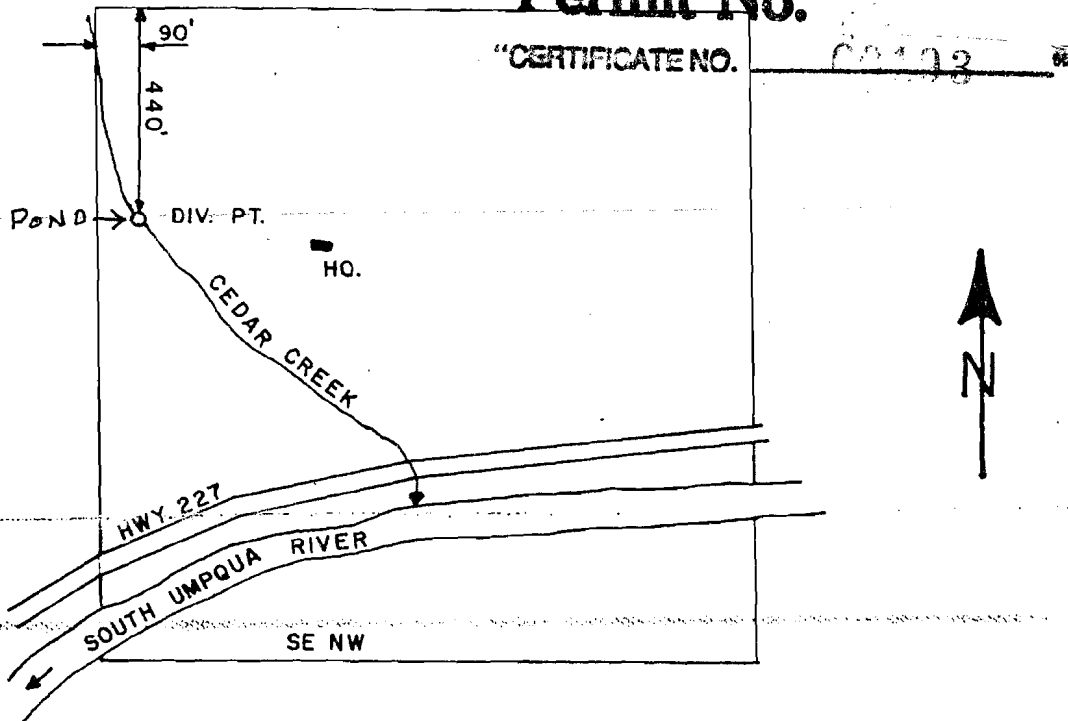

SCALE: 1" = 400'

FINAL PROOF SURVEY
UNDER

Application No. ~~64801~~ Permit No. ~~47527~~
IN NAME OF

JAMES A. AND BETTY L. TIFFEE

Surveyed JUNE 26, 1986, by J. M. SCHMORDE.