

NE 1/4 of NE 1/4 of Sec 35 T2S R45E

JOSEPH QUADRANGLE  
OREGON-WALLOWA CO.  
7.5 MINUTE SERIES (TOPOGRAPHIC)

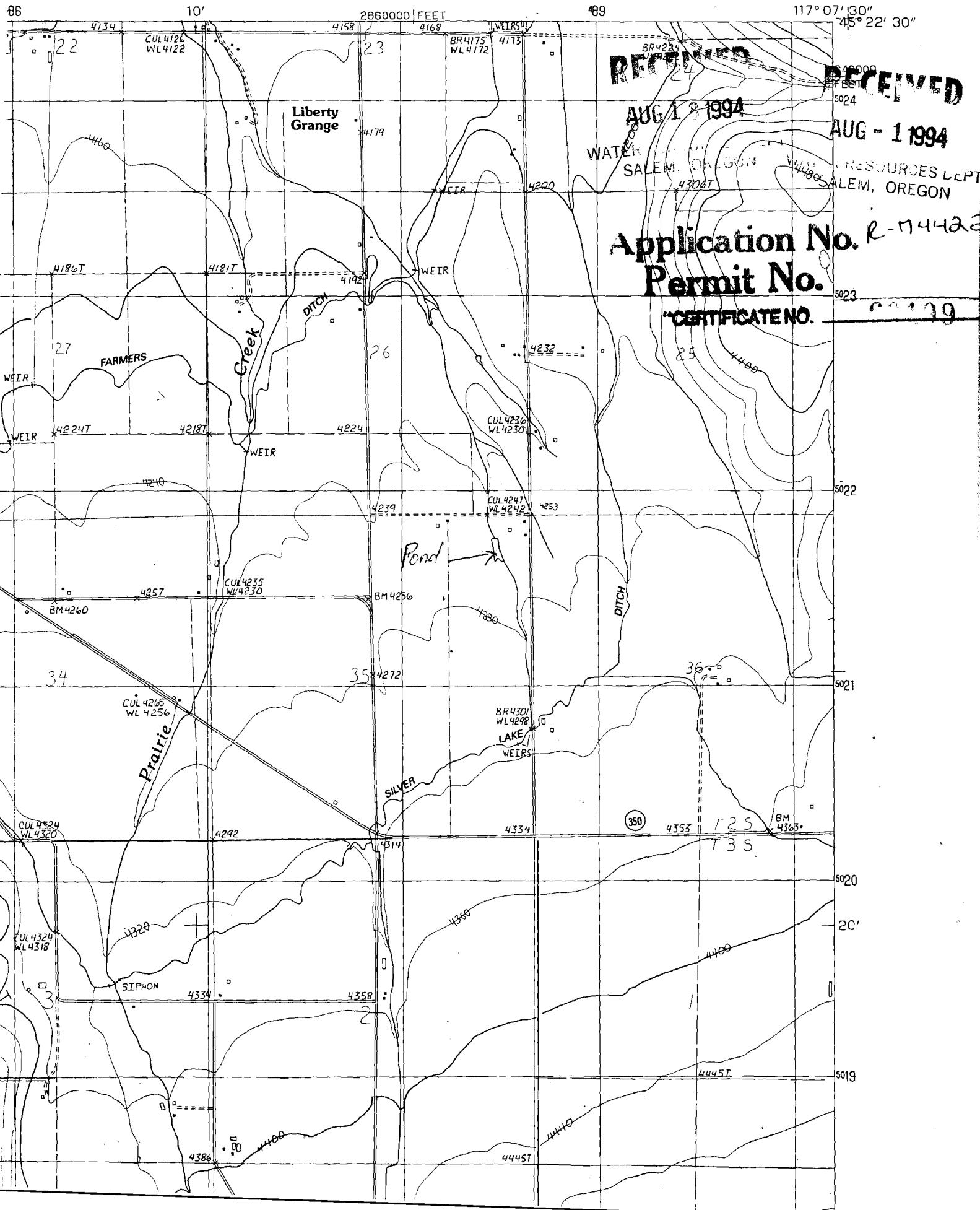

**RECEIVED**  
AUG 1 8 1994  
WATER RESOURCES DEPT.  
SALEM, OREGON  
**Application No. R-74423**  
**Permit No.**  
"CERTIFICATE NO."

No Final Proof Map available

No Permit Map available