

RECEIVED

SEP 24 1994

WATER RESOURCES DEPT.  
SALEM, OREGON

This map was prepared for  
assessment purposes only.

SCALE 1:9600

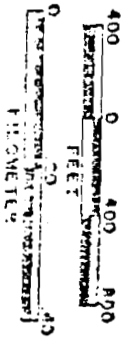

SEE MAP 40 18

SECTION 7 T40S. R19E. W.M.  
LAKE COUNTY  
1" = 400'

SEE MAP 40 19

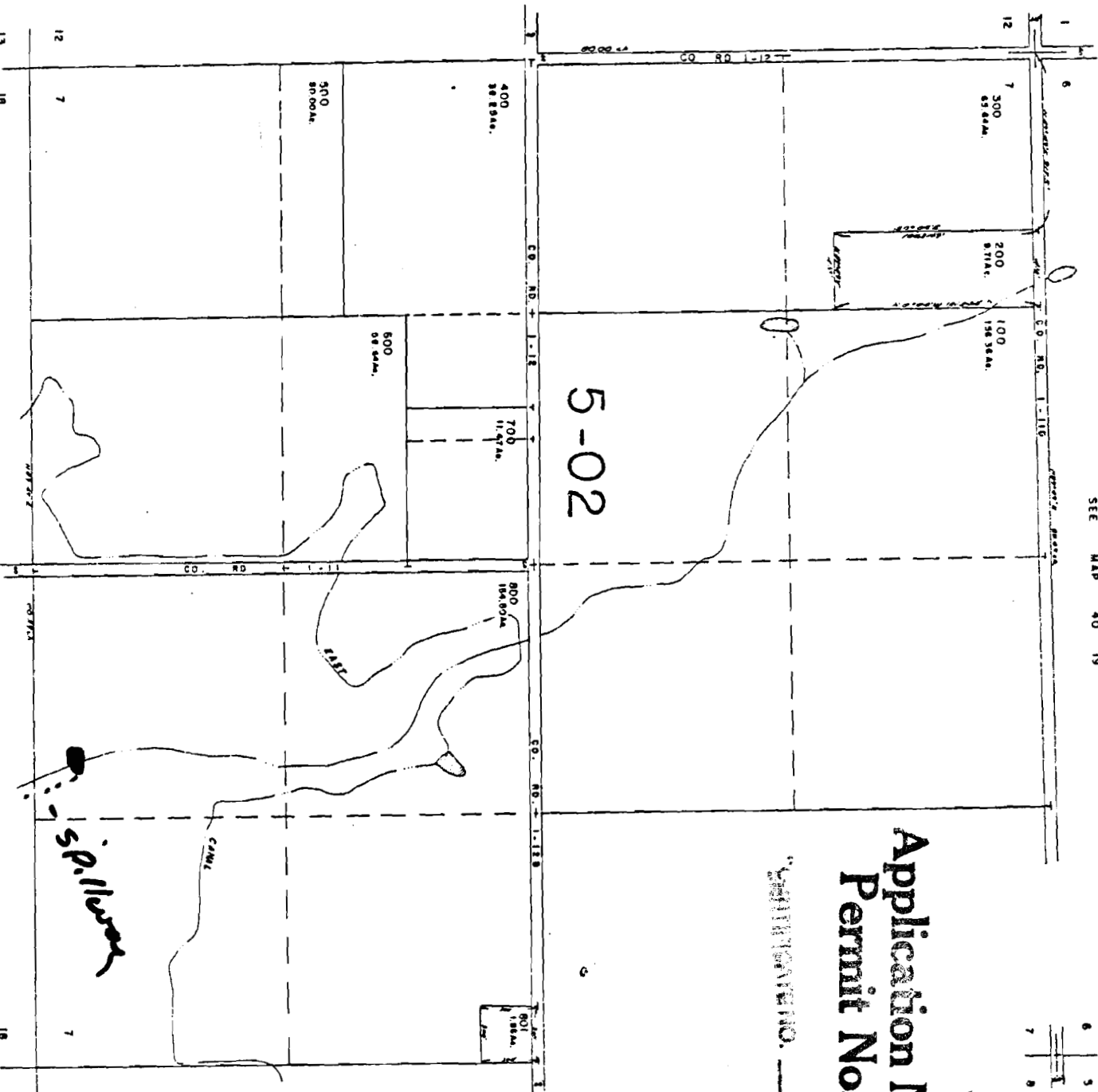

SEE MAP 40 18

Application No. K-94528  
Permit No.

WATERWAY NO. 69236

**No Final Proof Map available**

**No Permit Map available**