

Application No.
Permit No.

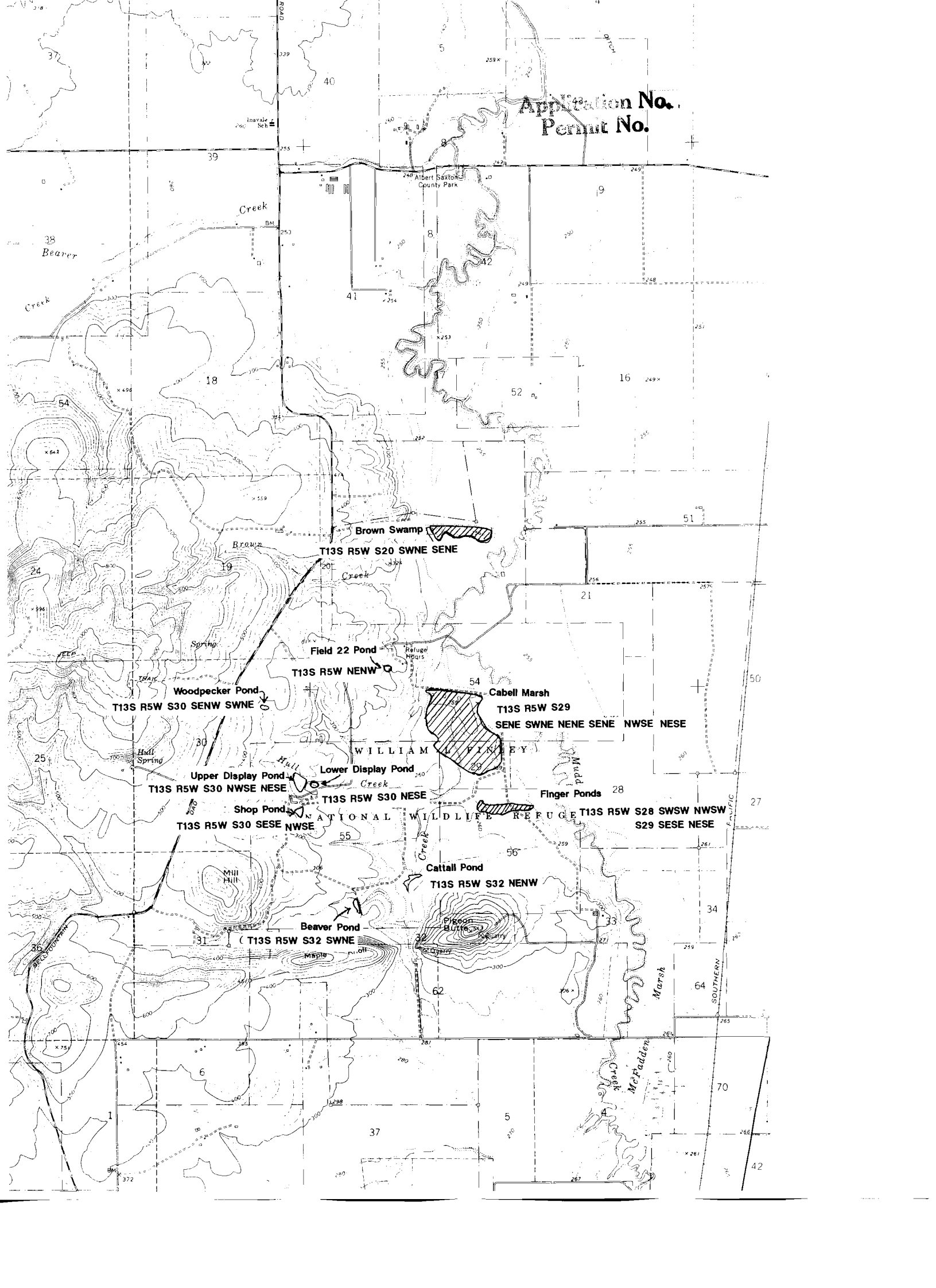

Brown Swamp
T13S R5W S20 SWNE SENE

Field 22 Pond
T13S R5W NENW

Woodpecker Pond
T13S R5W S30 SENW SWNE

Upper Display Pond
T13S R5W S30 NWSE NESE

Shop Pond
T13S R5W S30 SESE NWSE

Beaver Pond
T13S R5W S32 SWNE

Cattail Pond
T13S R5W S32 NENW

Cabell Marsh
T13S R5W S29
SENE SWNE NENE SENE NWSE NESE

Finger Ponds
T13S R5W S28 SWSW NWSW
S29 SESE NESE

WILLIAM W. FISHER

NATIONAL WILDLIFE REFUGE

SOUTHERN PACIFIC

Albert Saxton
County Park

38
Beaver
Creek

Creek

Creek

Brown
Creek

Creek

Creek

Creek

Creek

Mudd
Creek

Marsh

McFadden
Creek

Invasive
Set

gutter

39

255

253

18

19

30

55

31

6

1

40

41

52

21

54

56

32

37

3

5

8

42

16

51

28

55

33

5

4

259

249

249

249

255

255

250

259

259

267

259

249

249

249

255

255

250

259

259

267

249

249

249

255

255

250

259

259

267

50

27

34

64

70

42

39

255

253

18

19

30

55

31

6

1

40

41

52

21

54

56

32

37

3

5

8

42

16

51

28

55

33

5

4

259

249

249

249

255

255

250

259

259

267

259

249

249

249

255

255

250

259

259

267

249

249

249

255

255

250

259

259

267

50

27

34

64

70

42

39

255

253

18

19

30

55

31

6

1

40

41

52

21

54

56

32

37

3

5

8

42

16

51

28

55

33

5

4

259

249

249

249

255

255

250

259

259

267

259

249

249

249

255

255

250

259

259

267

249

249

249

255

255

250

259

259

267

50

27

34

64

70

42

39

255

253

18

19

30

55

31

6

1

40

41

52

21

54

56

32

37

3

5

8

42

16

51

28

55

33

5

4

259

249

249

249

255

255

250

259

259

267

259

249

249

249

255

255

250

259

259

267

249

249

249

255

255

250

259

259

267

50

27

34

64

70

42

39

255

253

18

19

30

55

31

6

1

40

41

52

21

54

56

32

37

3

5

8

42

16

51

28

55

33

5

4

259

249

249

249

255

255

250

259

259

267

259

249

249

249

255

255

250

259

259

267

249

249

249