

IDENTIFICATION NO.

69396 R75130

7  
1475 III NW  
(DIXIE MOUNTAIN)

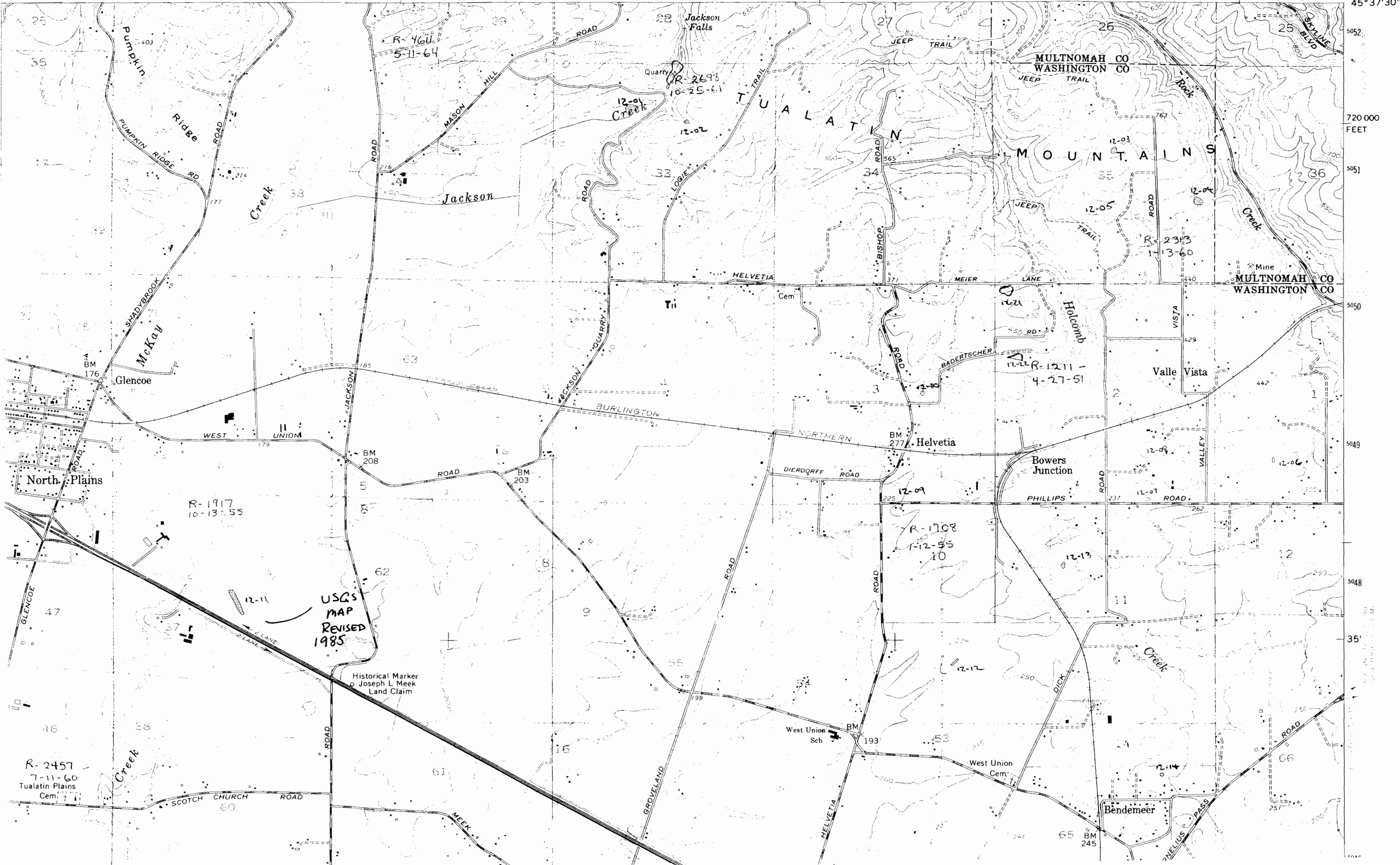

R-2457  
7-11-60  
Tualatin Plains  
Cem.

R-1917  
10-13-55

USGS  
MAP  
REVISED  
1985

Historical Marker  
of Joseph L Meek  
Land Claim

R-1708  
1-12-55  
10

R-2313  
1-13-60

R-1211  
4-27-51

R-4611  
5-11-64

12-01  
Creek

12-03

12-05

12-04

12-02

12-07

12-08

12-09

12-10

12-11

12-12

12-13

12-14

12-15

12-16

12-17

12-18

12-19

12-20

12-21

12-22

12-23

12-24

12-25

12-26

12-27

12-28

12-29

12-30

12-31

12-32

12-33

12-34

12-35

12-36

12-37

12-38

12-39

12-40

12-41

12-42

12-43

12-44

12-45

12-46

12-47

12-48

12-49

12-50

12-51

12-52

12-53

12-54

12-55

12-56

12-57

12-58

12-59

12-60

12-61

12-62

12-63

12-64

12-65

12-66

12-67

12-68

12-69

12-70

12-71

12-72

12-73

12-74

12-75

12-76

12-77

12-78

12-79

12-80

12-81

12-82

12-83

12-84

12-85

12-86

12-87

12-88

12-89

12-90

12-91

12-92

12-93

12-94

12-95

12-96

12-97

12-98

12-99

12-100

12-101

12-102

12-103

12-104

12-105

12-106

12-107

12-108

12-109

12-110

12-111

12-112

12-113

12-114

12-115

12-116

12-117

12-118

12-119

12-120

12-121

12-122

12-123

12-124

12-125

12-126

12-127

12-128

12-129

12-130

12-131

12-132

12-133

12-134

12-135

12-136

12-137

12-138

12-139

12-140

12-141

12-142

12-143

12-144

12-145

12-146

12-147

12-148

12-149

12-150

12-151

12-152

12-153

12-154

12-155

12-156

12-157

12-158

12-159

12-160

12-161

12-162

12-163

12-164

12-165

12-166

12-167

12-168

12-169

12-170

12-171

12-172

12-173

12-174

12-175

12-176

12-177

12-178

12-179

12-180

12-181

12-182

12-183

12-184

12-185

12-186

12-187

12-188

12-189

12-190

12-191

12-192

12-193

12-194

12-195

12-196

12-197

12-198

12-199

12-200

12-201

12-202

12-203

12-204

12-205

12-206

12-207

12-208

12-209

12-210

12-211

12-212

12-213

12-214

12-215

12-216

12-217

12-218

12-219

12-220

12-221

12-222

12-223

12-224

12-225

12-226

12-227

12-228

12-229

12-230

12-231

12-232

12-233

12-234

12-235

12-236

12-237

12-238

12-239

12-240

12-241

12-242

12-243

12-244

12-245

12-246

12-247

12-248

12-249

12-250

12-251

12-252

12-253

12-254

12-255

12-256

12-257

12-258

12-259

12-260

12-261

12-262

12-263

12-264

12-265

12-266

12-267

12-268

12-269

12-270

12-271

12-272

12-273

12-274

12-275

12-276

12-277

12-278

12-279