

R75274

APPLICATION MAP

IN THE NAME OF THE ROADS END RANCH

SECTIONS 5 & 6, T 23 S, R 7 W, W.M.

CERTIFICATE NO. 69458

NOV 19 1987

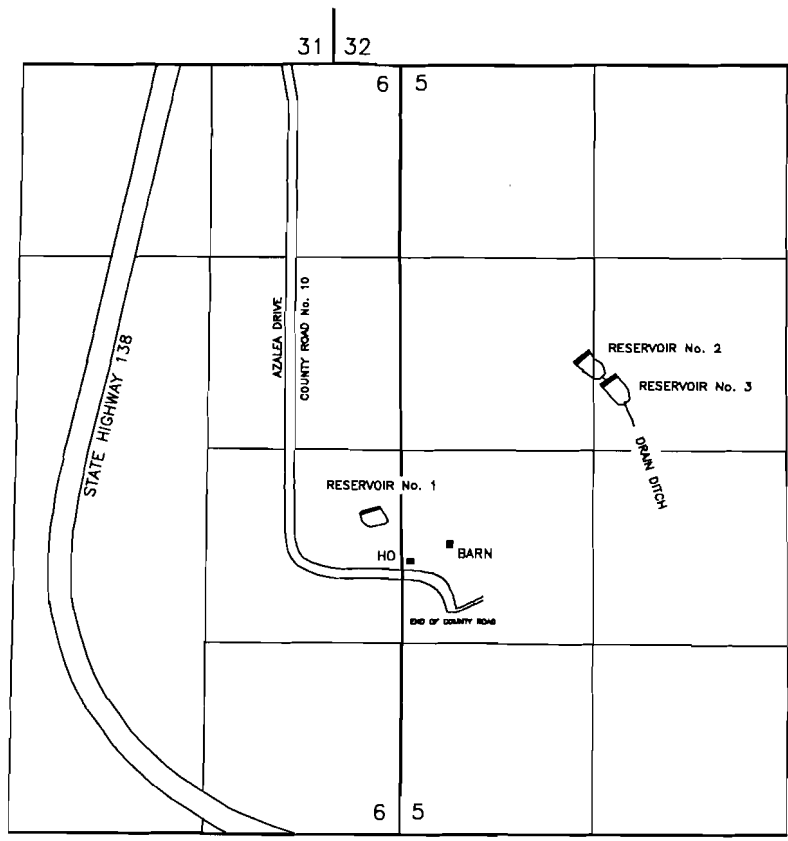
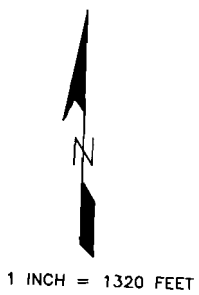

THE RESERVOIRS ARE TO BE LOCATED AS FOLLOWS:

- RESERVOIR No. 1: NE 1/4 SE 1/4 OF SECTION 6;
 - RESERVOIR No. 2: SW 1/4 NW 1/4 OF SECTION 5; and
 - RESERVOIR No. 3: SE 1/4 NW 1/4 OF SECTION 5;
- ALL WITHIN TOWNSHIP 23 SOUTH, RANGE 7 WEST, W.M.; DOUGLAS COUNTY.

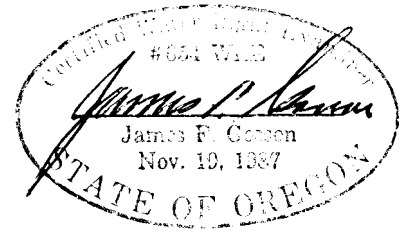

THE PURPOSE OF THIS MAP IS TO IDENTIFY THE LOCATION OF THE WATER RIGHT. IT IS NOT INTENDED TO PROVIDE INFORMATION RELATIVE TO THE LOCATION OF PROPERTY OWNERSHIP BOUNDARY LINES.