

XREFS:

T.18S.,R.12E.,W.M.

SECTIONS 5 AND 6

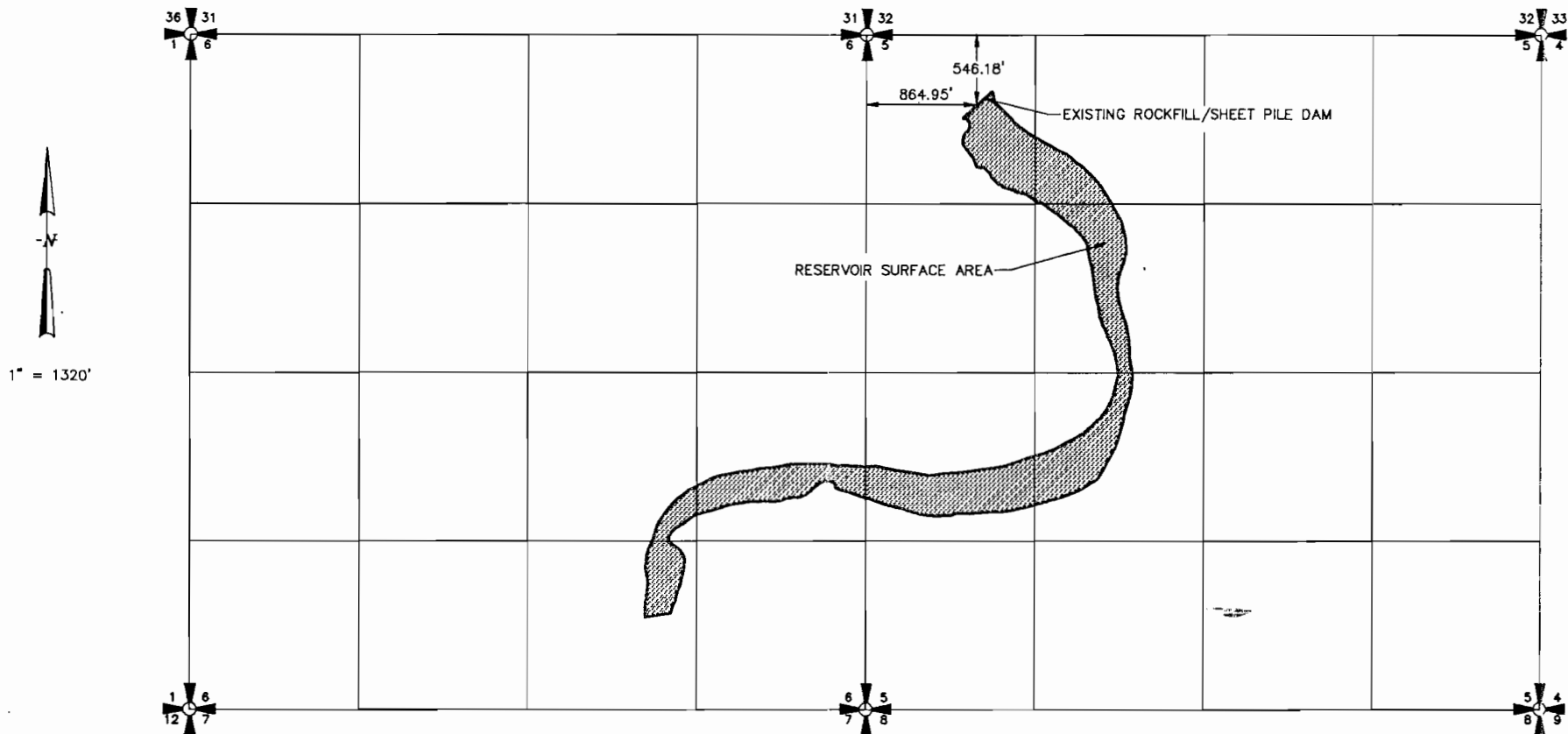

1" = 1320'

LEGEND:
 Reservoir Surface Area
 Total: (in acres)
 Reservoir Surface Area 46.60

Note: This map was prepared for the purpose of identifying the location of water rights only, and is not intended to provide dimensions or the location of property ownership lines.

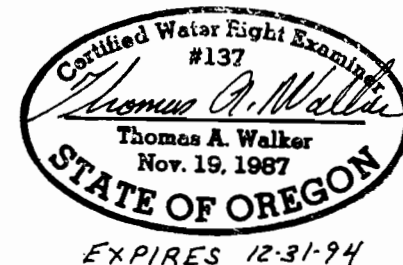

SECTION, TOWNSHIP, RANGE: 18S/12E/5&6

W&HPACIFIC
 155 N.E. Revere
 Bend, OR 97701
 Phone: (503) 388-4255 Fax: (503) 388-4229
 Planning * Engineering * Surveying
 Landscape Architecture * Environmental Services

W&HP
 DRAWN BY: NLM
 CHECKED BY: _____
 PLOT DATE: 11/3/94
 FILE NAME: APPMAP.DWG

BROOKS RESOURCES CORPORATION © W&H PACIFIC, 1993
PERMIT TO CONSTRUCT A RESERVOIR
APPLICATION MAP
 BEND/DESCHUTES OREGON

SCALE: 1"=200'	PROJECT NO. 13260503	DRAWING FILE NAME: APPMAP.DWG	SHEET #1	1/1
-------------------	-------------------------	----------------------------------	-------------	-----

"CERTIFICATE NO. 09517" R75370