

Application No. 75654
 Permit No.

"OFFICE NO. 00001"



HENSLEY BUTTE, OREG.
 NE/4 PRINEVILLE 15' QUADRANGLE
 44120-D7-TF-024
 1988
 DMA 1872 IV NE-SERIES V892

WATER RIGHT MAP
 RESERVOIR
 APPLICATION
 SEC. 6, T14S, R16E,
 WM, CROOK COUNTY,
 OREGON
 OWNER-APPLICANT
 LEWIE STAHANCYK
 522411 ELLIOTT LN.
 PRINEVILLE, OR
 97754
 [503] 447-6665

RECEIVED
 DEC 20 1994

WATER RESOURCES DEPT.
 SALEM, OREGON

SCALE 1:24 000

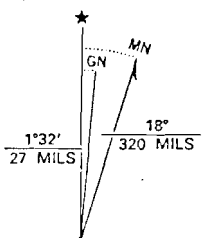
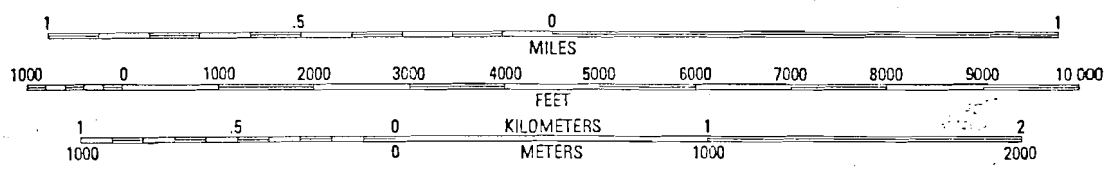

CONTOUR INTERVAL 40 FEET
 SUPPLEMENTARY CONTOUR INTERVAL 20 FEET
 NATIONAL GEODETIC VERTICAL DATUM OF 1929

THIS MAP COMPLIES WITH NATIONAL MAP ACCURACY STANDARDS
 FOR SALE BY U. S. GEOLOGICAL SURVEY, DENVER, COLORADO 80225, OR RESTON, VIRGINIA 22092
 A FOLDER DESCRIBING TOPOGRAPHIC MAPS AND SYMBOLS IS AVAILABLE ON REQUEST

GRID AND 1983 MAGNETIC NORTH
 DECLINATION AT CENTER OF SHEET

Application No. 75654
 Permit No. 00004

RECEIVED

DEC 23 1994

WATER RESOURCES DEPT.
 SALEM, OREGON

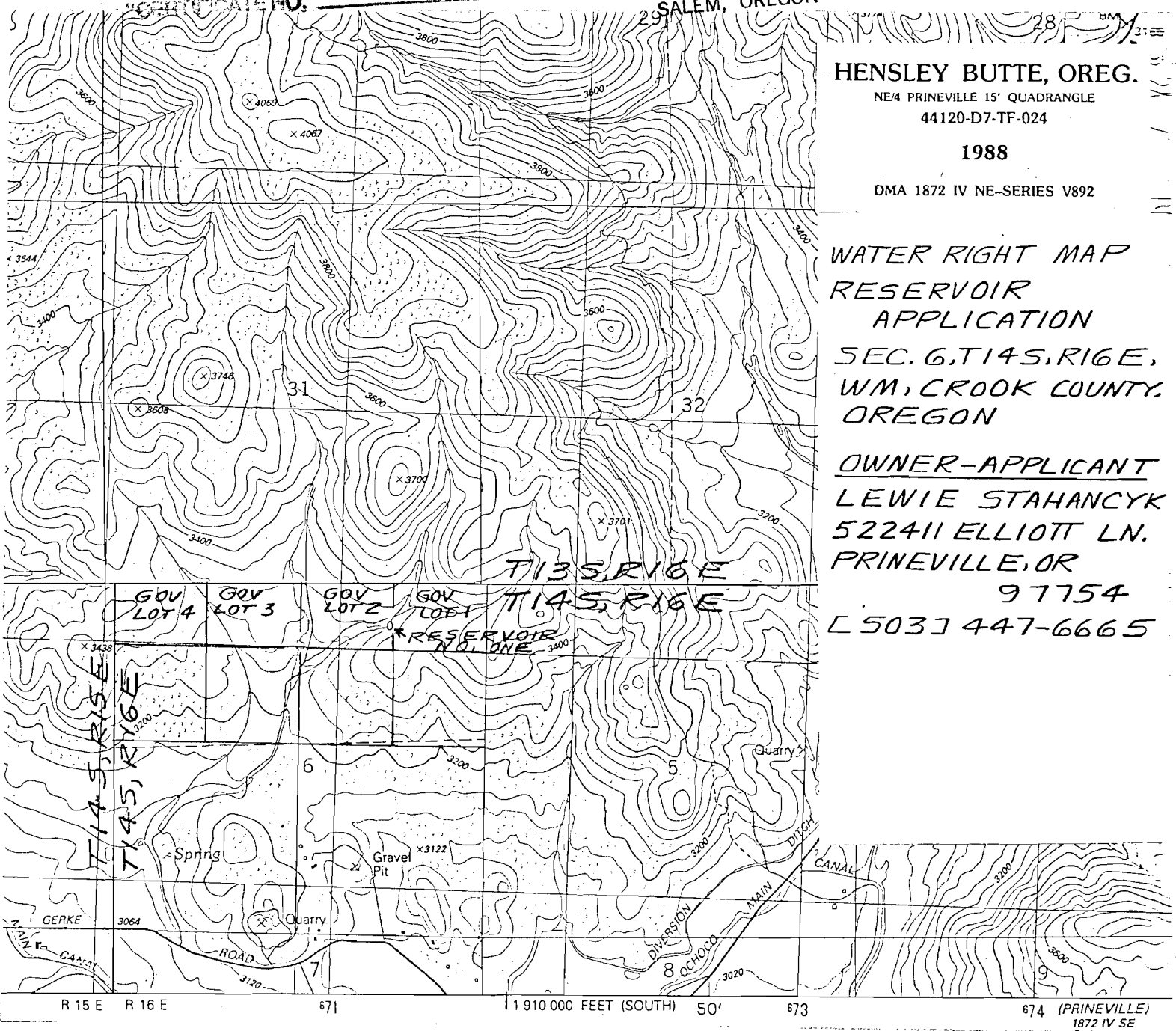

HENSLEY BUTTE, OREG.

NE/4 PRINEVILLE 15' QUADRANGLE
 44120-D7-TF-024

1988

DMA 1872 IV NE-SERIES V892

WATER RIGHT MAP
 RESERVOIR
 APPLICATION
 SEC. 6, T14S, R16E,
 WM, CROOK COUNTY,
 OREGON

OWNER-APPLICANT
 LEWIE STAHANCYK
 522411 ELLIOTT LN.
 PRINEVILLE, OR
 97754
 [503] 447-6665

SCALE 1:24 000

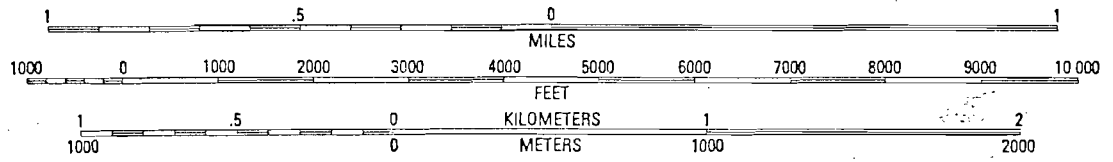
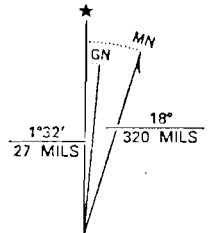

CONTOUR INTERVAL 40 FEET
 SUPPLEMENTARY CONTOUR INTERVAL 20 FEET
 NATIONAL GEODETIC VERTICAL DATUM OF 1929

GRID AND 1988 MAGNETIC NORTH
 DECLINATION AT CENTER OF SHEET

THIS MAP COMPLIES WITH NATIONAL MAP ACCURACY STANDARDS
 FOR SALE BY U. S. GEOLOGICAL SURVEY, DENVER, COLORADO 80225, OR RESTON, VIRGINIA 22092
 A FOLDER DESCRIBING TOPOGRAPHIC MAPS AND SYMBOLS IS AVAILABLE ON REQUEST