

RECEIVED

DEC 22 1994

69788

1794

30"

1792

Application No. 2-75777

Permit No.

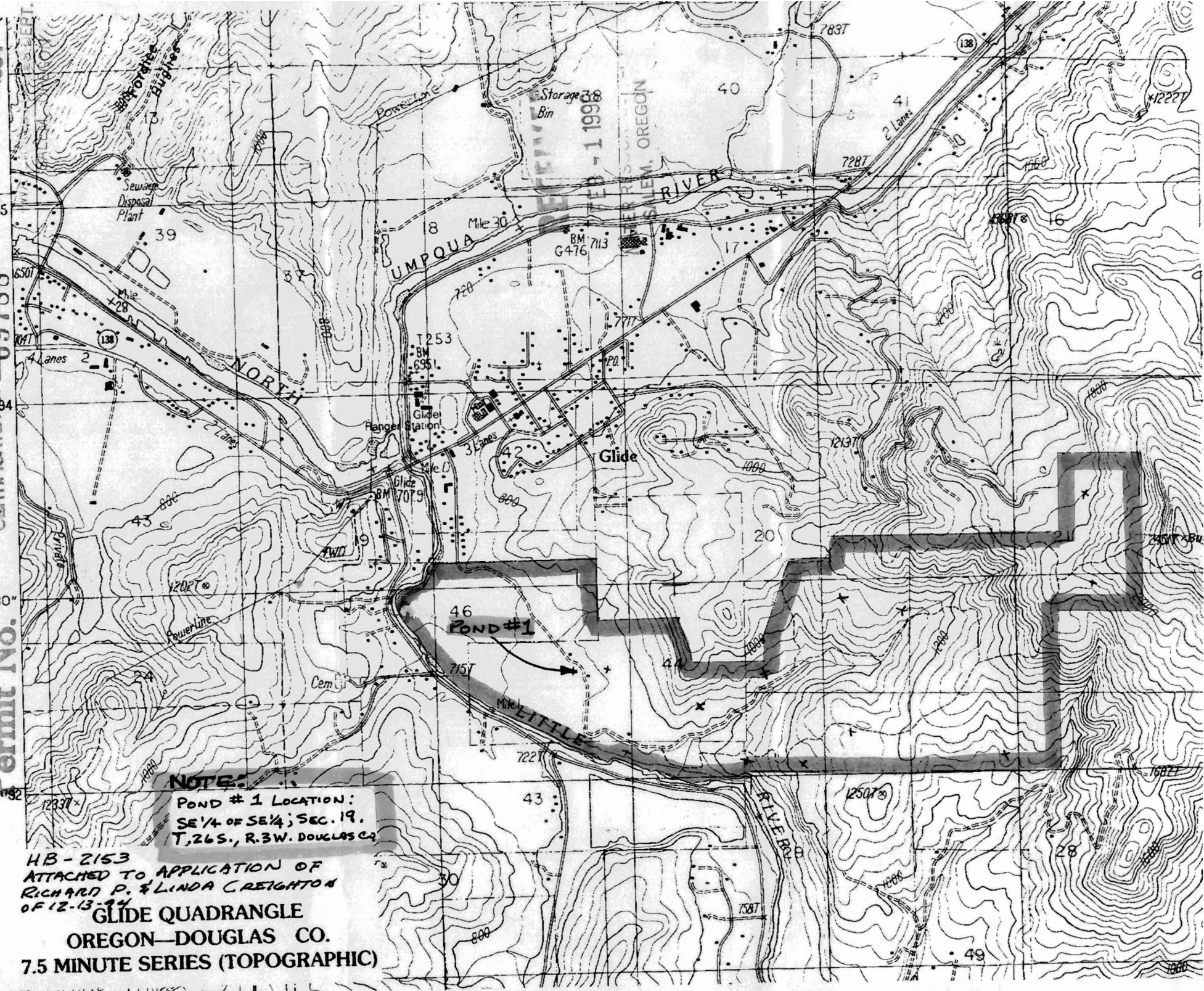

**NOTE:**

POND # 1 LOCATION:  
SE 1/4 OF SE 1/4; SEC. 19,  
T. 26 S., R. 3 W. DOUGLAS CO.

HB-2153  
ATTACHED TO APPLICATION OF  
RICHARD P. & LINDA CREIGHTON  
OF 12-13-94  
GLIDE QUADRANGLE  
OREGON-DOUGLAS CO.  
7.5 MINUTE SERIES (TOPOGRAPHIC)