

Surveyed Oct 10, 1961, by R. Jackson  
JUN. 29, 1966, by L. Gould

~~ON CUTOFF NORTH~~

Application No. ~~6-633~~ Permit No. ~~6-2969~~  
IN NAME OF

# FINAL PROOF SURVEY UNDER

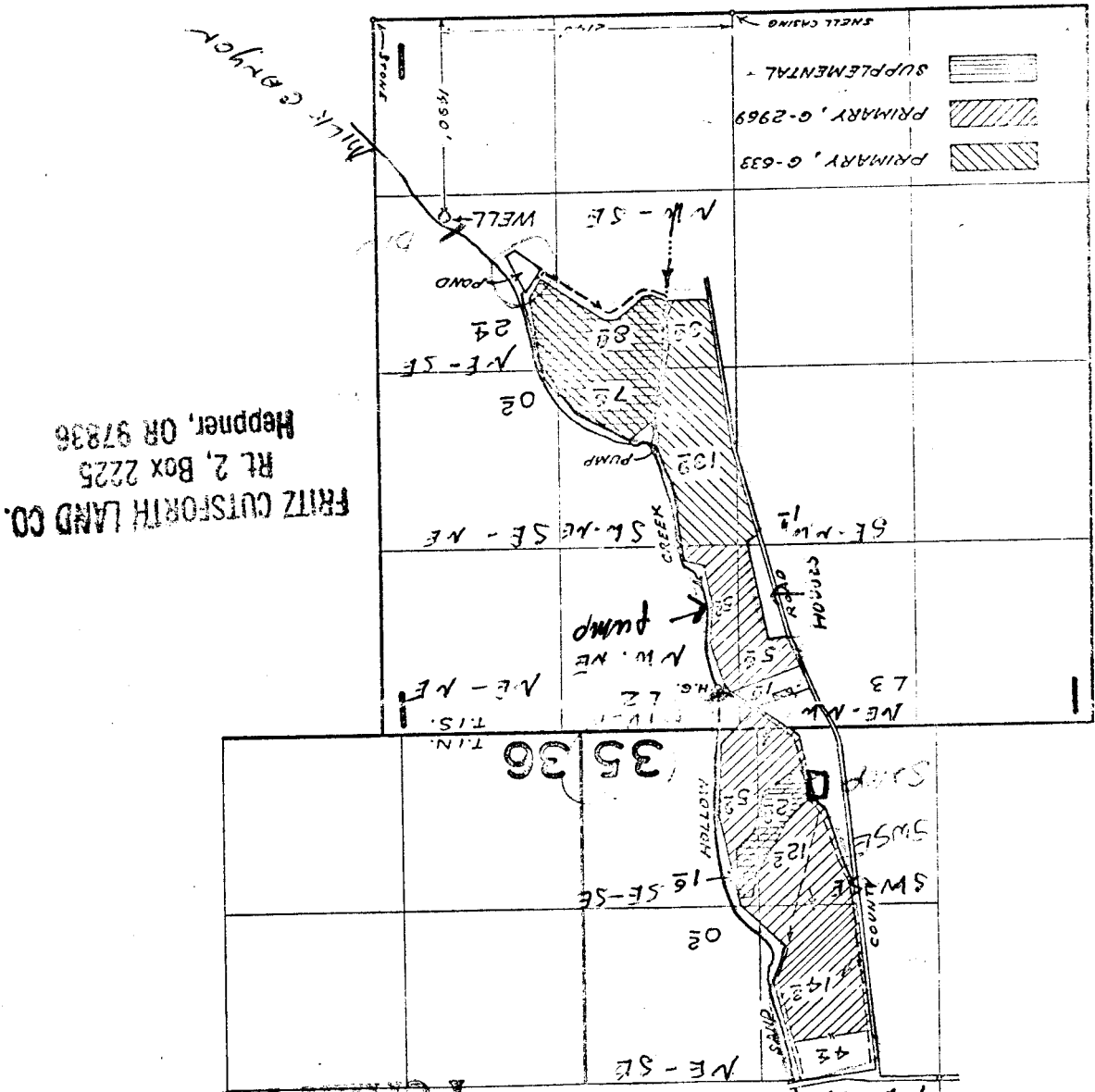

FRITZ CUTSFORTH LAND CO.  
Rt. 2, Box 2225  
Heppner, OR 97836

69909  
T.S. & N.R. 26 E. W.M.  
Application No. R-75918  
Permit No.

RECEIVED  
JAN 24 1966  
FOREST RESOURCES DEPT.  
SALEM, OREGON