

RECEIVED

SEP 17 1997

WATER RESOURCES DEPT.
SALEM, OREGON

MALHEUR NATIONAL WILDLIFE REFUGE

HB-2153

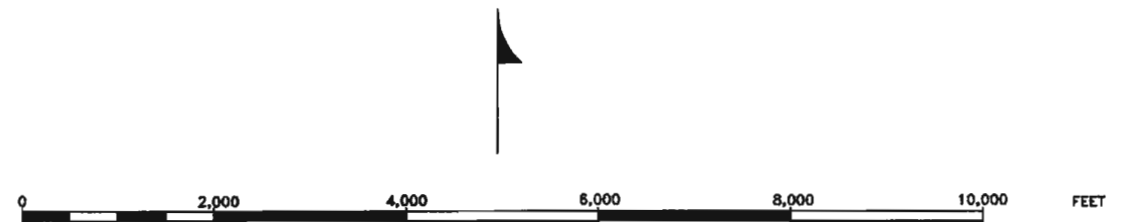

UNIT 10

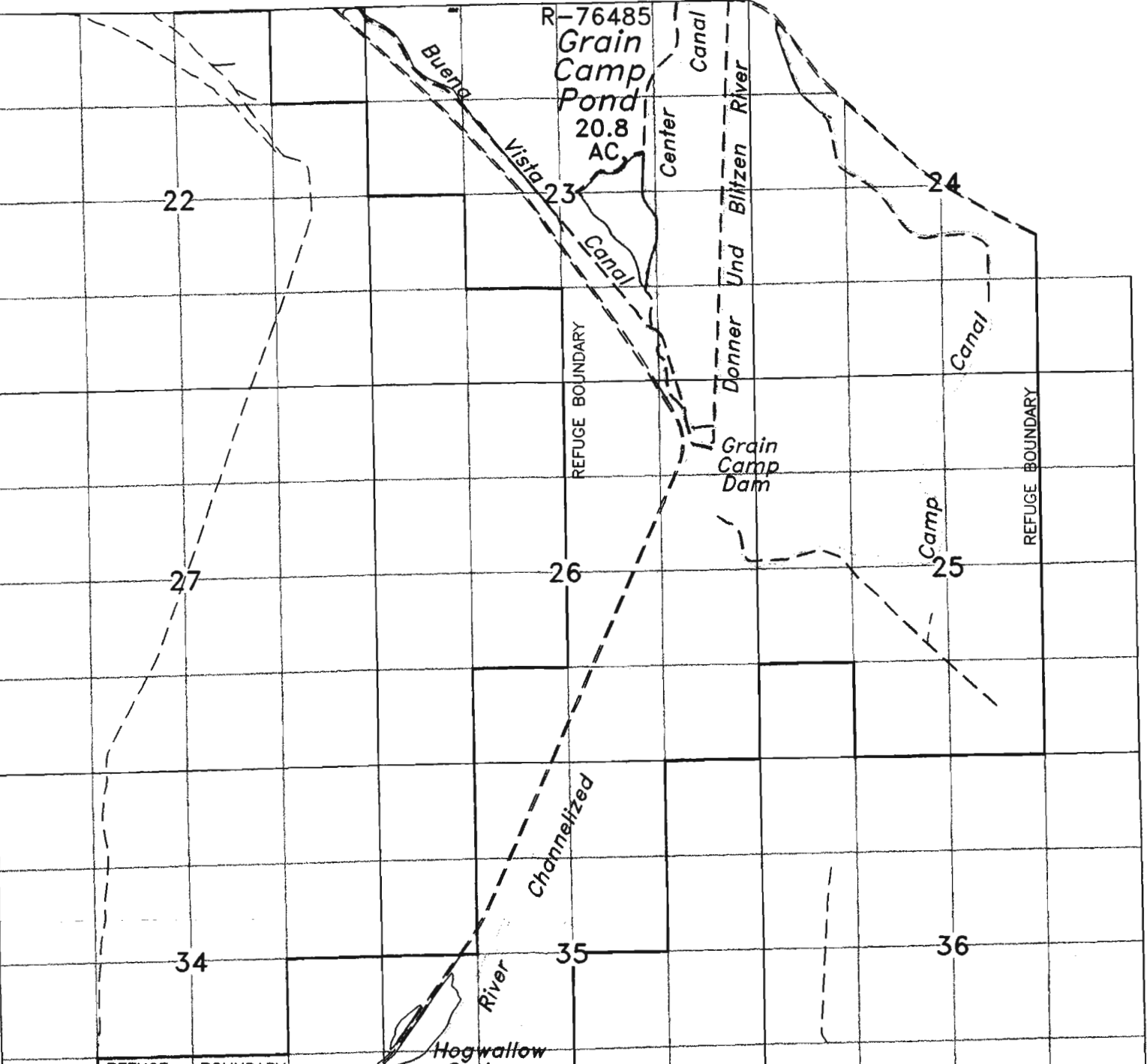

T. 29 S., R. 31 E.
T. 30 S., R. 31 E.

T. 29 S., R. 32 E.
T. 30 S., R. 32 E.

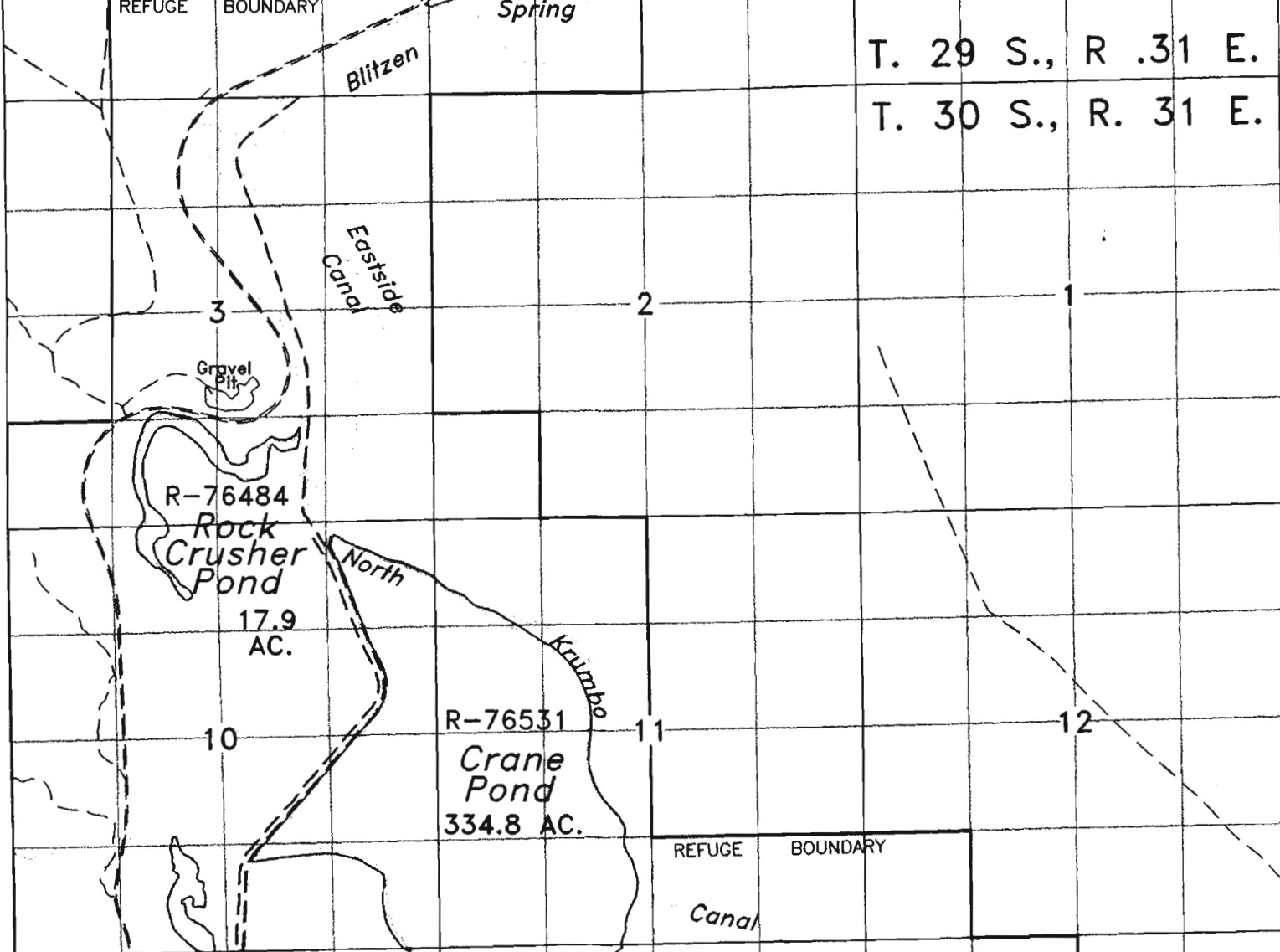

R-76492
WITZEL
POND
10.2 AC.

R-76531
Crane
Pond
334.8 AC.

R-76483
Krumbo
Pond
17.3 AC.

R-76493
Krumbo
Swamp
28.6 AC.

	POND AREA
	POND APPLICATION NUMBER

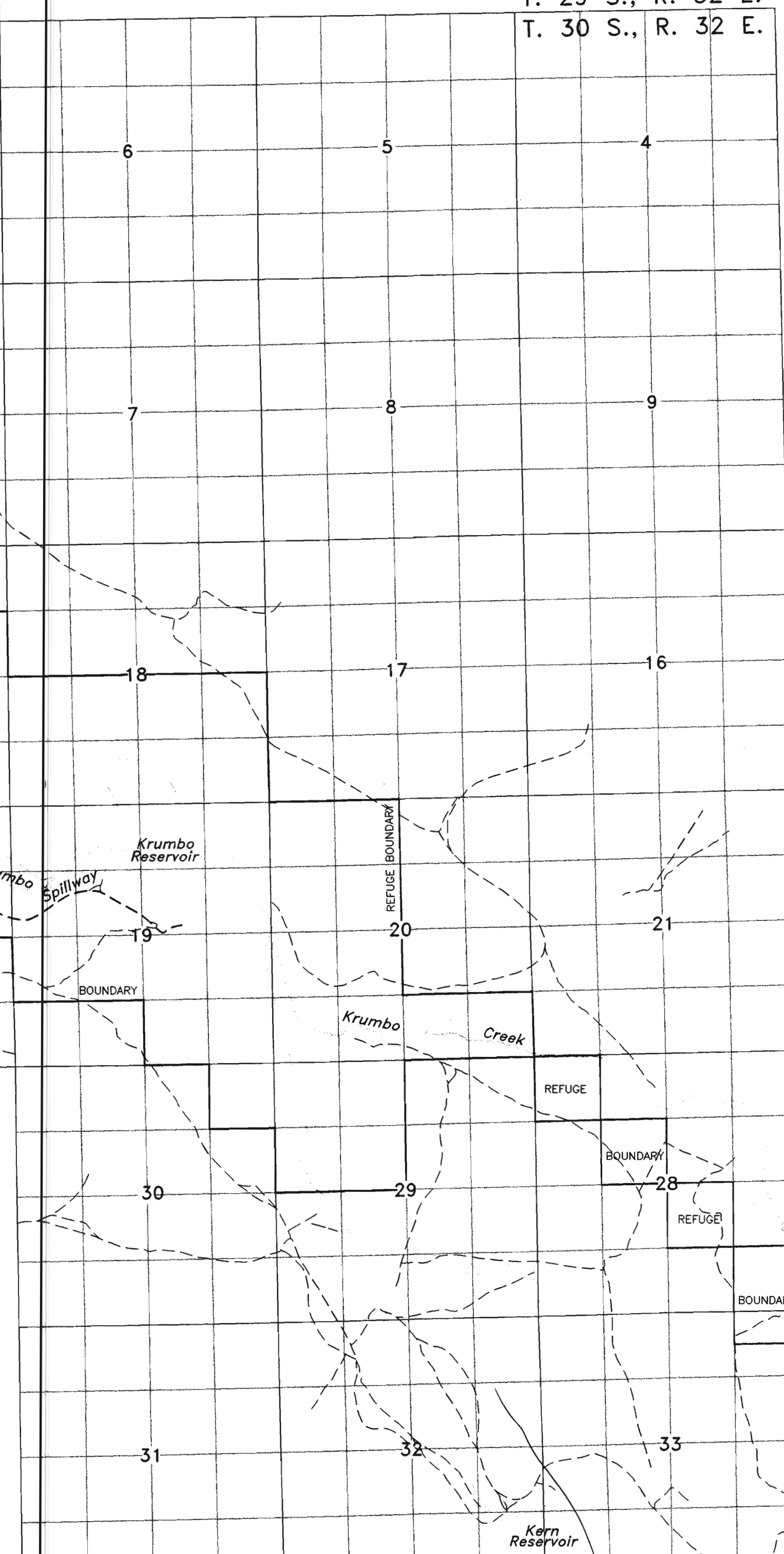

T. 30 S., R. 32 E.
T. 31 S., R. 32 1/2 E.