

3-4

SEE MAP 13 32

1" = 2000'

CANCELLED NO.	
1711	722
1900	731
706	733
715	737
729	900
732	901
702	902
735	736
213	724
726	

RECEIVED
NOV 09 1993
DEPT. OF REVENUE, STATE OF OREGON
ASSESSMENT & LAND DIVISION

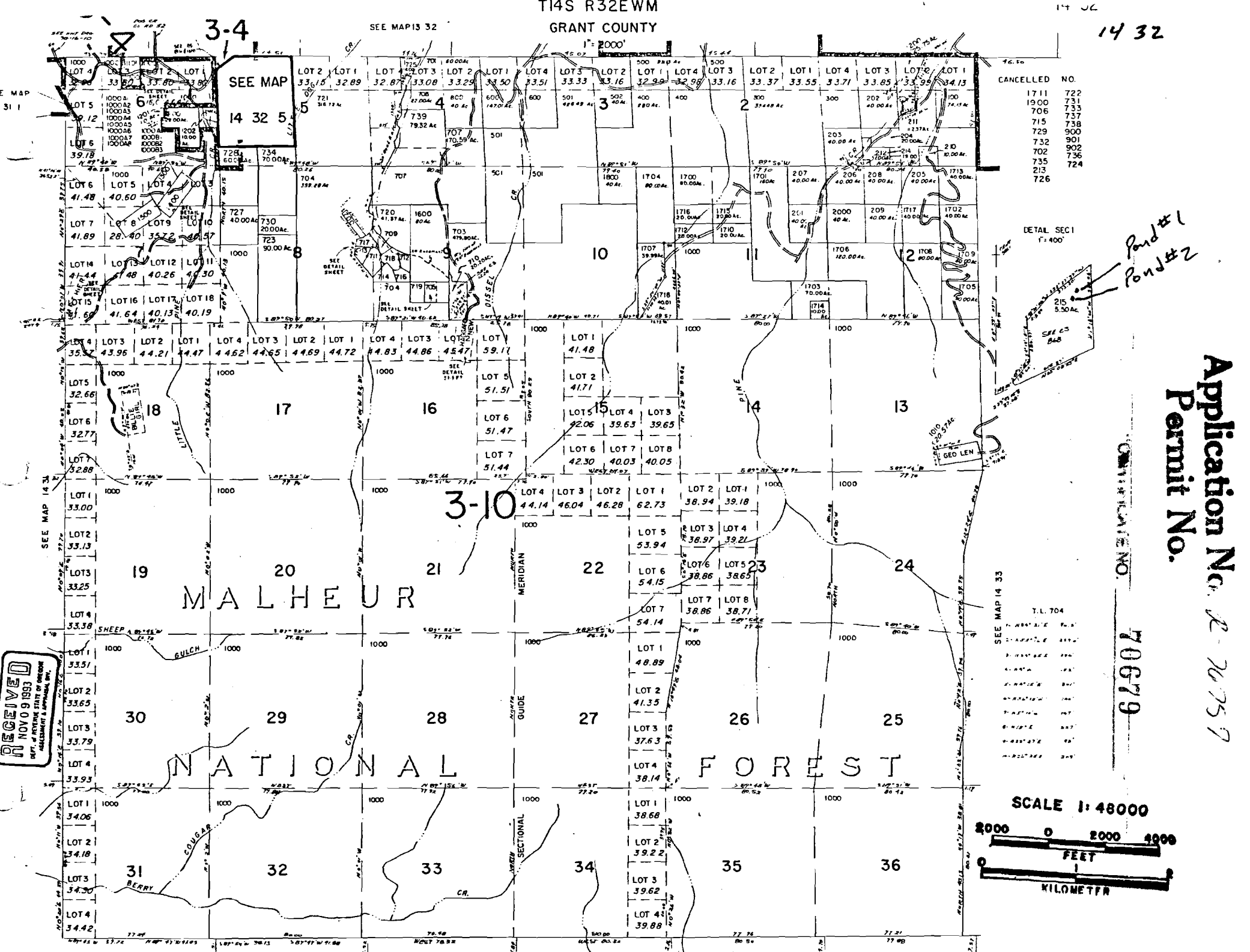

Pond #1
Pond #2

Application No. 2-20757
Permit No.

SECTIONAL NO. 70679

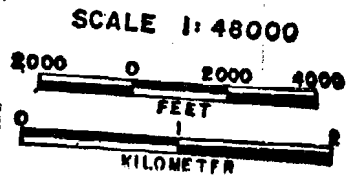

R. 32 E.

Application No.

Permit No.

Prairie City
(BM 3538)

BM 3462

Pond #1
Pond #2

Hot Springs
Mine

T. 14 S.



No Final Proof Map available

No Permit Map available