

T. 32 S., R. 5 W. W.M.

Spring
20 Tank
R-25950
Dam.

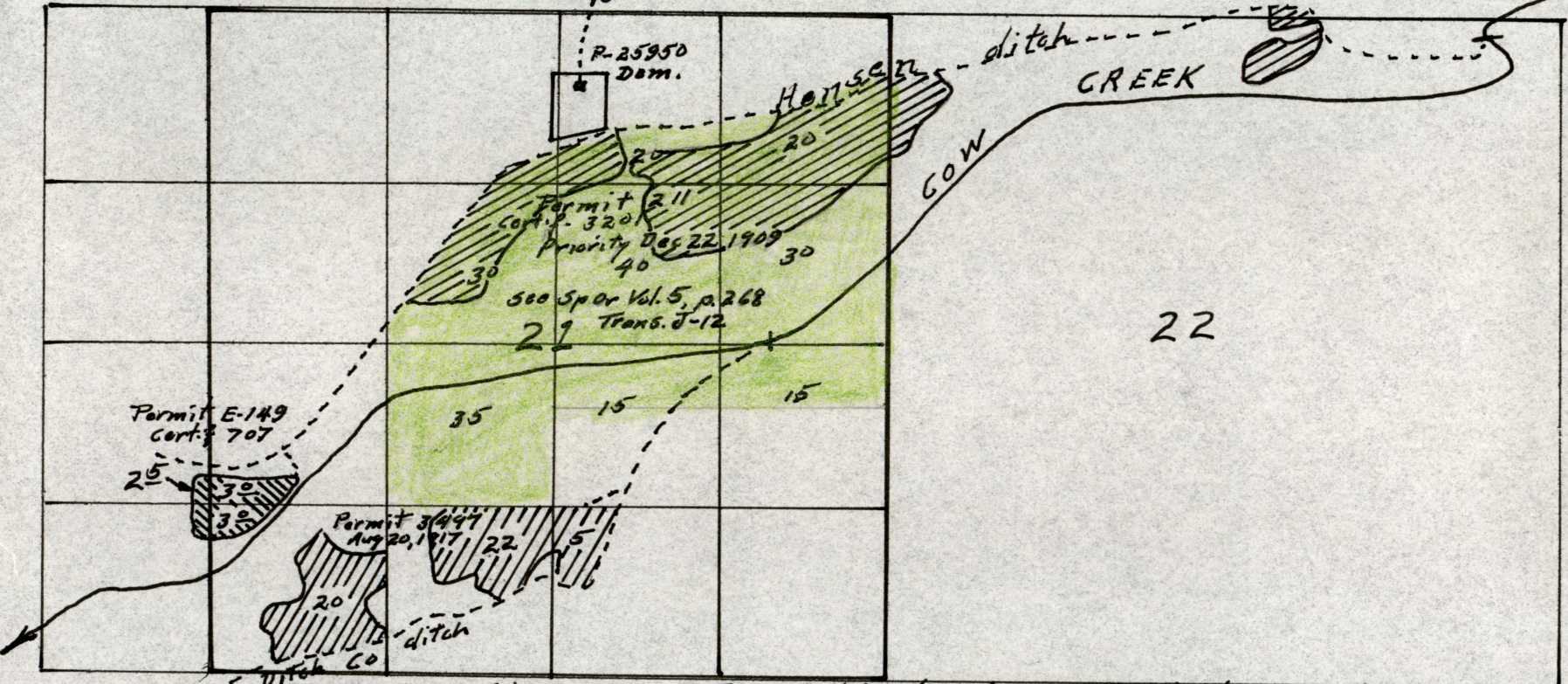

20

22

Permit E-149
Cert. 707
25
30
30

Permit 3647
Aug 20, 1917
22
15
16
ditch
Ditch Co

see Sp. or Vol. 12, p 56 of
Trans. B-136 for lands
in Sec. 20 & 29

Irrigated land and map sketched from adjudication Map
Acreages from certificates

Side
Ditch
S.