

Application No. R-70807  
 Permit No.

CERTIFICATE NO. 70726

DEC 27 1990  
 SALEM, OREGON

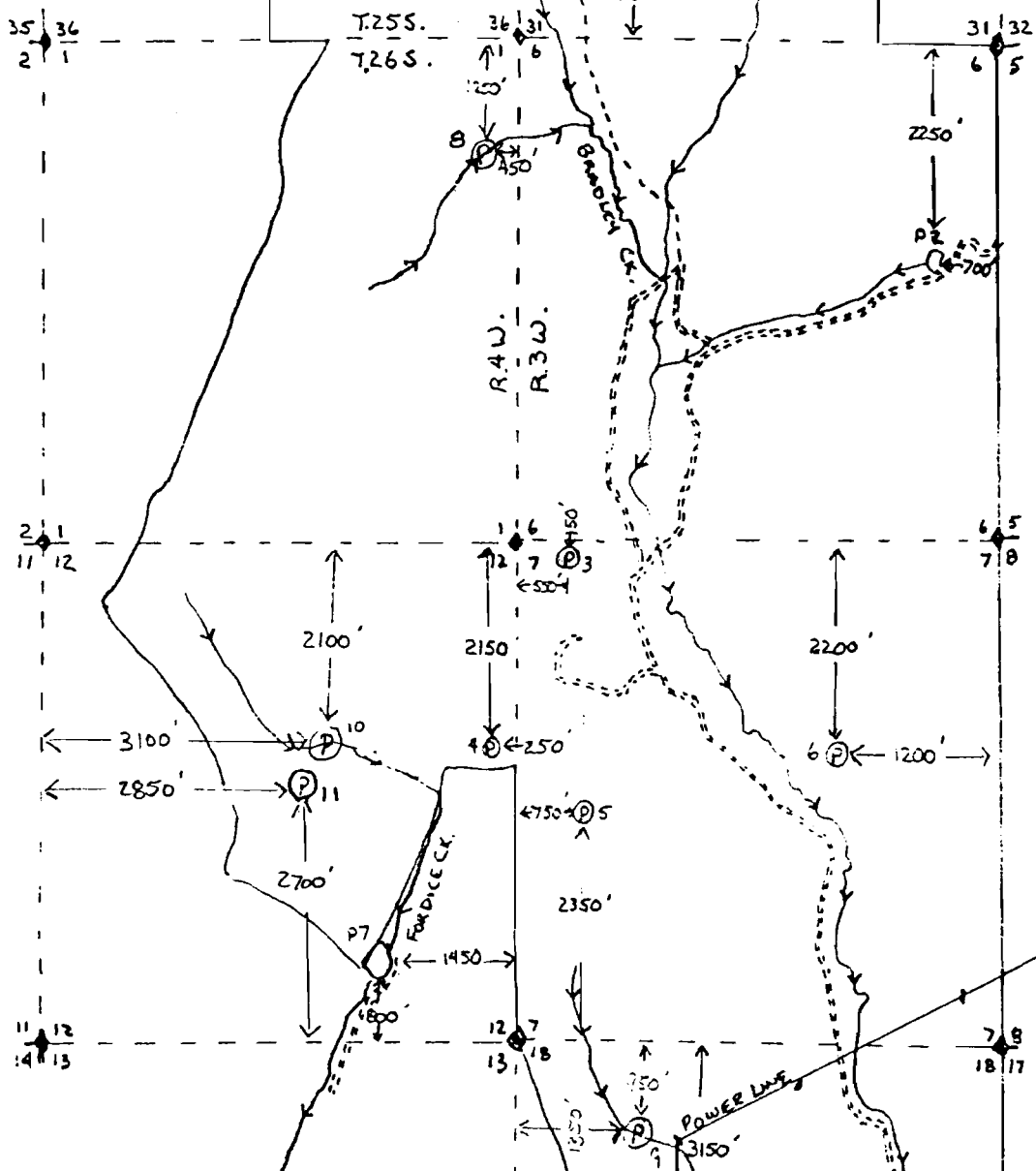

LEGEND

- Ⓟ1 SW 1/4 SW 1/4 SECTION 31 T.25S. R.3W.
- P2 SE 1/4 NE 1/4 SECTION 6 T.26S. R.3W.
- Ⓟ3 NW 1/4 NW 1/4 SECTION 6 T.26S. R.3W.
- Ⓟ4 SE 1/4 NE 1/4 SECTION 12 T.26S. R.4W.
- Ⓟ5 NW 1/4 SW 1/4 SECTION 7 T.26S. R.3W.
- Ⓟ6 SE 1/4 NE 1/4 SECTION 7 T.26S. R.3W.
- P7 SW 1/4 SE 1/4 SECTION 12 T.26S. R.4W.
- LONE ROCK TIMBER PROPERTY LINES
- SECTION LINES
- P8 NE 1/4 NE 1/4 SECTION 1 T.26S. R.4W.
- P9 NE 1/4 NW 1/4 SECTION 18 T.26S. R.3W.
- P10 SW 1/4 NE 1/4 SECTION 12 T.26S. R.4W.
- P11 SW 1/4 NE 1/4 SECTION 12 T.26S. R.4W.

PONDS 8 THRU 11 ARE NEW PONDS CONSTRUCTED IN 1994

No Final Proof Map available

No Permit Map available