

LEGEND

① NE 1/4 NE 1/4 SECTION 23 T.26S. R.5W.
PRE-1993 POND

② NW 1/4 NE 1/4 SECTION 24 T.26S R.5W.
NEW POND CONSTRUCTED 1994

70731

Application No R-76812
Permit No.

RECEIVED

DEC 30 1994

WATER RESOURCES DEPT.
SALEM, OREGON

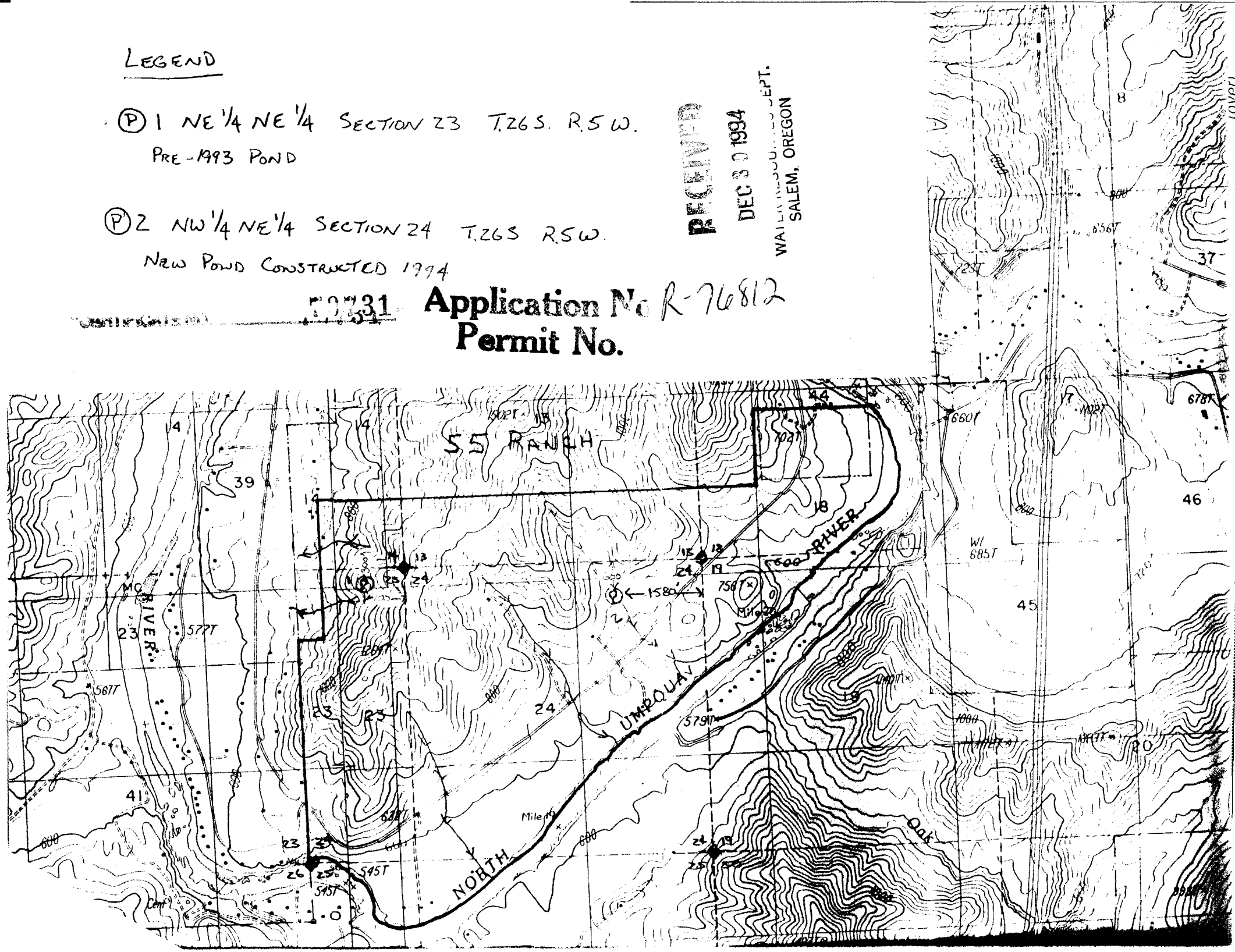

No Final Proof Map available

No Permit Map available