

RECEIVED

DEC 30 1994

WATER RESOURCES DEPT.
SALEM, OREGON

CERTIFICATE NO. 70755

SECTION 11 T.28 S. R.12 W.

Application No. *R-74836*
Permit No.

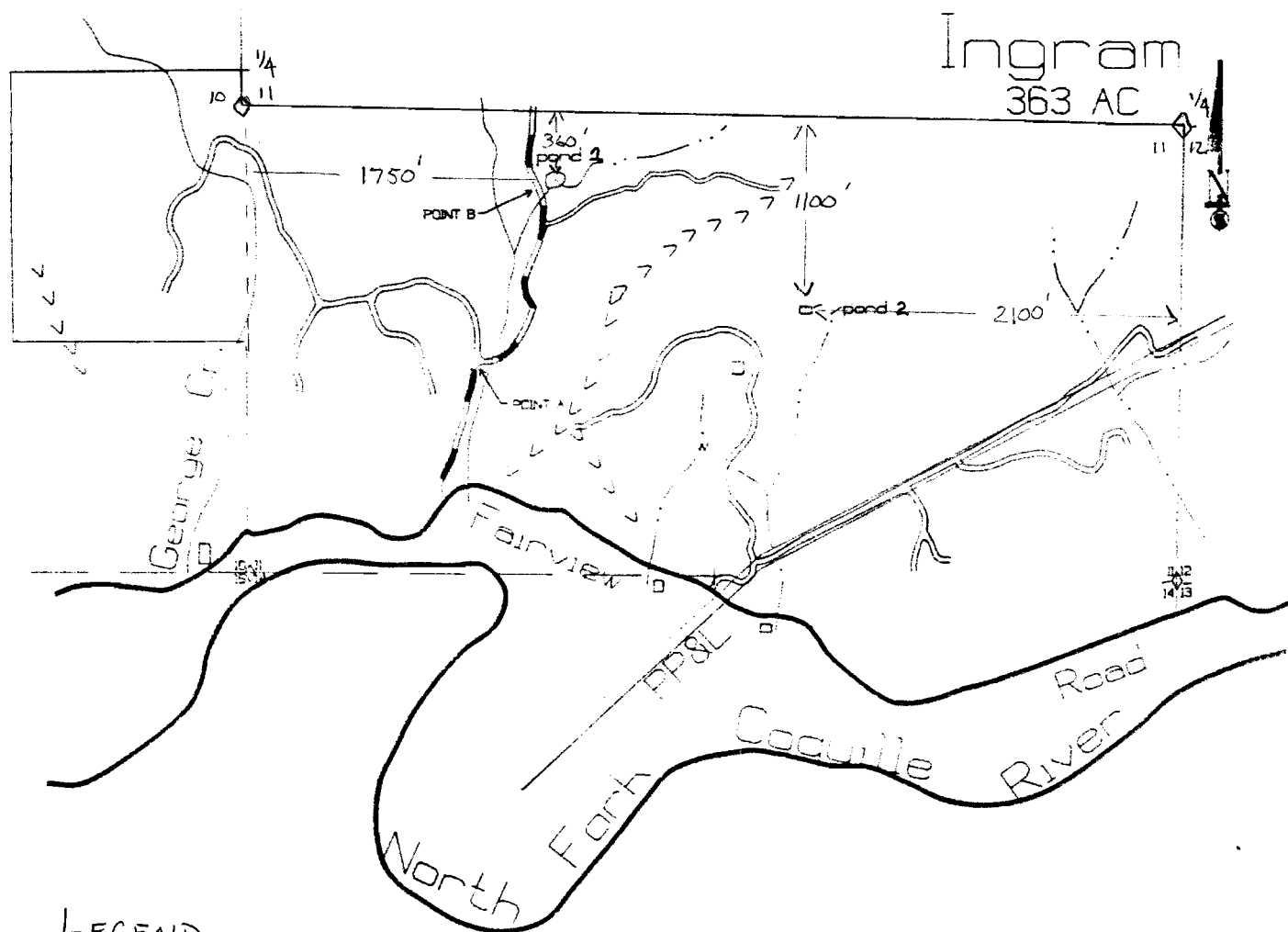

LEGEND

POND 1 NE 1/4 SW 1/4 SECTION 11 T.28 S. R.12 W.

POND 2 NW 1/4 SE 1/4 SECTION 11 T.28 S. R.12 W.

No Final Proof Map available

No Permit Map available