

LEGEND

① NE 1/4 NE 1/4 SECTION 23 T.26S. R.5W.

PRE-1993 POND

② NW 1/4 NE 1/4 SECTION 24 T.26S R.5W.

NEW POND CONSTRUCTED 1994

Application No. R-76837
Permit No.

70756

CERTIFICATE NO.

RECEIVED

DEC 30 1994

WATER RESOURCES DEPT.
SALEM, OREGON

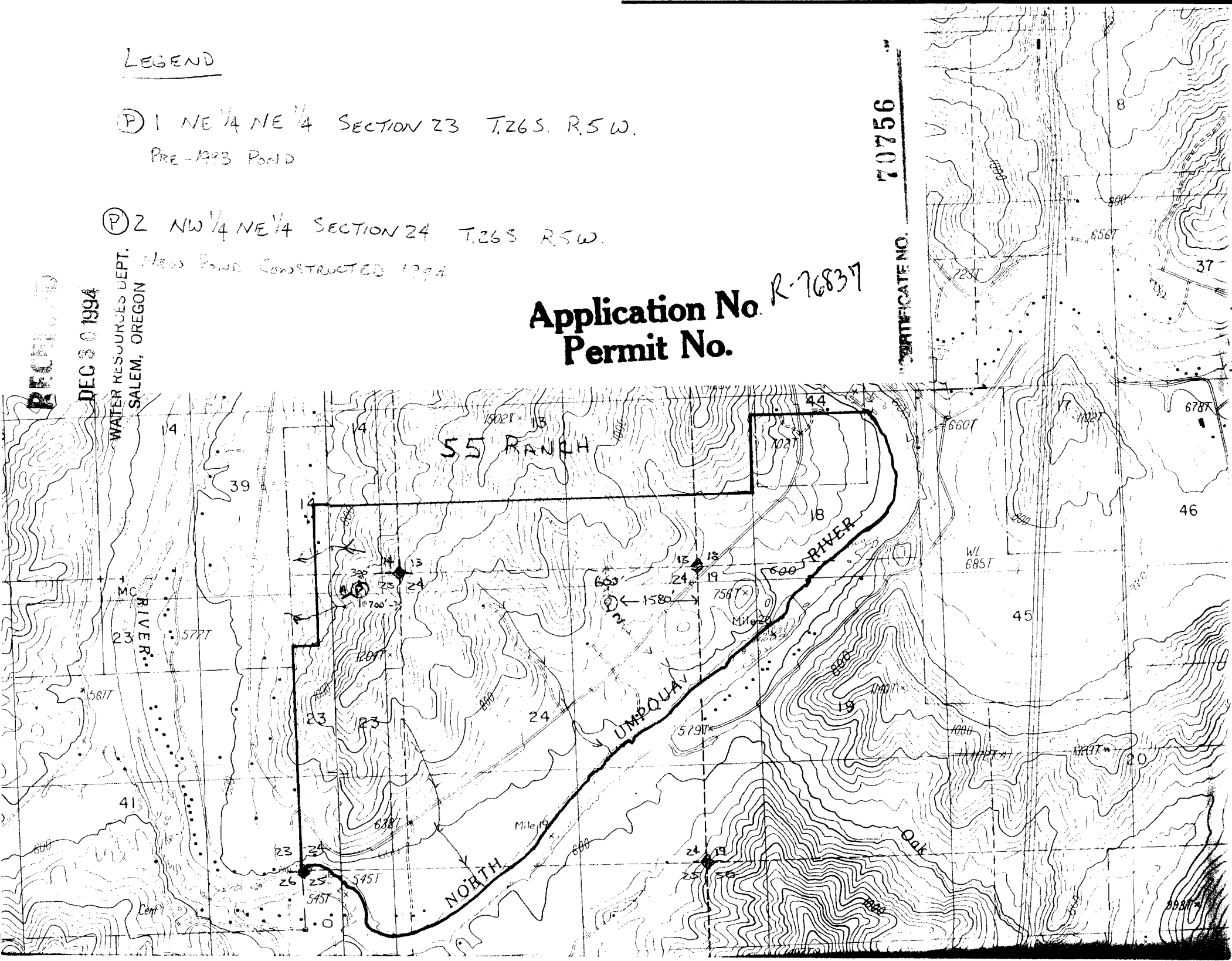

No Final Proof Map available

No Permit Map available