

Suntex 1981

2071 II NW  
(CAMP CURREY SPRING)

7.5 MINUTE SERIES (TOPOGRAPHIC)

R 25 E R 26 E

2 230 000 FEET  
119°37'30"  
43°37'30"

Application No. R-77434  
Permit No.

RECEIVED  
DEC 30 1994

WATER RESOURCES DIVISION  
SALEM, OREGON

North Fork

CERTIFICATE NO. 71025

CERTIFICATE NO. 71025

T 22 S  
710 000  
FEET  
T 23 S

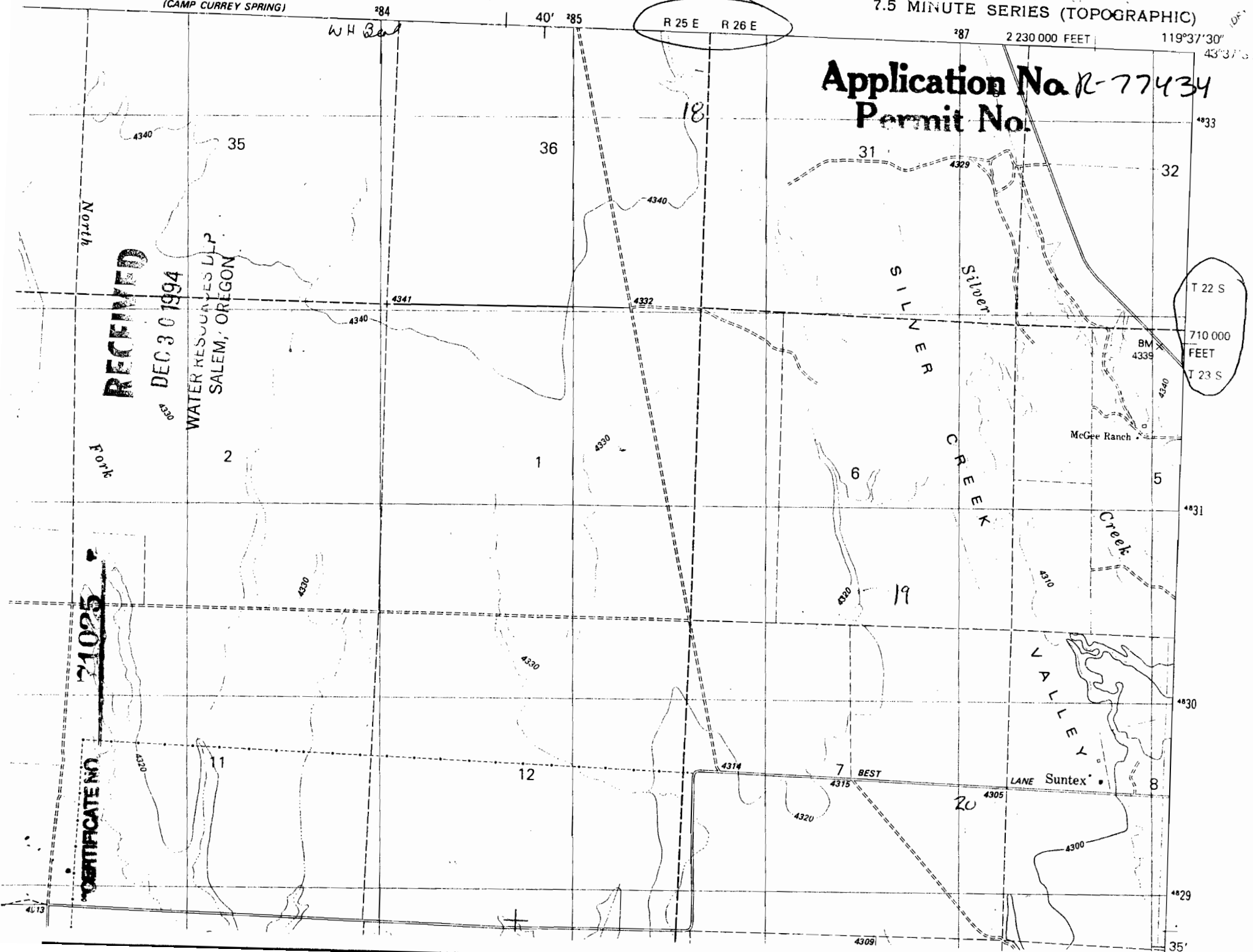

Application No R-77434

Permit No.

71025

981  
X  
S  
S  
2  
+X  
S

2021 1/16 SE (POTATO HILLS)

RECEIVED  
DEC 30 1994  
WATER RESOURCES DEP  
SALEM, OREGON

Sheep Lake

Chickahominy

Chickahominy

Chickahominy

Creek

South

Fork

T235  
W. H. Beal

T25E

28

16

15

14

20

21

12

22

14  
23

29

28

27

26

17

Borrow Pit

20

4WD

BM

BM 4349

BM

4353

4WD

20

BM 4385

Shields

4500

4500

4400

4400

4440

4400

4400

4381

4360

4351

4340

4340

4340

4340

4331

4320

4320

4340

Well 4335

4300

4320