

APPLICATION MAP FOR PERMIT TO CONSTRUCT A RESERVOIR

RECEIVED
FEB - 1 1996
WATER RESOURCES
SALEM, OREGON

NW1/4 SE1/4 SEC 16 T 27S R 43E W.M.

U.S.G.S. QUAD - JORDAN CRATERS NORTH, OREG. - 7 1/2'

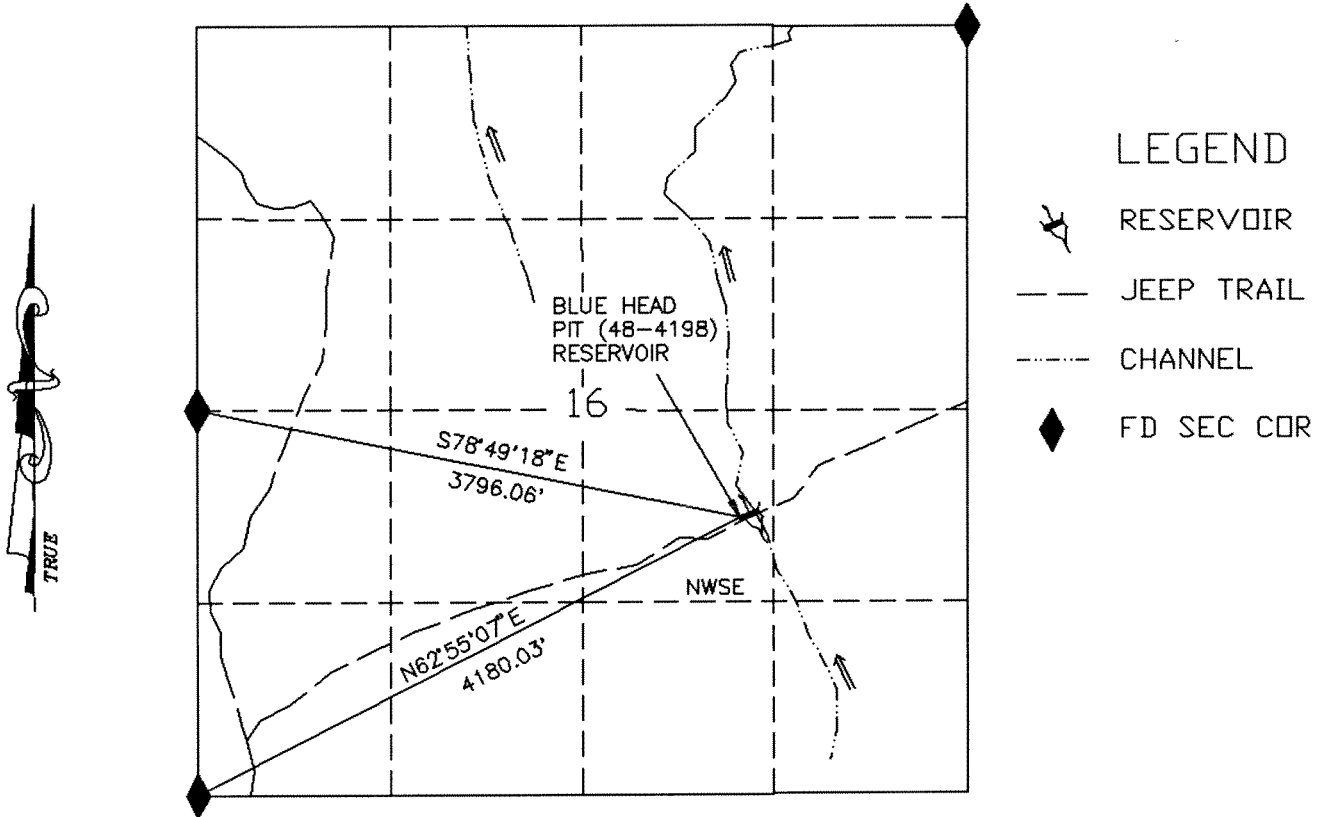

BLUE HEAD PIT (48-4198) RESERVOIR

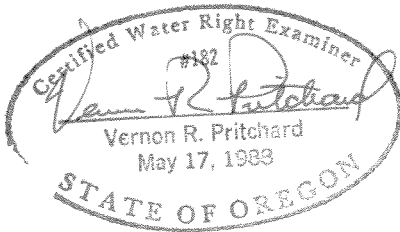

SCALE 1"=1320'

THIS MAP IS FOR THE PURPOSE OF LOCATING A WATER RIGHT AND IS NOT INTENDED TO PROVIDE LEGAL DIMENSIONS FOR LOCATION OF PROPERTY BOUNDARIES.



UNITED STATES DEPARTMENT OF THE INTERIOR BUREAU OF LAND MANAGEMENT DIVISION OF OPERATIONS VALE DISTRICT	
BLUE HEAD PIT (48-4198) RESERVOIR	
DESIGNED	<i>Vernon R. Pritchard</i>
REVIEWED	<i>Vernon R. Pritchard</i>
APPROVED	<i>[Signature]</i> <small>CHIEF, BRANCH OF ENGINEERING</small>
DRAWN: CG	SCALE: 1"=1320'
DATE: 09/15/94	SHEET 1 OF 1
DRAWING NO. DR-03-9172.45-666	

ACAD RELEASE 11/DCA
DWG FILE: BLUEHEAD

71200

REC...

FEB - 1 1996

WATER RESOURCES
SALEM, OREGON

APPLICATION MAP FOR PERMIT TO CONSTRUCT A RESERVOIR

NE1/4 NW1/4 SEC 24 T 29S R 42E W.M.

U.S.G.S. QUAD - BOGUS BENCH, OREG. - 7 1/2'

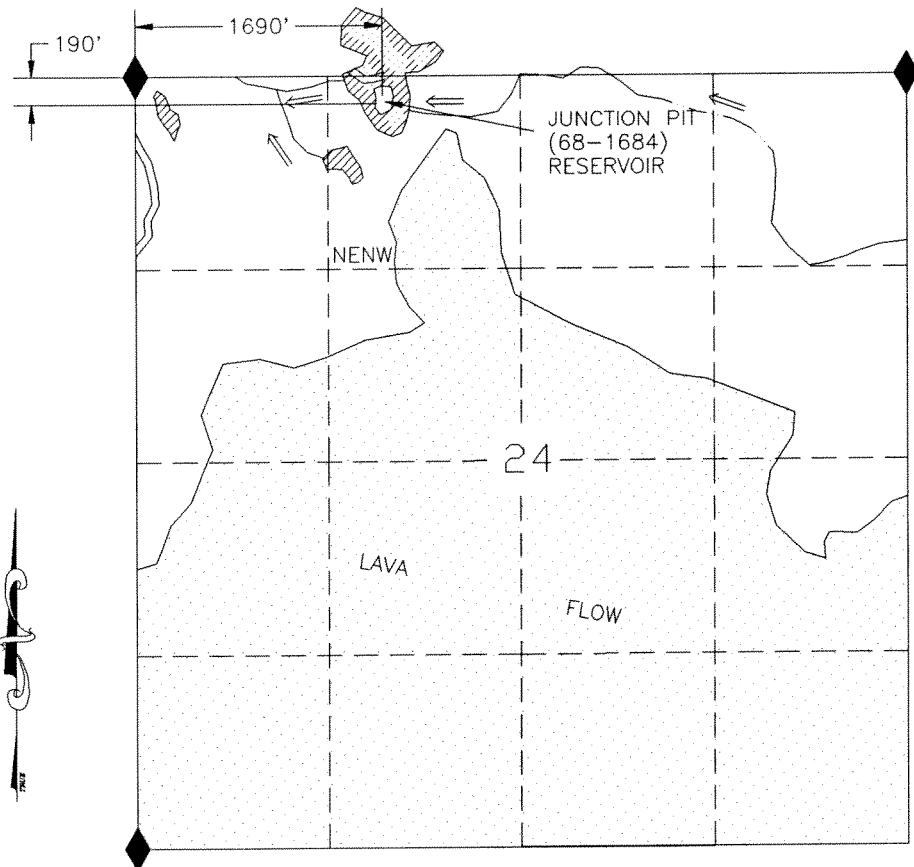

LEGEND

- RESERVOIR
- ROAD
- CHANNEL
- FD SEC COR
- DRY LAKE BED
- LAVA AREA

JUNCTION PIT (68-1684) RESERVOIR

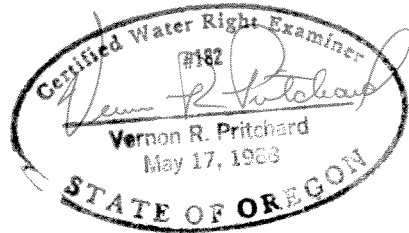

SCALE 1"=1320'

THIS MAP IS FOR THE PURPOSE OF LOCATING A WATER RIGHT AND IS NOT INTENDED TO PROVIDE LEGAL DIMENSIONS FOR LOCATION OF PROPERTY BOUNDARIES.



UNITED STATES DEPARTMENT OF THE INTERIOR BUREAU OF LAND MANAGEMENT DIVISION OF OPERATIONS VALE DISTRICT	
JUNCTION PIT (68-1684) RESERVOIR	
DESIGNED	
REVIEWED	<i>Vernon R. Pritchard</i>
APPROVED	<i>[Signature]</i>
<small>CHIEF, BRANCH OF ENGINEERING</small>	
DRAWN: CG	SCALE: 1"=1320'
DATE: 12/19/94	SHEET 1 OF 1
DRAWING NO. OR-03-9172.45-718	

ACAD RELEASE 11/DCA
DWG FILE: JUNCTION

71200