

APPLICATION MAP FOR PERMIT TO CONSTRUCT A RESERVOIR

RECEIVED

OCT - 4 1994
WATER RESOURCES DEPT.
SALEM, OREGON

NE1/4 SW1/4 SECTION 21, T. 4 S., R. 7 W. W.M., OREGON

U.S.G.S. QUAD - SPRINGER MTN. - OREGON - 7 1/2'

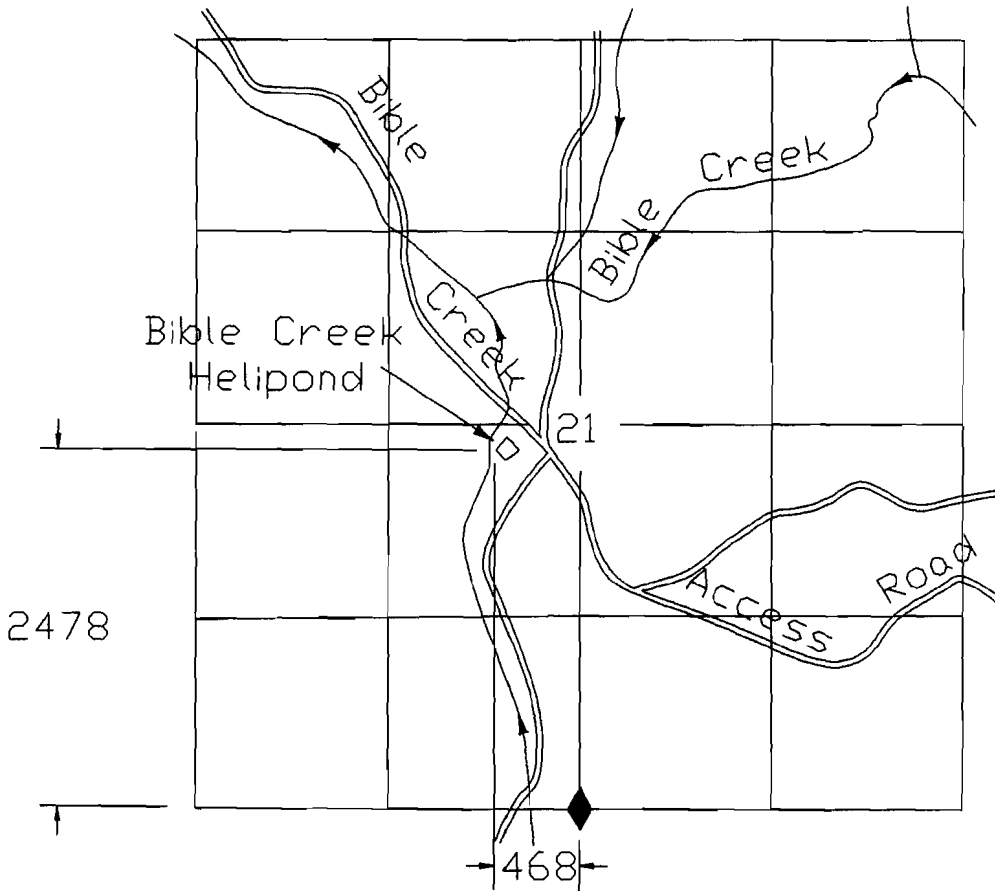

- LEGEND**
- ◇ RESERVOIR
 - == ROAD
 - CREEK
 - ◆ FD SEC COR

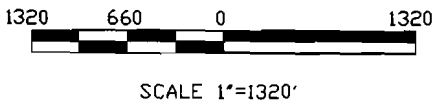

THIS MAP IS FOR THE PURPOSE OF LOCATING A WATER RIGHT AND IS NOT INTENDED TO PROVIDE LEGAL DIMENSIONS FOR LOCATION OF PROPERTY BOUNDARIES.

UNITED STATES DEPARTMENT OF THE INTERIOR
BUREAU OF LAND MANAGEMENT
DIVISION OF OPERATIONS SALEM DISTRICT

**BIBLE CREEK
HELIPOND**

DESIGNED _____
REVIEWED _____
APPROVED _____

DRAWN: RLA SCALE: 1" = 1320'

DATE: 9-26-94 SHEET 1 OF 1

DRAWING NO. OR-080-6332-105

ACAD RELEASE 11
DWG FILE: BIBLECK1.DWG

Application: B-78683

"CERTIFICATE NO. 71345"