

APPLICATION MAP FOR PERMIT TO CONSTRUCT A RESERVOIR

RECEIVED

OCT - 4 1994

WATER RESOURCES DEPT.
SALEM, OREGON

NE1/4 NE1/4 SECTION 15, T. 9 S, R. 3 E. W.M., OREGON

U.S.G.S. QUAD - MILL CITY NORTH - OREGON - 7 1/2'

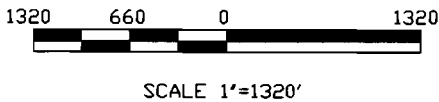
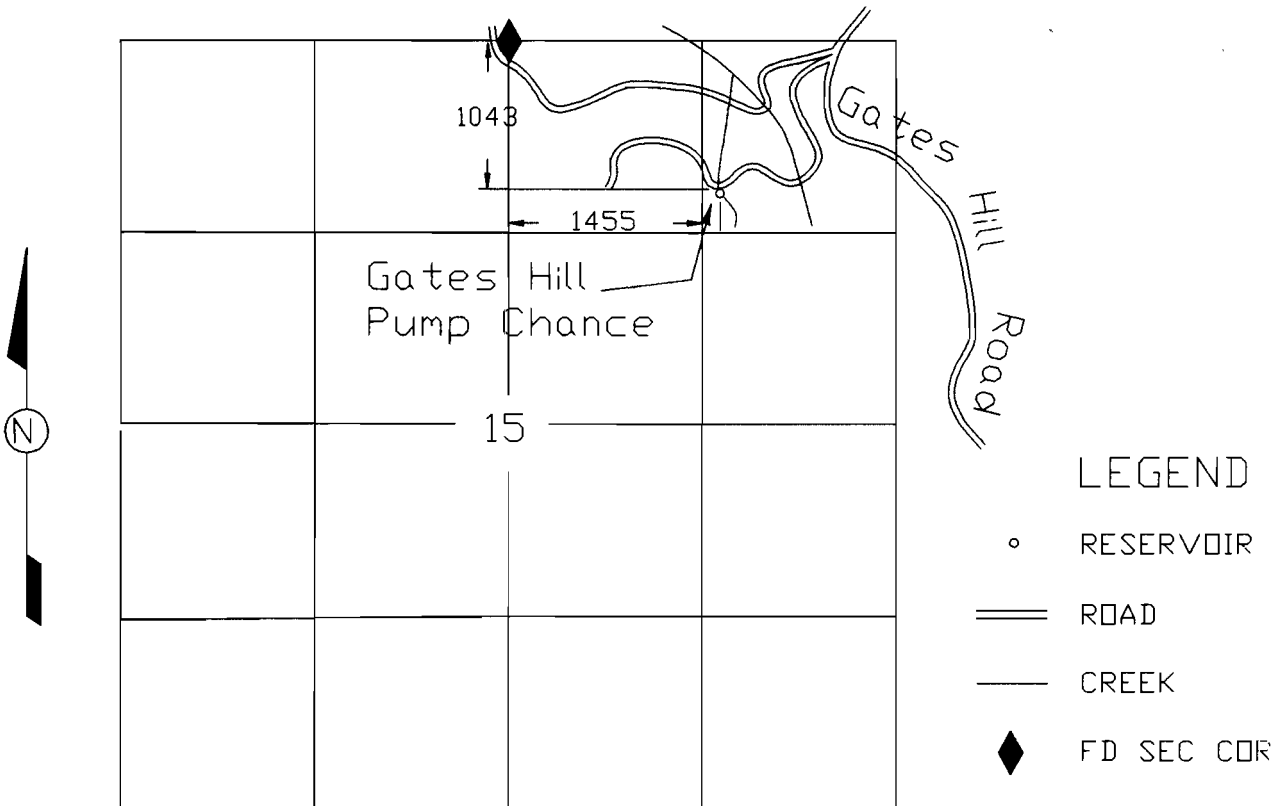

UNITED STATES DEPARTMENT OF THE INTERIOR BUREAU OF LAND MANAGEMENT DIVISION OF OPERATIONS SALEM DISTRICT	
GATES HILL PUMP CHANCE	
DESIGNED _____	
REVIEWED _____	
APPROVED _____	
DRAWN: RLA	SCALE: 1" = 1320'
DATE: 9-22-94	SHEET 1 OF 1
DRAWING NO. OR-080-6332-104	

THIS MAP IS FOR THE PURPOSE OF LOCATING A WATER RIGHT AND IS NOT INTENDED TO PROVIDE LEGAL DIMENSIONS FOR LOCATION OF PROPERTY BOUNDARIES.

ACAD RELEASE 11
DWG FILE: GATES.DWG

Application R-786084

"CERTIFICATE NO. 71346"