

SCALE 1:9600.

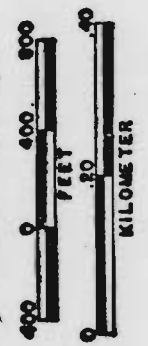

Application No. R.79866  
Permit No.

RECEIVED

DEC 29 1994

WATER RESOURCES DEPT.  
SALEM, OREGON

RECEIVED  
NOV 30 1992  
DEPT. OF REVENUE STATE OF OREGON  
ASSESSMENT & APPRAISAL DIV.

CERTIFICATE NO. 71637

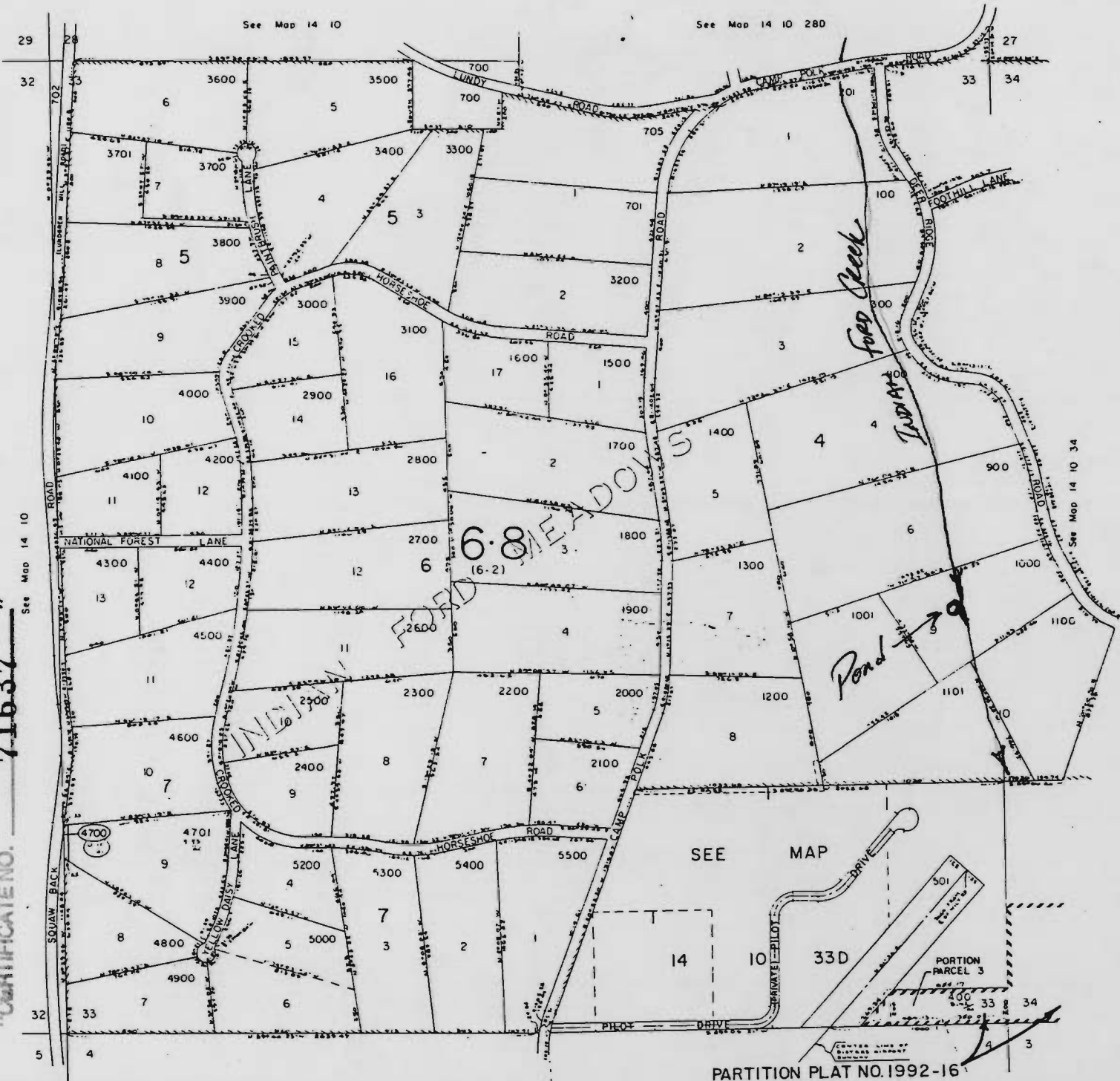

PARTITION PLAT NO. 1992-16