

Application No. R-80012
Permit No.

RECEIVED

DEC 30 1994

WATER RESOURCES DEPT.
SALEM, OREGON

Olen E. And Jean M. Opheim
14401 Nw Willis Rd.
McMinnville, Oregon 97128
503-472-7125

71701

Map depicting location of the pond and the spring that feeds it.

This map was prepared by us but it is based on the survey made by the Oregon Dept. of Water Resources prior to issuing the Certificate of Water Right for the spring that feeds the pond. A copy of the certificate is enclosed for your review.

The only information we added is that the pond is located 125 feet West of the spring described in the Certificate as Tract 1, Domestic, 0.3Acre SE1/4 NW1/4 SE1/4 Section 35, T. 3S., R. 5W., W.M.

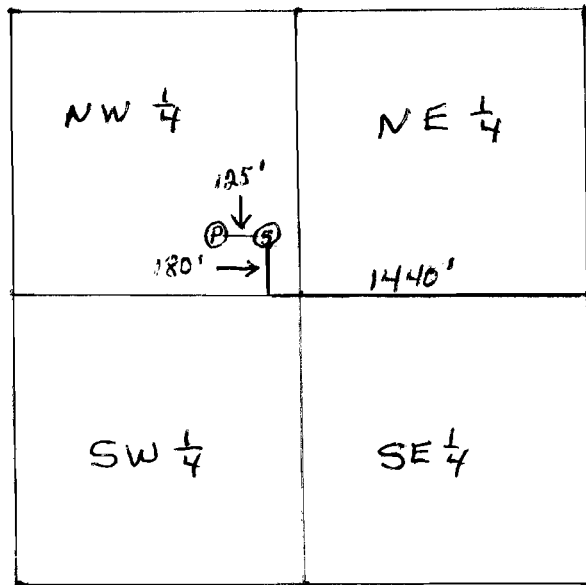

⊙ = POND
⊕ = SPRING IN TRACT 1.

Olen E. Opheim
Olen E. Opheim
Jean M. Opheim
Jean M. Opheim

SE 1/4 OF SEC 35 36
35 SW