

RECEIVED

DEC 30 1994

WATER RESOURCES DEPT.
SALEM, OREGON
4098 8-3-83

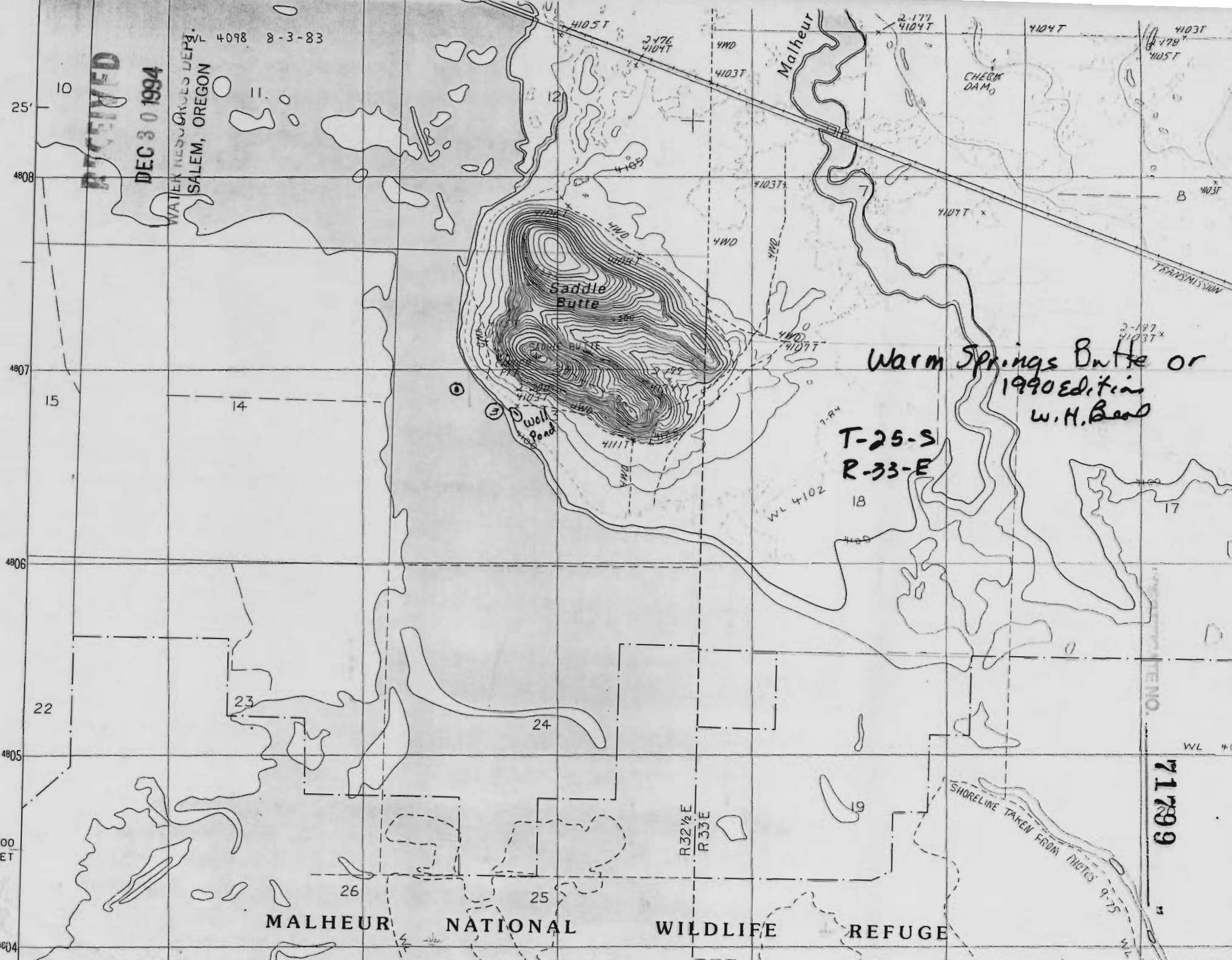

Warm Springs Butte or
1990 Edition
w.H. Beard

T-25-S
R-33-E

71299

MALHEUR NATIONAL WILDLIFE REFUGE

63000
FEET

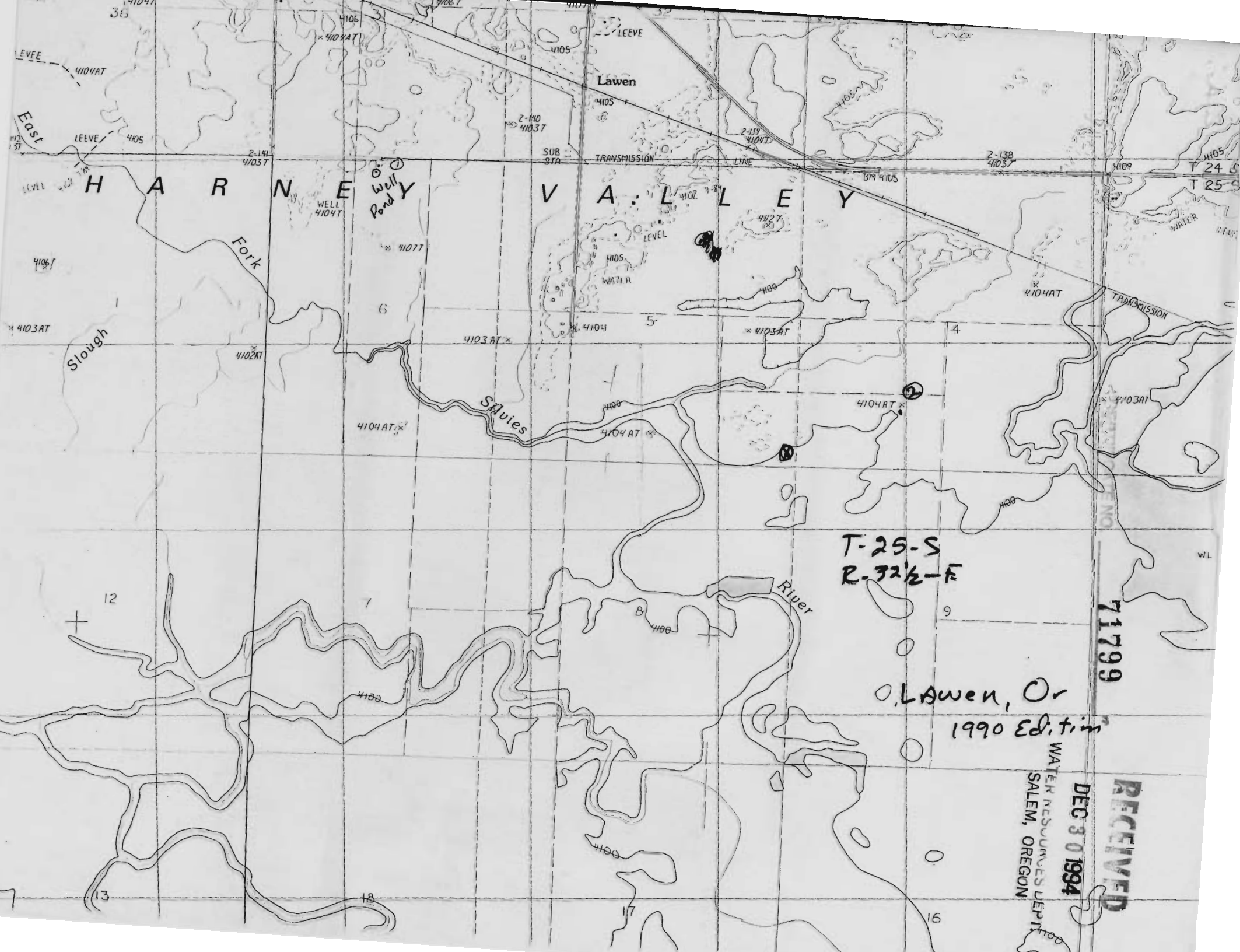

East

H A R N E Y V A L L E Y

Lawen

Fork

Slough

Sluies

River

Well Pond

WELL 4104T

SUB 37A

TRANSMISSION LINE

T-25-S
R-32 1/2-F

Lawen, Or
1990 Edition

WATER RESOURCES DEPT.
SALEM, OREGON

DEC 30 1994

RECEIVED

71799

