

SCALE, 1" = 40'

34 2W 29

RECEIVED

JAN - 3 1995  
WATER RESOURCES DEPT.  
SALEM, OREGON

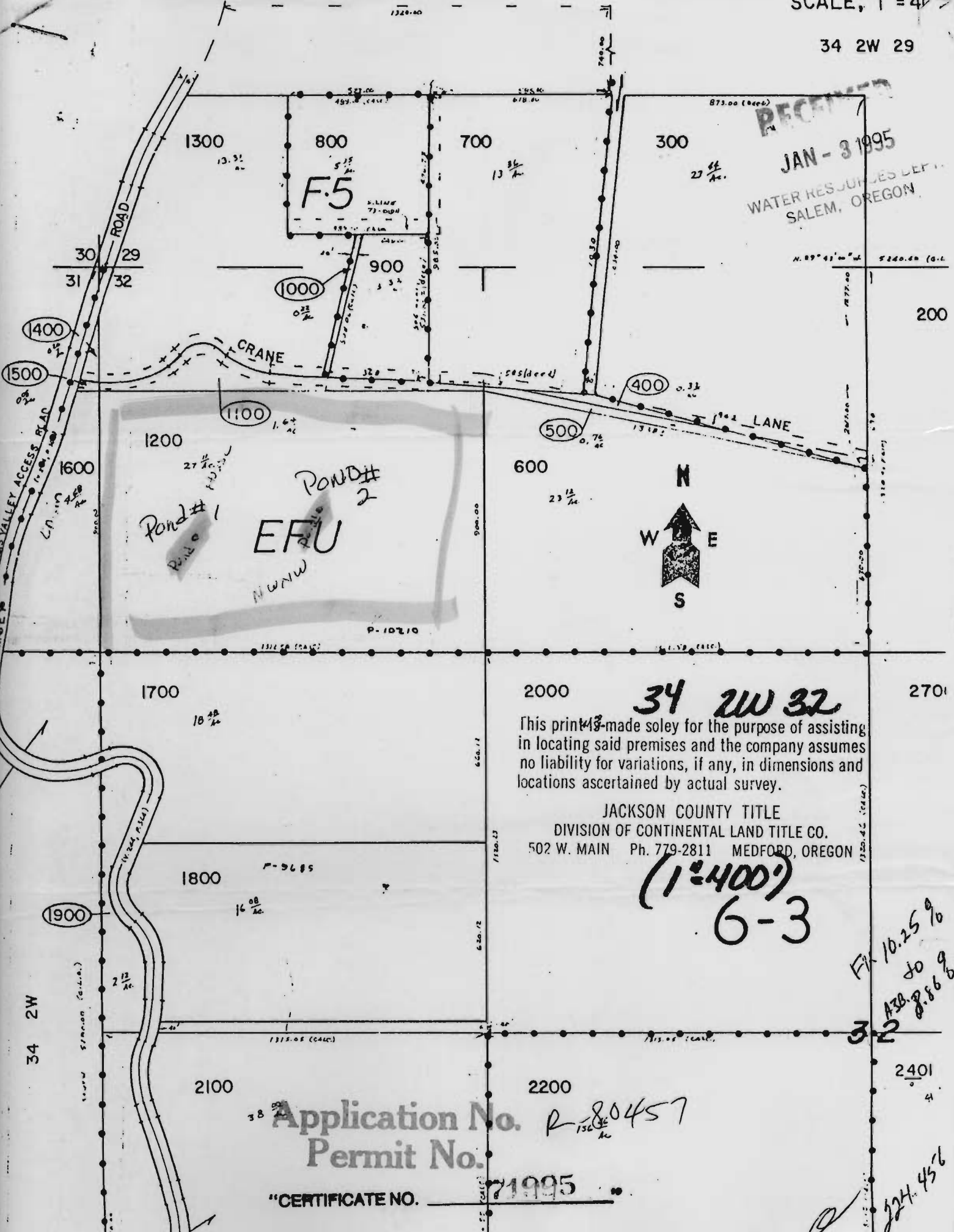

**34 2W 32**

This print made solely for the purpose of assisting in locating said premises and the company assumes no liability for variations, if any, in dimensions and locations ascertained by actual survey.

JACKSON COUNTY TITLE  
DIVISION OF CONTINENTAL LAND TITLE CO.  
502 W. MAIN Ph. 779-2811 MEDFORD, OREGON

**(1:400)  
6-3**

Fix 10.25%  
to  
AZB 8.86%

Application No. **R-80457**  
Permit No.

"CERTIFICATE NO. **71995**"

**224-456**