

This map was prepared for Edith M. Clarke by <sup>#B 2153</sup> Gordon R. Lyford, CWRE, in support of a Reservoir Application filed pursuant to HB 2153.

Josephine County

T40S, R9W, Section 25, W.M.

NW  $\frac{1}{4}$

DEC 29 1994 N  
WATER RESOURCES DIV  
SALEM, OREGON

Scale  
1" = 400'  
1:4800

 Irrigated Pasture From Pond 1.

 Irrigated Pasture From Unnamed Slough Under Certificate # 4858 and Pond 2.

NW Corner Sec 25

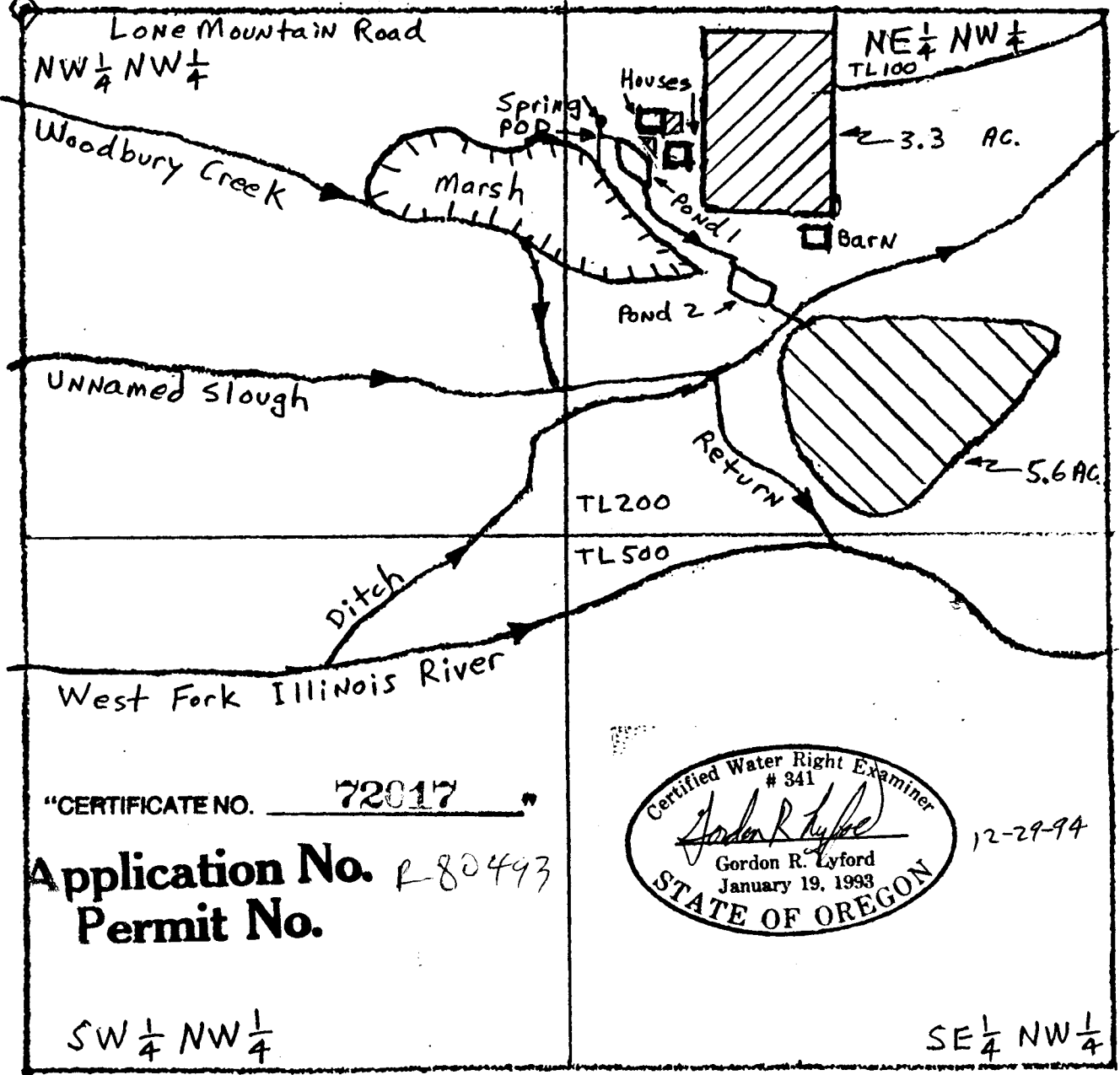

"CERTIFICATE NO. 72017"

Application No. R80493  
Permit No.

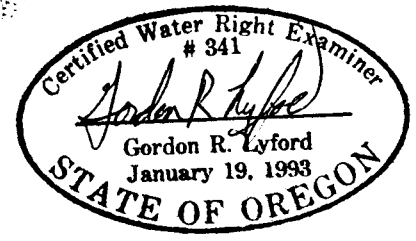

12-29-94

SW  $\frac{1}{4}$  NW  $\frac{1}{4}$

SE  $\frac{1}{4}$  NW  $\frac{1}{4}$

This map is for the purpose of identifying the location of the water right only and is not intended to provide legal dimensions or location of property ownership lines.