

RECEIVED

JAN 15 1992

WATER RESOURCES DEPT
SALEM, OREGON



1" = 400'

SE 1/4 NW 1/4

SW 1/4 NE 1/4

S.E. 312th AVE.

PARCEL "A"

TL 2500 AW
2500 WI

(9.3 AC.)

WELL 134'

TL 501 AW
501 WI

(1.0 AC.)

PARCEL "B"

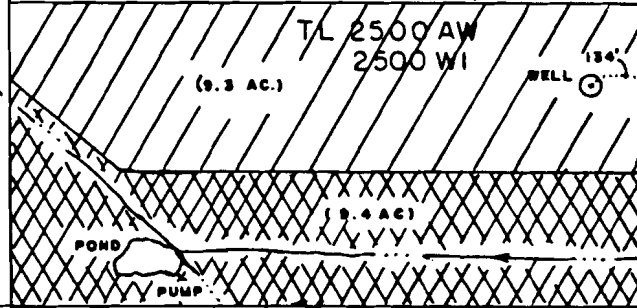

CHURCH ROAD

NE 1/4 SW 1/4

PARCEL "C"

(2.0 AC.)

TL 100

LEGEND

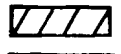

FIELD STOCK



CONTAINER STOCK

This drawing is an exhibit for a Final Proof Survey. It is not a Land Survey. Property lines and/or other lines of occupation shown hereon are not represented by the undersigned to meet accuracy standards of Land Surveys.

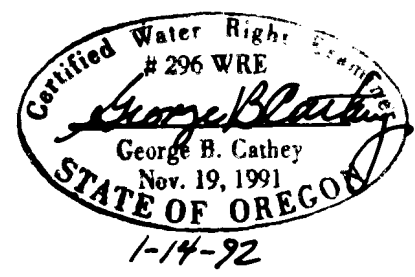

Western International
Nursery Growers, Inc.
13237 S.E. 312th Avenue
Boring, Oregon 97009

SEC. 5, T. 2 S., R. 4 E. W.M.

Application No. G-11967

Permit No. G-11156

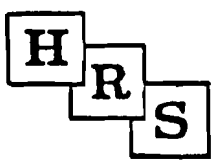

HANER, ROSS &
SPORSEEN, INC.
15 S.E. 82ND DR.
GLADSTONE, OREGON 97027

FINAL PROOF SURVEY
GROUNDWATER RIGHT