

# T. 1N. R. 4W. W.M.

N.E. 1/4 N.W. 1/4 SEC. 6

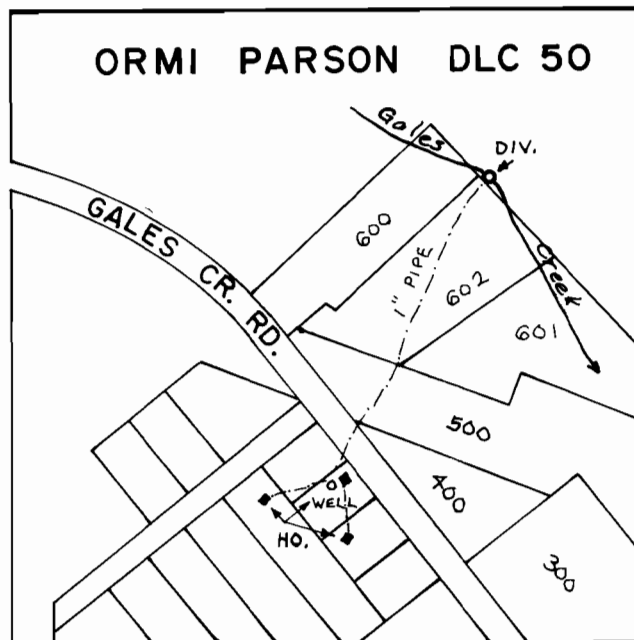

SCALE: 1" = 400'

DIV. LOC. - 350' S. & 330' W. FROM N. 1/4 COR. SEC. 6

## FINAL PROOF SURVEY UNDER

Application No. 52243 Permit No. 37848  
IN NAME OF

MARY LOUISE TAYLOR

Surveyed May 17, 1976, by R.G. Mucken