

T. 38S., R. 4W., W.M.

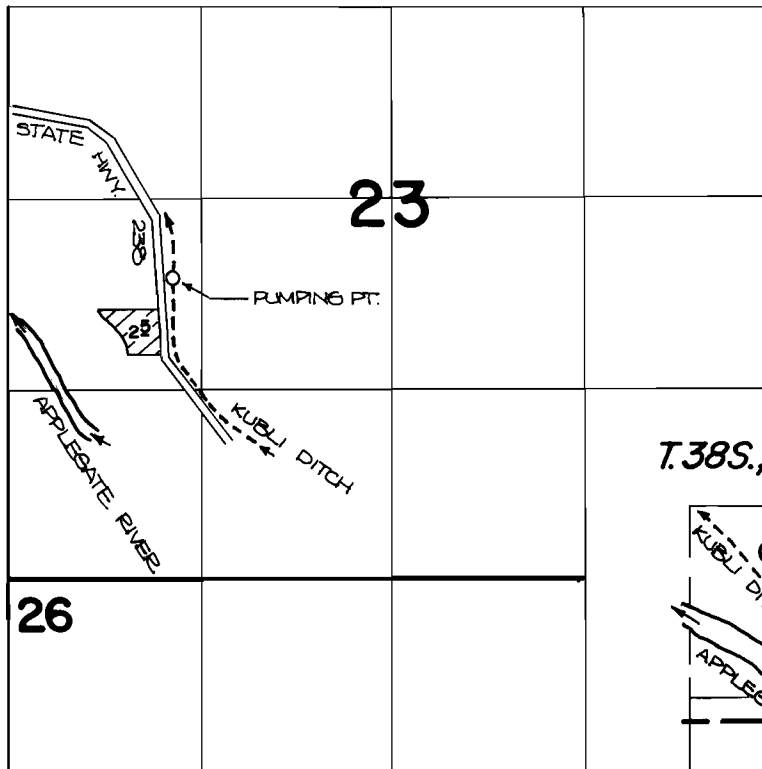

DIVERSION POINT IS LOCATED 2510'S. AND 3370'W. FROM THE N.E. CORNER, G. LONG DLC 39 IN SECTION 30, T. 38S., R. 3W., W.M.

T. 38S., R. 3W., W.M.

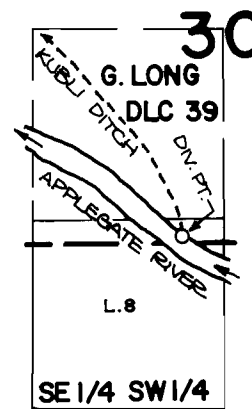

FINAL PROOF SURVEY UNDER

Application No. **63184** Permit No. **46689**
IN NAME OF

MELVIN LUXTON ARNOLD

Surveyed **JULY 20, 1983**, by **B. JAMES**