

# T3S, R26E, W. M., MORROW CO., OR. G-11244 72322

## FINAL PROOF SURVEY

UNDER  
Application No. G-11937  
Permit No. G-11244

IN THE NAME OF  
**ALBERT L. OSMIN**  
RT. 1, Box 3366  
Heppner, OR. 97836

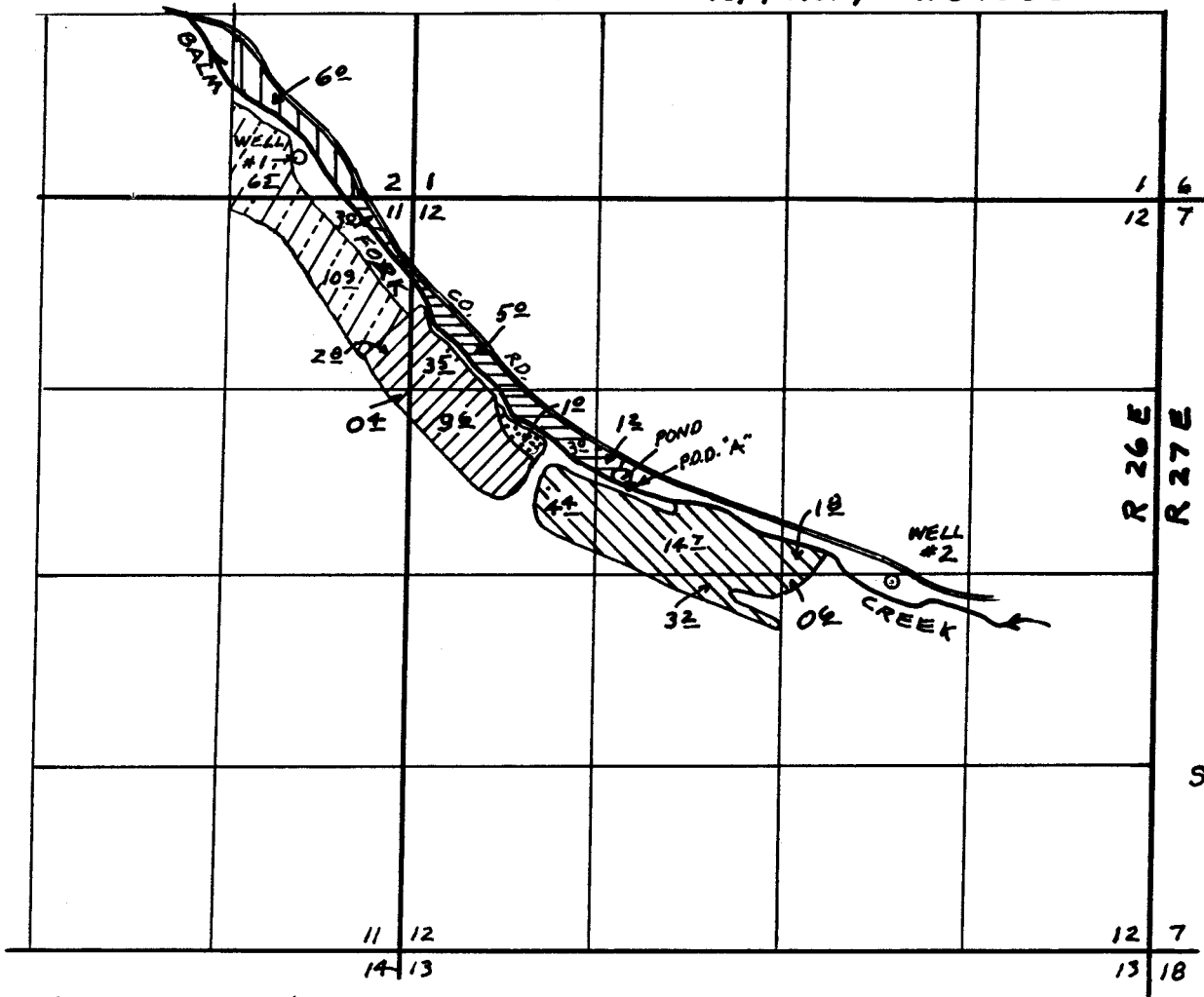

  
 Scale: 1320'

Well #1: 270' N & 820' W of the SE Cor. Sec. 12.  
 Well #2: 2740' S & 3410' E of the NW Cor. Sec. 12.  
 P.O.D. "A": 2030' S & 1550' E of the NW Cor. Sec. 12.



Permit #G-8400.



Permit #G-11244 and  
Supp. #37755.

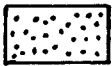

Permit #G-11244.



Permits #251 & 31074 and  
Supp. #G-11244.

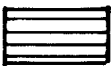

Permit #251 and  
Supp. #G-11244.



Permit #247 and  
Supp. #G-11244.

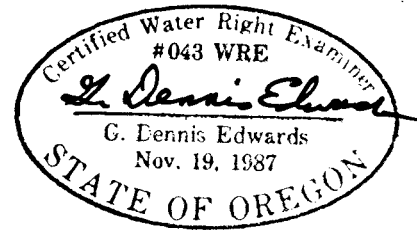

*This map is for identifying the location of water rights only and is not intended to show property lines or dimensions.*

Edwards Surveying P.O. Box 763  
 567-3336 Hermiston, OR. 97838  
 5/22/92 Job #W8905004